



Richmond Way, Newport Pagnell, MK16 0LG

welcome to

Richmond Way, Newport Pagnell

CHAIN FREE - Brown and Merry are delighted to present this THREE-bedroom home perfect for someone looking to put their own stamp on a property. The property features a bright lounge/diner, integral garage and three well-proportioned bedrooms.

Entrance Porch

Double-glazed door to the front, radiator and double-glazed window to the side. Door to the lounge/diner.

Lounge/Diner

Double-glazed window to the front, stairs to the first floor, 2 radiators, ceiling fan and double-glazed sliding doors to the conservatory.

Conservatory

Upvc construction with double-glazed windows to the side and double-glazed doors leading out to the garden.

Kitchen

Fitting with a mix of wall and base units with work top over, 1.5 bowl sink with drainer, cooker extractor fan and space for a cooker. Space for a washing machine and under counter fridge or freezer. Double-glazed window to the rear and double-glazed door leading out to the garden.

First Floor Landing

Stairs from the ground floor and doors to all bedrooms and the family bathroom.

Bedroom One

Built-in wardrobes with hanging space and storage, radiator and double-glazed window to the front.

Bedroom Two

Built-in wardrobes with hanging space and storage, cupboard housing the water tank, radiator and double-glazed window to the rear.

Bedroom Three

Radiator and double-glazed window to the front.

Bathroom

Partially tiled with a pedestal wash hand basin with mixer tap, low-level WC, bath and shower cubicle. Radiator and double-glazed obscured window to the rear.

Outside Garage

Integral garage with up & over door. Driveway providing off-road parking to the front.

Front Garden

A mix of paving and gravel frontage with mature shrub border. Path leading to the front door.

Rear Garden

Enclosed by fencing with gated side access. The garden is laid to lawn with mature shrub borders and a patio area.

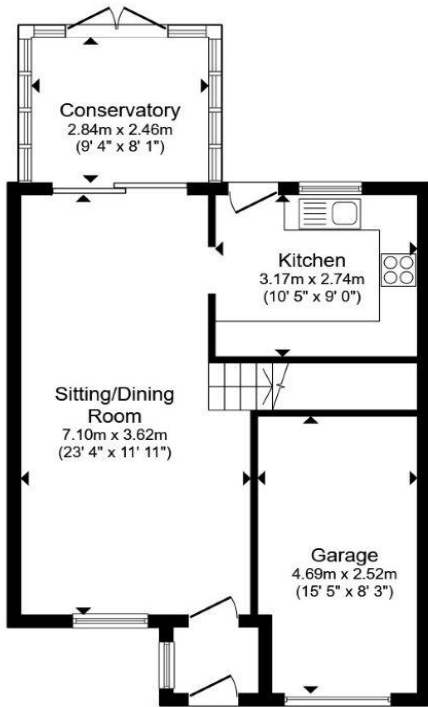

Ground Floor

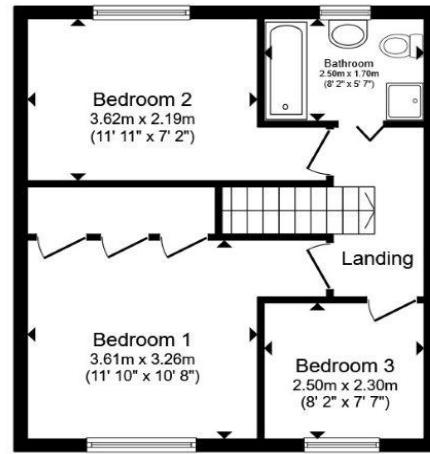

First Floor

Total floor area 101.1 m² (1,089 sq.ft.) approx

This floor plan is for illustrative purposes only. It is not drawn to scale. Any measurements, floor areas (including any total floor area), openings and orientation are approximate. No details are guaranteed, they cannot be relied upon for any purpose and they do not form part of any agreement. No liability is taken for any error, omission or misstatement. A party must rely upon its own inspection(s). Powered by www.propertybox.io



welcome to
Richmond Way,
Newport Pagnell

- THREE BEDROOM SEMI-DETACHED
- INTEGRAL GARAGE
- CONSERVATORY
- THREE WELL PROPORTIONED BEDROOMS
- DRIVEWAY

Tenure: Freehold EPC Rating: D
Council Tax Band: C

guide price

£325,000



view this property online [brownandmerry.co.uk/Property/NPL108108](https://www.brownandmerry.co.uk/Property/NPL108108)



Property Ref:
NPL108108 - 0003

1. MONEY LAUNDERING REGULATIONS Intending purchasers will be asked to produce identification documentation at a later stage and we would ask for your co-operation in order that there is no delay in agreeing the sale. 2. These particulars do not constitute part or all of an offer or contract. 3. The measurements indicated are supplied for guidance only and as such must be considered incorrect. Potential buyers are advised to recheck measurements before committing to any expense. 4. We have not tested any apparatus, equipment, fixtures or services and it is in the buyers interest to check the working condition of any appliances. 5. Where an EPC, or a Home Report (Scotland only) is held for this property, it is available for inspection at the branch by appointment. If you require a printed version of a Home Report, you will need to pay a reasonable production charge reflecting printing and other costs. 6. We are not able to offer an opinion either written or verbal on the content of these reports and this must be obtained from your legal representative. 7. Whilst we take care in preparing these reports, a buyer should ensure that his/her legal representative confirms as soon as possible all matters relating to title including the extent and boundaries of the property and other important matters before exchange of contracts.

Brown & Merry is a trading name of Sequence (UK) Limited which is registered in England and Wales under company number 4268443, Registered Office is Cumbria House, 16-20 Hockliffe Street, Leighton Buzzard, Bedfordshire, LU7 1GN. VAT Registration Number is 500 2481 05.

brown & merry



01908 611242



newportpagnell@brownandmerry.co.uk



74A High Street, Newport Pagnell, MILTON
KEYNES, Buckinghamshire, MK16 8AQ



[brownandmerry.co.uk](https://www.brownandmerry.co.uk)