



Grasmere Road, Birmingham B21 0UL

welcome to

Grasmere Road, Birmingham

*****SOUGHT AFTER LOCATION*** IDEAL INVESTMENT PURCHASE*** SPACIOUS THROUGHOUT*** CLOSE TO LOCAL SCHOOLS AND AMENITIES***
TRANSPORT LINKS*** CALL NOW TO BOOK YOUR VIEWING*****

Agent Note

This property is council tax band A.

Lounge/Bedroom 2

11' 5" x 9' (3.48m x 2.74m)

Double glazed bay window to front, central heating radiator, laminate flooring.

Dining Room/Bedroom 3

11' 2" x 9' (3.40m x 2.74m)

Double glazed window to rear, central heating radiator, laminate flooring.

Kitchen

11' 2" x 6' 11" (3.40m x 2.11m)

Double glazed window & door to rear, range of wall & base units, tiled floor and tiles to splash-prone areas, freestanding appliances, gas hob & oven with extractor fan above, wall mounted central heating boiler.

Bedroom 1

14' 9" x 11' 2" (4.50m x 3.40m)

Double glazed windows to front, central heating radiator, laminate flooring.

Bedroom 4

11' 6" x 11' 3" (3.51m x 3.43m)

Double glazed window to rear, central heating radiator.

Bedroom 5

9' x 7' (2.74m x 2.13m)

Double glazed window to rear, central heating radiator.

Bathroom

9' x 6' 11" (2.74m x 2.11m)

Double glazed frosted window, fully tiled corner shower unit, small wash hand basin, low level flush w/c.

Front Garden

Small front garden, small wall & gate surround, small step into garden, two small steps up to front door.

Rear Garden

Fencing for privacy, brick built shed, fully paved.





check out more properties at shipways.co.uk



welcome to

Grasmere Road, Birmingham

- Mid-terraced property.
- Spacious throughout.
- Close to local links.
- Walking distance to local schools.
- Ideal investment opportunity.

Tenure: Freehold EPC Rating: Awaited
Council Tax Band: A

£200,000

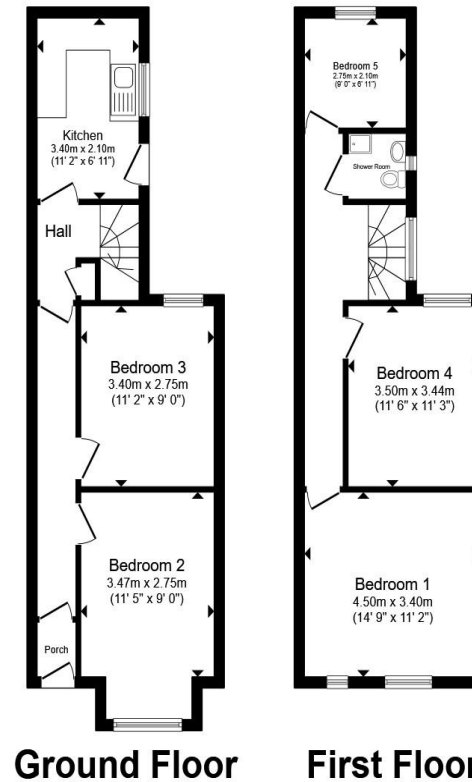

Total floor area 75.0 m² (807 sq.ft.) approx

This floor plan is for illustrative purposes only. It is not drawn to scale. Any measurements, floor areas (including any total floor area), openings and orientation are approximate. No details are guaranteed, they cannot be relied upon for any purpose and they do not form part of any agreement. No liability is taken for any error, omission or misstatement. A party must rely upon its own inspection(s). Powered by www.propertybox.io



check out more properties at shipways.co.uk



Property Ref:
HBN112075 - 0002

1. MONEY LAUNDERING REGULATIONS Intending purchasers will be asked to produce identification documentation at a later stage and we would ask for your co-operation in order that there is no delay in agreeing the sale. 2. These particulars do not constitute part or all of an offer or contract. 3. The measurements indicated are supplied for guidance only and as such must be considered incorrect. Potential buyers are advised to recheck measurements before committing to any expense. 4. We have not tested any apparatus, equipment, fixtures or services and it is in the buyers interest to check the working condition of any appliances. 5. Where an EPC, or a Home Report (Scotland only) is held for this property, it is available for inspection at the branch by appointment. If you require a printed version of a Home Report, you will need to pay a reasonable production charge reflecting printing and other costs. 6. We are not able to offer an opinion either written or verbal on the content of these reports and this must be obtained from your legal representative. 7. Whilst we take care in preparing these reports, a buyer should ensure that his/her legal representative confirms as soon as possible all matters relating to title including the extent and boundaries of the property and other important matters before exchange of contracts.

Not for marketing purposes INTERNAL USE ONLY



0121 427 3264



harborne@shipways.co.uk



172 High Street, Harborne, BIRMINGHAM,
West Midlands, B17 9PP



shipways.co.uk