



jordanfishwick

12 DRAYFORD CLOSE MANCHESTER M23 0GF
PCM £850 PCM

12 DRAYFORD CLOSE MANCHESTER M23 0GF

*** AVAILABLE MARCH *** Modern studio flat with Private Entrance. Situated within a popular residential area, close to Sale Moor village and only a stones throw away from the new Metro Link Station. This property comprises private entrance, modern bathroom with shower over bath, stairs leading to first floor, good size lounge and bedroom and fully fitted kitchen with appliances. Ample parking available. Offered on a Furnished basis. Call now to view.

GROUND FLOOR

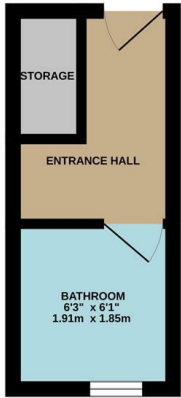

1ST FLOOR

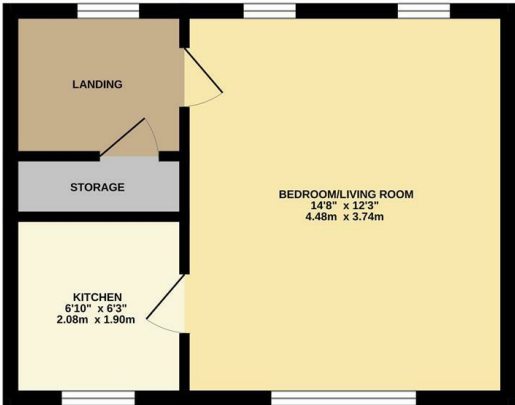

Measurements are approximate. Not to scale. Illustrative purposes only. Made with Metropix ©2025

- ONE BEDROOM FLAT
- PRIVATE ENTRANCE
- FURNISHED
- CLOSE TO METROLINK
- CLOSE TO LOCAL SHOPS
- EPC RATING - C
- COUNCIL TAX BAND A
- PARKING

