



enfields

Enfields Hythe  
3 Marsh Road  
Hythe, Southampton  
Hants, SO15 6AM  
023 8084 9210  
sales.ny@enfields.co.uk

# Oakley Road, Southampton, SO16 4LL

Guide Price £270,000

🛏 3 🚿 1 🚗 2



- No Forward Chain
- On Street Parking
- Two Reception Rooms
- Some Modernisation Required
- Semi Detached Family Home
- Three Bedrooms
- Private Rear Garden
- Viewing Highly Recommended



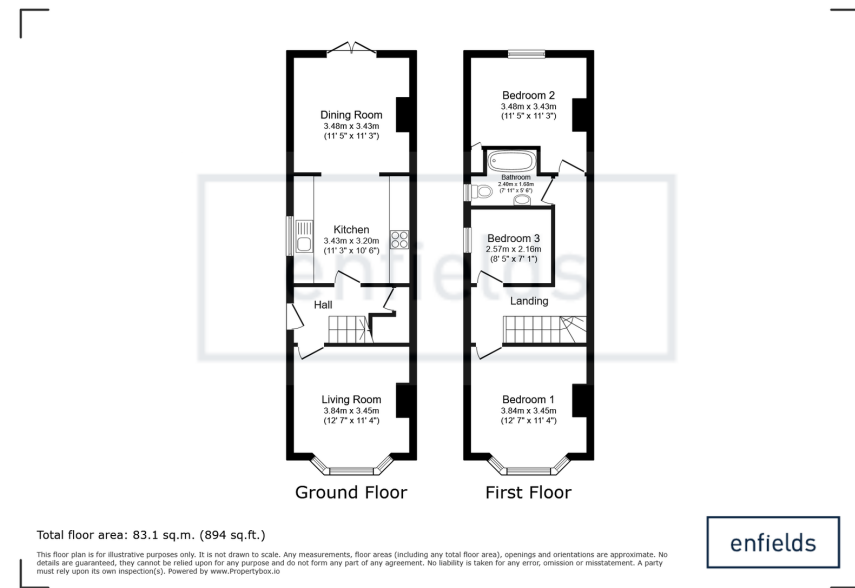

enfields

### No Forward Chain

Enfields are pleased to present to the market this three bedroom semi detached character property with two reception rooms situated on Oakley Road and in need of some modernisation. Available for sale with no forward chain. Early viewing is highly recommended

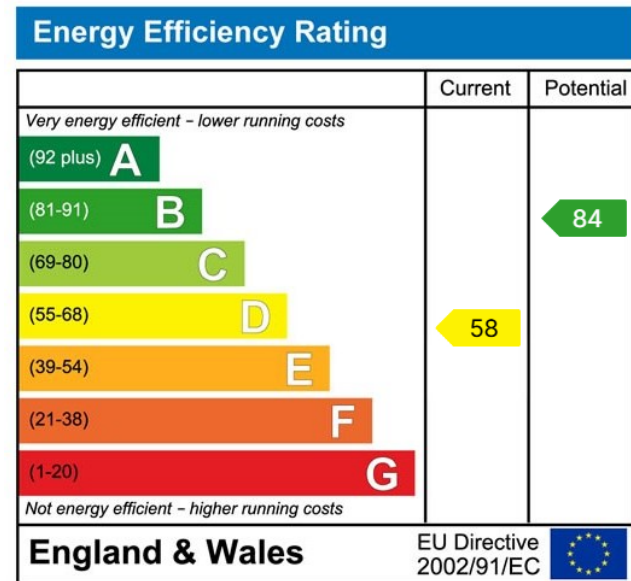

[www.enfields-southampton.co.uk](http://www.enfields-southampton.co.uk)



It is Enfields policy to respect any sole agency currently in force and we would not be able to commence marketing until this has expired or been terminated. If you fail to terminate any previous agreement you could be liable for two sets of fees. Enfields Hythe is a trading name of YTF LTD Registered office: 345 Shirley Road, Southampton, Hampshire, England, SO15 3JD. Company Registration No: 10459987. VAT Registration No: 281 2975 81.

Enfields Lettings - Embley Management LTD T/A Enfields. Registered Address: 345 Shirley Road, Southampton, Hampshire, England, SO15 3JD. Company Registration No: 14847604. VAT Registration No: 439 8546 45.