





# Surrenden Crescent

Brighton, BN1 6WF

Asking price £1,750,000

Set across three impressive floors and extending to approximately 3,535 sq ft, this striking five-bedroom, two-bathroom detached residence combines timeless architecture with spacious, light-filled interiors — offering an ideal home for modern family living.



- Detached 5 Bedroom House
- Double Garage
- Desirable Surrenden Area
- Wrap around garden with mature trees
- Over 3,535.93 sqft
- Three Reception Rooms
- Gated Private Driveway
- Separate Utility Room
- Walking Distance To Preston Park Train Station
- Two Bathrooms

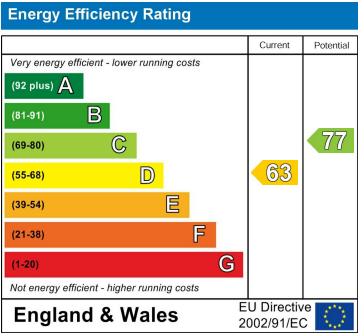

# SURRENDEN CRESCENT

Approx. Gross Internal Floor Area 328.5 sq m / 3535.93 sq ft  
Illustration for identification purposed only, measurements are approximate, not to scale.

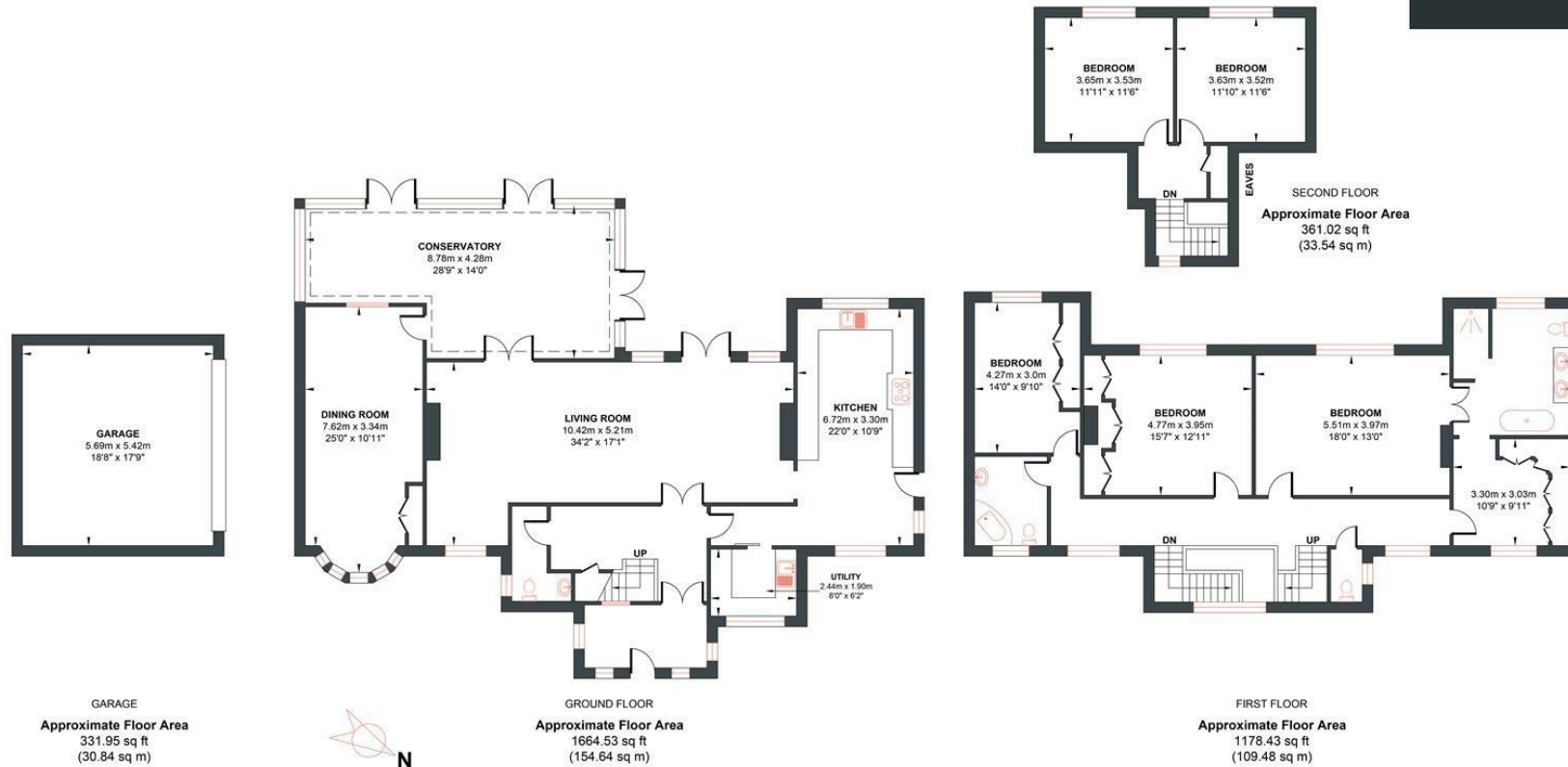

Foster & Co and their clients give notice that:

These sales particulars do not constitute any part of an offer of contract and are for guidance for prospective purchases only and should be not relied upon as a statement of fact.

We are not to be held responsible for material information that has not been given to us by our client at the time of marketing.

All measurements are approximate





