



Alfearn Road, E5

£1,200,000

Dexters



Alfearn Road, E5

A three bedroom Victorian terrace in a prime Lower Clapton location with a south facing garden. This freehold home has been renovated to a high standard throughout by its current owners, yet there is further potential to add value and extend into the loft, subject to planning.

Set behind a smart black facade, this homes ground floor consists of a wider than average hallway, double reception room with room to dine. The U-shaped kitchen to the rear of the house leads to the south facing decked garden.

Upstairs are three double bedrooms, walk-in-wardrobe and luxurious modern family bathroom with terrazzo floors and marble basin.

Only half a mile from Millfields Park, Hackney Downs and Hackney Marshes, the home is surrounded by green spaces offering many opportunities for outdoor recreation. It is within the catchment area of many 'Outstanding' primary and secondary schools and also in walking distance to the independent shops, cafés, weekend Market of Chatsworth Road and Lower Clapton Road. Clapton and Homerton Overground stations are under one mile away and there are numerous bus links on Lower Clapton Road providing excellent transport links.

Features

- Victorian Terrace
- Three Double Bedrooms
- South Facing Garden
- Recently Renovated
- Loft Potential, STPP
- Walk in Wardrobe



Alfearn Road, London, E5

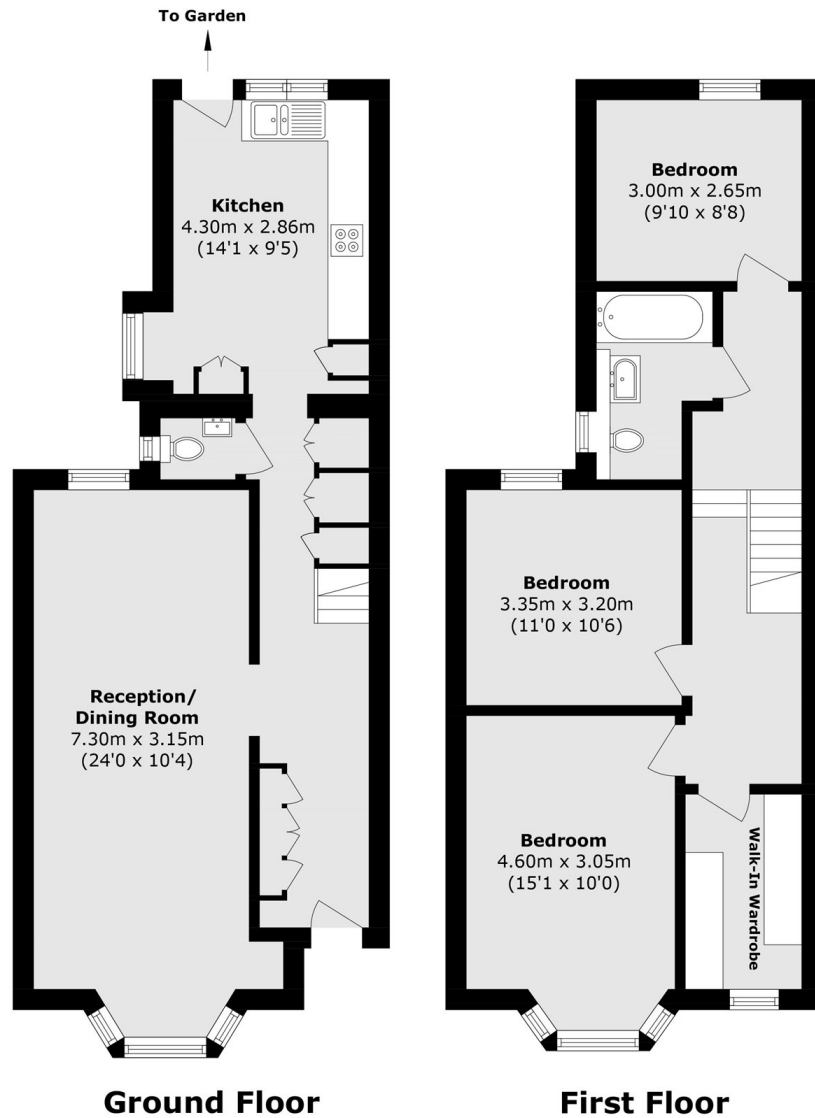

Total area (approx.): 106.5 sq. m (1146.4 sq. ft)