



## Alberta Street, SE17

£830,000

A remarkable three-bedroom split-level flat offering excellent living and entertaining space, with direct access to a private rear garden and its own private entrance. The first floor features a spacious reception room to the front, flooded with natural light through large sash windows. To the rear is a generously sized fitted kitchen/breakfast room, with access via a spiral staircase leading down to the private section of the courtyard, which is beautifully arranged with a variety of plants and shrubs. This floor also includes a large bedroom with an en-suite shower room. The second floor comprises two further double bedrooms, one of which benefits from a Juliet balcony, both served by a stylish shower room. The property also offers excellent storage throughout.

Alberta Street is a quiet residential street located just a short walk from Kennington Underground Station. The area is well served by numerous bus routes and offers excellent access to both Elephant and Castle and Kennington Cross, where you will find a great selection of local shops, cafés, and everyday amenities.

### Features

- Three Double Bedrooms
- Private Entrance
- Excellent Condition
- Two Bathrooms
- Private Garden
- Separate Kitchen

# Alberta Street, London, SE17

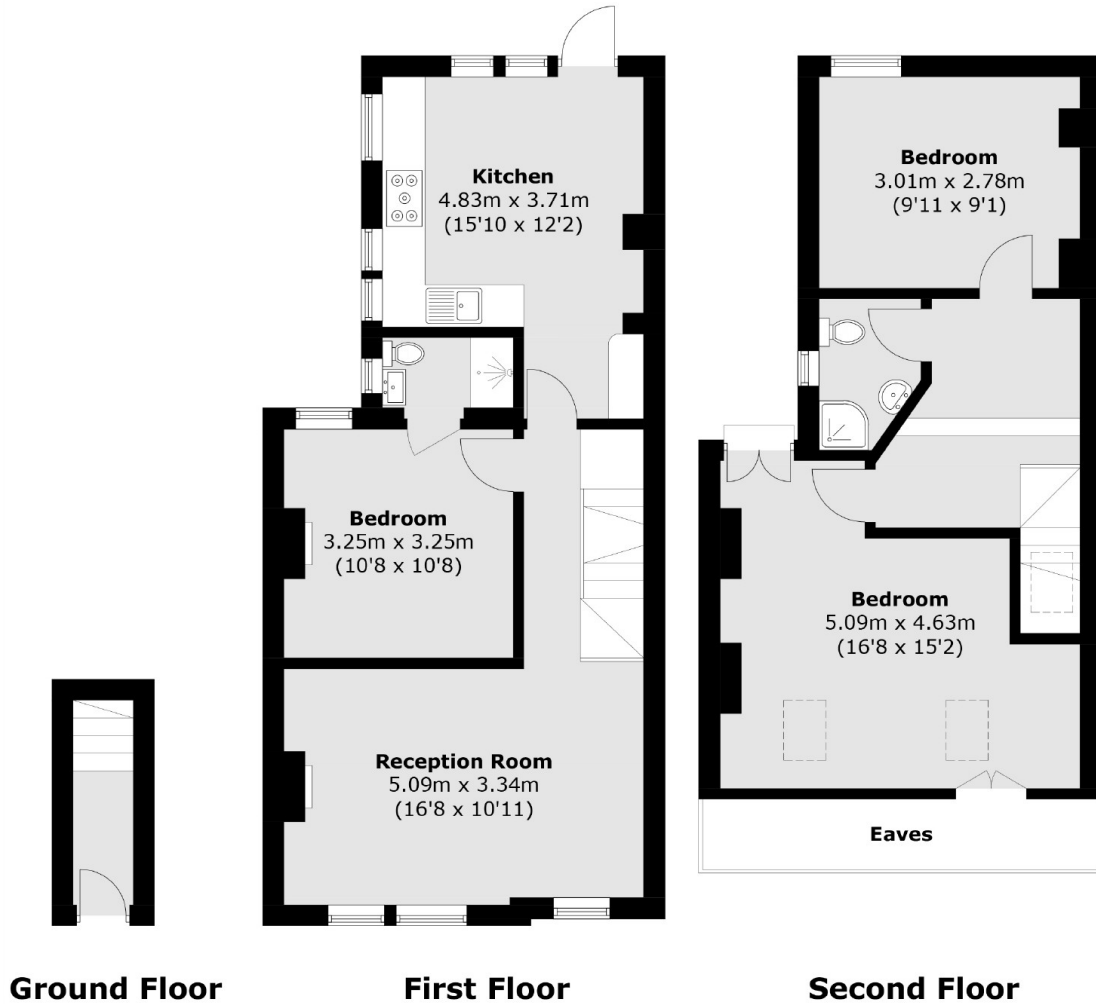

Total area (approx.): 99.5 sq. m (1071.0sq. ft)  
(Excluding Eaves)