



Colney Hatch Lane, N10

£800 Per calendar month

A self-contained studio apartment situated on second floor of a conversion, conveniently located close to the shops and cafés of Muswell Hill. The property comprises a studio room, kitchen and a private bathroom detached from the studio and is perfect for a single occupant. Offered unfurnished.

Muswell Hill is a popular and vibrant North London location, known for its village atmosphere, independent shops, cafés and restaurants, as well as excellent local schools and green spaces. The area offers easy access to Alexandra Palace and its park, with good bus links to nearby Underground stations and the City.

Features

Studio Flat
Second Floor
Furnished
Muswell Hill Broadway
Private bathroom
Open Plan

Colney Hatch Lane,
London, N10

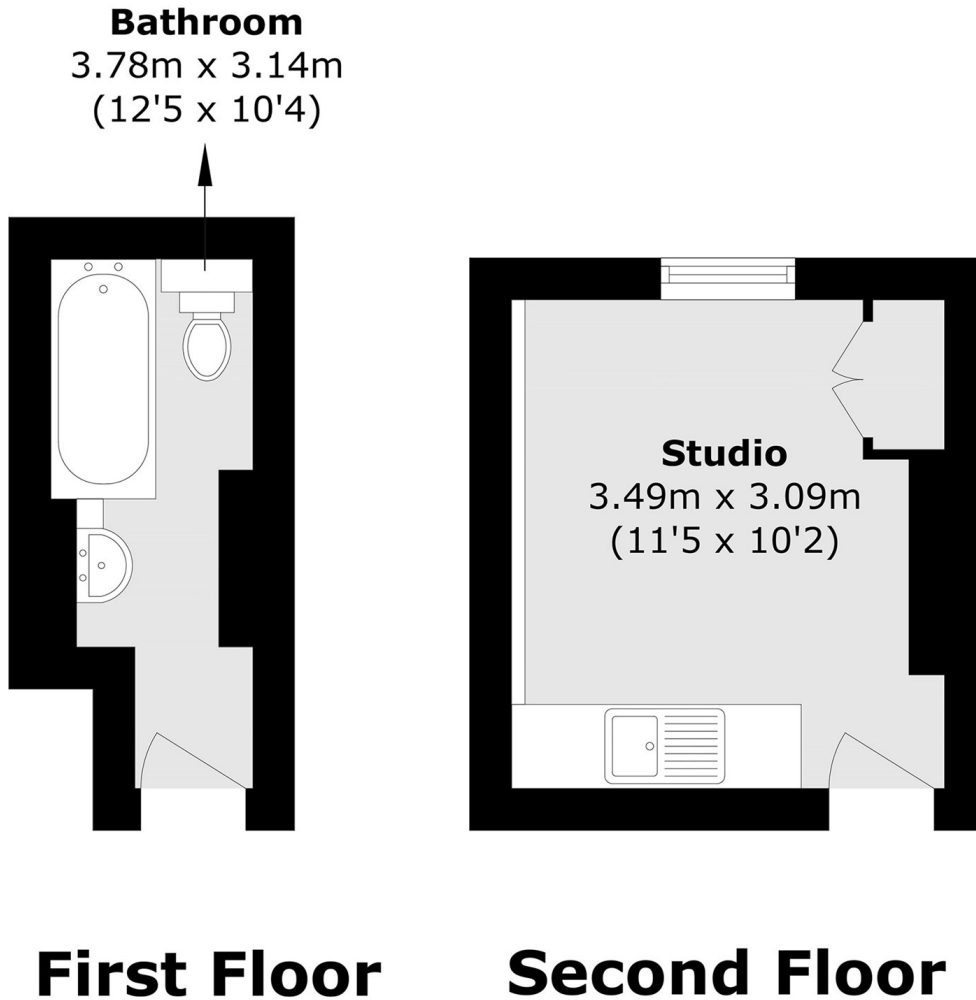

Total area (approx.): 15.6 sq. m (167.9 sq. ft)