



ST. GEORGES GROVE, SW17

£2,450 PCM

- Modern apartment
- Private balcony
- Open plan kitchen/living
- Excellent condition
- Sought after location
- Energy rating: C





ABOUT THE HOME

A beautifully presented, two double bedroom apartment located in a purpose built building, in the popular St Georges Grove development. This property benefits from it's own private balcony.

The property is situated in the highly sought after St. George's Grove development formally known as the 'Quadrangle', gives ease of access to both Earlsfield mainline station and Tooting Broadway underground Station (Northern Line). Garratt Lane's array of bars, restaurants and convenience stores are also close by.





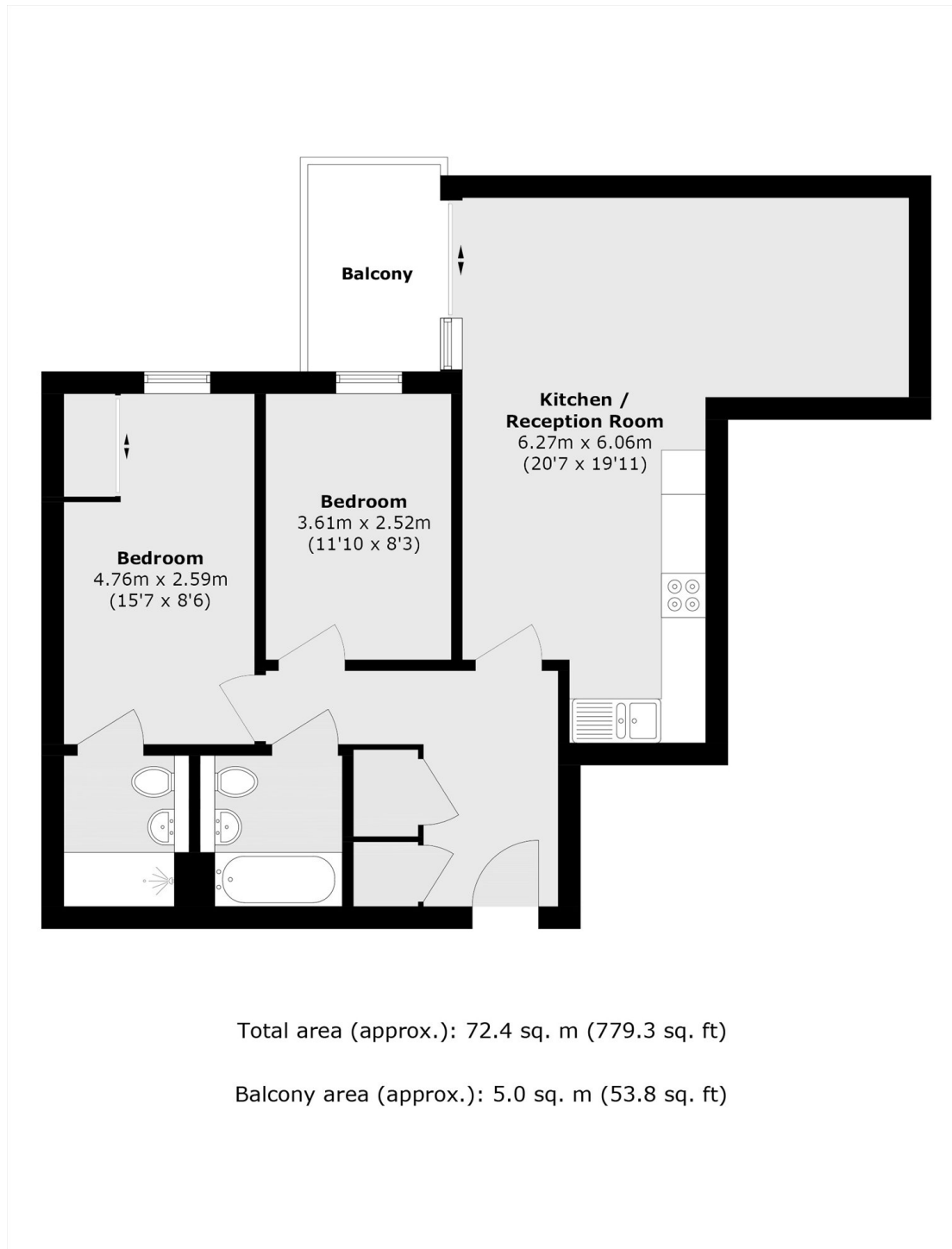

JACKSONS EARLSFIELD

372-374 Garratt Lane,
Earlsfield, London, SW18 4ES
Sales: 020 8971 7979
Lettings: 020 8971 7070

Energy Rating: We aim to make our particulars both accurate and reliable. However they are not guaranteed; nor do they form part of an offer or contract. If you require clarification on any points then please contact us, especially if you're traveling some distance to view. Please note that appliances and heating systems have not been tested and therefore no warranties can be given as to their good working order.