



1 Limestone Close | Woodsetts | Worksop | S81 8RU

£225,000

Bell & Co Estates are delighted to present this well maintained two bedroom semi-detached bungalow, ideally situated in the sought-after village of Woodsetts, Worksop. Upon entering the property, you are welcomed via a porch into a central hallway. The generously sized lounge is positioned to the front of the home, offering a bright and inviting space to relax. The kitchen/diner provides a practical and sociable space, fitted with a range of wall and base units, generous worktop space and room for dining. The property boasts two well-proportioned bedrooms, including a spacious master bedroom and a versatile second room which can be utilised as a guest bedroom, home office or additional sitting room depending on your needs. A contemporary family bathroom completes the internal accommodation, featuring a bath with shower over, wash basin and WC. Externally, the property continues to impress. To the rear is a private enclosed garden, offering a peaceful outdoor space perfect for relaxing or entertaining. The home also benefits from a detached garage, providing additional storage or parking, alongside further off-road parking. Situated in the popular village of Woodsetts, the property is conveniently located close to local amenities, reputable schools and excellent transport links, making it an ideal choice for commuters and families. Early viewing is highly recommended to fully appreciate the space, versatility and location this fantastic home has to offer. Call Bell & Co Estates now!



GROUND FLOOR
692 sq.ft. (64.3 sq.m.) approx.

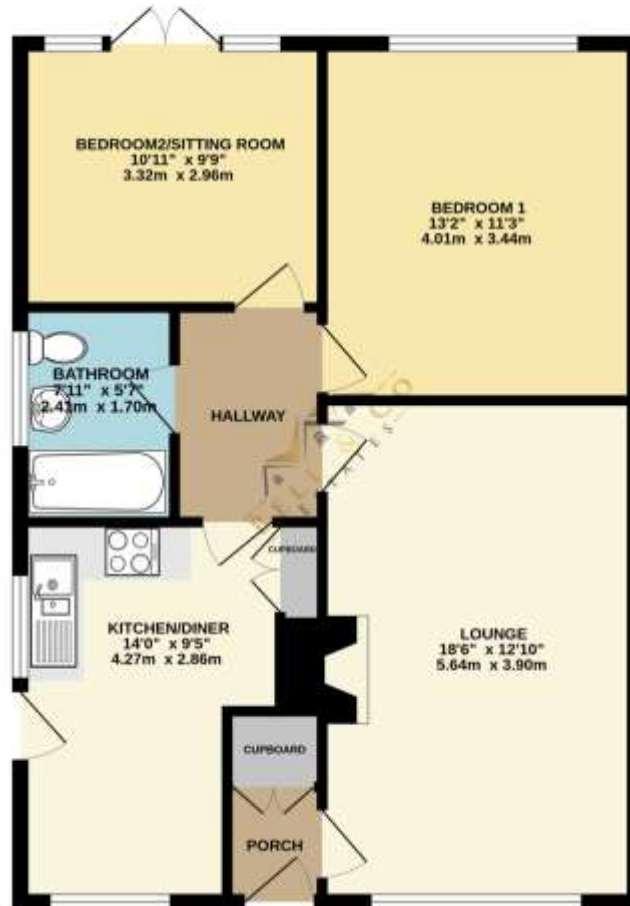

Contact Details

79 Wales Road
Kiveton Park
Sheffield
South Yorkshire
S26 6RA

www.bellcoestates.com
info@bellcoestates.com
03333 580590

Agents Note: Whilst every care has been taken to prepare these sales particulars, they are for guidance purposes only. All measurements are approximate and for general guidance purposes only and whilst every care has been taken to ensure their accuracy, they should not be relied upon and potential buyers are advised to recheck the measurements