

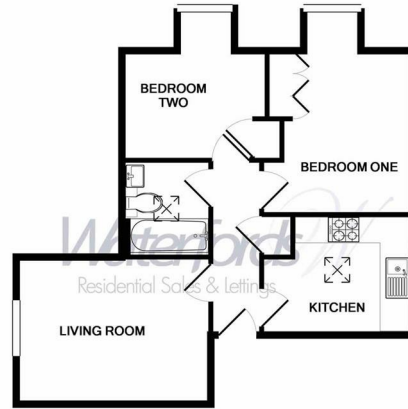

Ivy Drive | Lightwater | Surrey | GU18 5YT

£1,350 PCM

*Waterfords* W  
Residential Sales & Lettings



Whilst every attempt has been made to ensure the accuracy of the floor plan contained here, measurements of doors, windows, rooms and any other items are approximate and no responsibility is taken for any error, omission, or mis-statement. This plan is for illustrative purposes only and should be used as such by any prospective purchaser. The services, systems and appliances shown have not been tested and no guarantee as to their operability or efficiency can be given.  
Made with Metropix ©2017



Energy Efficiency Rating		Current	Potential
Very energy efficient - lower running costs			
(92 plus)	A		
(81-91)	B		
(69-80)	C		
(55-68)	D	74	75
(39-54)	E		
(21-38)	F		
(1-20)	G		
Not energy efficient - higher running costs			
England & Wales		EU Directive 2002/91/EC	



## Description

Waterfords present Bright and spacious two-bedroom apartment on the second floor of a popular development on Ivy Drive, Lightwater. Offered unfurnished, it features a modern kitchen, contemporary bathroom, and two well-proportioned bedrooms. Excellent transport links and close to local amenities. Available to let from May

## Key features

- Second Floor Apartment
- Separate Modern Kitchen With Appliances
- M3, M25 And A30 Within Easy Reach
- Unfurnished
- EPC C
- Two Double Bedrooms With Built In Wardrobes
- Allocated Parking And Communal Gardens
- Available May 2026
- Council Tax Band C
- Long Term Let



35 Plough Road  
Hampshire  
GU46 7UW  
01276 903006

surreylettings@waterfords.co.uk  
<https://www.waterfords.co.uk/>