



Connells

Signal Close  
Henlow



## Property Description

A very well presented 3 bedroom family home situated in a lovely quiet location in Lower Stondon.

Offering excellent downstairs living space, upstairs are 3 excellent size bedrooms and a smartly fitted family bathroom. Outside is a fantastic rear garden and ample driveway parking.

## Ground Floor

### Entrance Hall

Double glazed door and window to front aspect, radiator and stairs to first floor.

### Cloakroom

Fully tiled with a double glazed window to front aspect, WC, sink and heated towel rail.

### Lounge/Diner

17' 1" x 16' ( 5.21m x 4.88m )

Double glazed window to rear aspect, double glazed French door to rear, wood effect flooring and radiator.

### Kitchen

9' 3" x 7' 9" ( 2.82m x 2.36m )

Double glazed window to front aspect, a fully fitted kitchen comprising wall and base units, work surfaces with matching splashbacks, integral gas hob and electric oven with cooker hood over, integral dishwasher and washing machine.

## First Floor

### Landing

Doors to all first floor accommodation and loft access.

### Bedroom 1

13' 10" x 10' 2" ( 4.22m x 3.10m )

Double glazed window to rear aspect, built in double wardrobes and radiator.

### Bedroom 2

10' 11" x 7' 2" ( 3.33m x 2.18m )

Double glazed window to front aspect and radiator.

### Bedroom 3

11' 6" x 8' 5" Max ( 3.51m x 2.57m Max )

Double glazed window to front aspect, built in cupboard housing boiler and radiator.

## Bathroom

Partly tiled, WC, sink with vanity unit, P-shaped bath with shower over and heated towel rail. Extractor fan.

## Outside

### Rear Garden

A lovely rear garden which is mostly laid to lawn with mature trees and shrubs. Side access.

### Parking

Driveway parking for 2 vehicles.







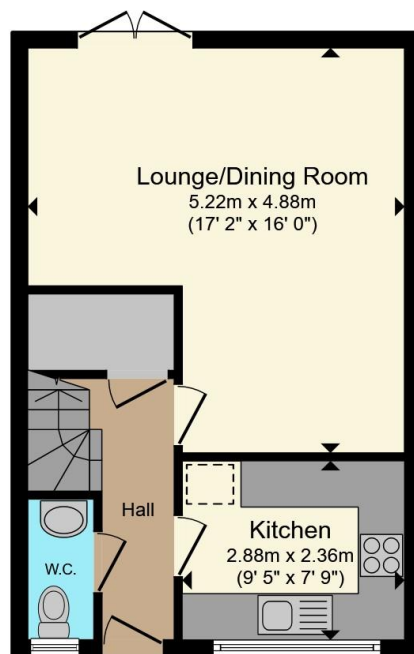

**Ground Floor**

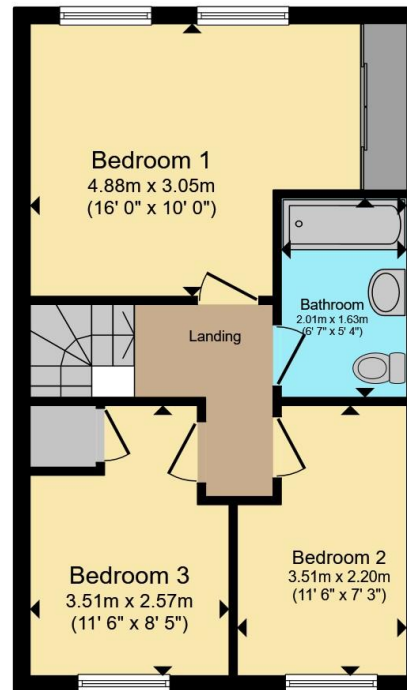

**First Floor**

Total floor area 78.8 m<sup>2</sup> (848 sq.ft.) approx

This floor plan is for illustrative purposes only. It is not drawn to scale. Any measurements, floor areas (including any total floor area), openings and orientation are approximate. No details are guaranteed, they cannot be relied upon for any purpose and they do not form part of any agreement. No liability is taken for any error, omission or misstatement. A party must rely upon its own inspection(s). Powered by [www.propertybox.io](http://www.propertybox.io)



To view this property please contact Connells on

**T 01462 437 666**  
**E [hitchin@connells.co.uk](mailto:hitchin@connells.co.uk)**

14 High Street  
 HITCHIN SG5 1AT

EPC Rating: Council Tax  
 Awaited Band: E

Tenure: Freehold

**view this property online [connells.co.uk/Property/HIT308497](http://connells.co.uk/Property/HIT308497)**



1. MONEY LAUNDERING REGULATIONS Intending purchasers will be asked to produce identification documentation at a later stage and we would ask for your co-operation in order that there will be no delay in agreeing the sale. 2. These particulars do not constitute part or all of an offer or contract. 3. The measurements indicated are supplied for guidance only and as such must be considered incorrect. Potential buyers are advised to recheck measurements before committing to any expense. 4. We have not tested any apparatus, equipment, fixtures, fittings or services and it is in the buyers interest to check the working condition of any appliances.

Connells Residential is registered in England and Wales under company number 1489613, Registered Office is Cumbria House, 16-20 Hockliffe Street, Leighton Buzzard, Bedfordshire, LU7 1GN. VAT Registration Number is 500 2481 05.

**See all our properties at [www.connells.co.uk](http://www.connells.co.uk) | [www.rightmove.co.uk](http://www.rightmove.co.uk) | [www.zoopla.co.uk](http://www.zoopla.co.uk)**

Property Ref: HIT308497 - 0002