

# H Together Homes



**CROWNMEAD WAY  
ROMFORD**

**£400,000  
Guide price**

\*\*\* GUIDE PRICE OF £400,000-£425,000 \*\*\*

This is an excellent opportunity to acquire a well presented and versatile home, perfectly suited for first time buyers or a growing family looking to step onto the ladder. Offered to the market chain free, this is a smooth and straightforward purchase not to be missed.

The property offers fantastic kerb appeal and exciting potential to create off-street parking to the front (STPP), adding both practicality and future value.

Internally, the home delivers well balanced accommodation throughout. You are welcomed by a bright entrance, leading to a convenient ground floor W/C ideal for visiting guests. The spacious lounge sits to the front of the property, creating a cosy yet generous living space, while to the rear, the kitchen/diner overlooks the low maintenance garden perfect for



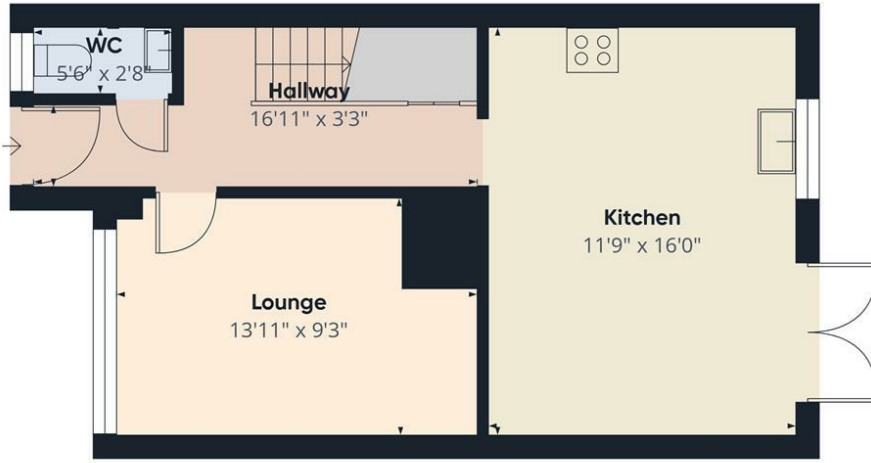

Floor 0

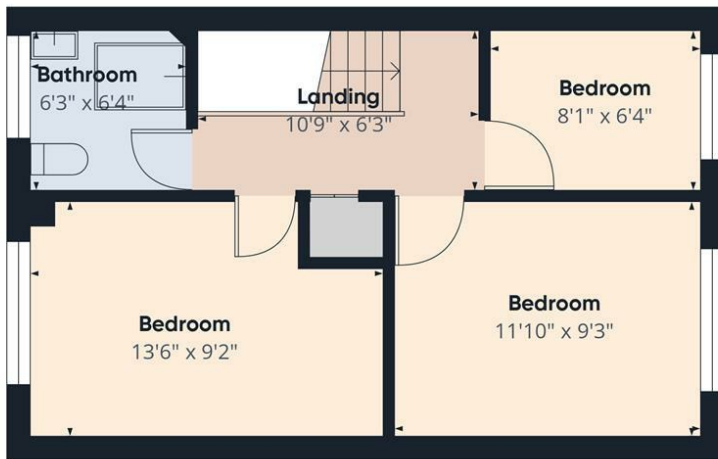

Floor 1

Approximate total area<sup>(1)</sup>  
794 ft<sup>2</sup>

(1) Excluding balconies and terraces

Calculations reference the RICS IPMS 3C standard. Measurements are approximate and not to scale. This floor plan is intended for illustration only.

GIRAFFE360

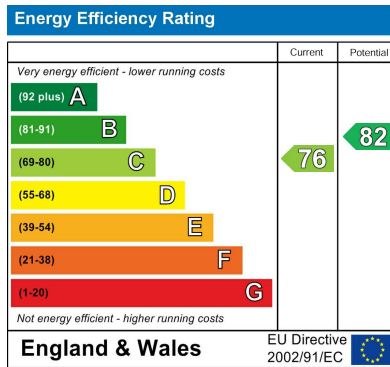

Agents Note: Whilst every care has been taken to prepare these particulars, they are for guidance purposes only. All measurements are approximate and are for general guidance purposes only and whilst every care has been taken to ensure their accuracy, they should not be relied upon and potential buyers/tenants are advised to recheck the measurements

**Together Homes**  
21 Station Parade  
Hornchurch  
RM12 5AB

01708 320 600  
sales@togetherhomes.co.uk  
togetherhomes.co.uk

