

**ROBERTSON PHILLIPS**  
Estate Agents, Valuers,  
Lettings and Property Management

40 Station Road, North Harrow,  
Middlesex, HA2 7SE  
Tel: 0208 863 1122

Email: [harrow@robertsonphillips.co.uk](mailto:harrow@robertsonphillips.co.uk)

Harrow Lettings: 0208 092 4045  
Hatch End/Pinner Sales: 0208 428 7161

  
**ROBERTSON  
PHILLIPS**  
Est. 1991

## ***PARKSIDE WAY, NORTH HARROW***



***Three Bedroom Semi-Detached House***

***GUIDE PRICE £650,000***



[www.robertsonphillips.co.uk](http://www.robertsonphillips.co.uk)



## *Description*

A Chain-Free, three-bedroom, bay-fronted semi-detached property enters the market with Robertson Phillips Estate Agents. The property is situated close to local shopping facilities, a Metropolitan Line train station, and is within the catchment area for Pinner Park School. While the house would benefit from a programme of refurbishment, it offers the potential to become a fantastic family home.

Accommodation: • Entrance hallway • Lounge • Sitting room • Kitchen • Three bedrooms • Family bathroom

Further Benefits: • Gas central heating • Double glazing • Private garage • Delightful, wide 110ft rear garden



***Location:*** Leading on from Station Road.





- *Bay Fronted three bedroom semi-detached house*
- *Offered for sale in need of a little updating*
- *Gas central heating and double glazed windows*
- *Two reception rooms*
- *No Upper Chain*
- *Viewing Advised*



#### Additional Information

TENURE. FREEHOLD

LOCAL AUTHORITY. HARROW

ENERGY EFFICIENCY RATING. TBC

## Ground Floor

Approx. 66.9 sq. metres (720.4 sq. feet)

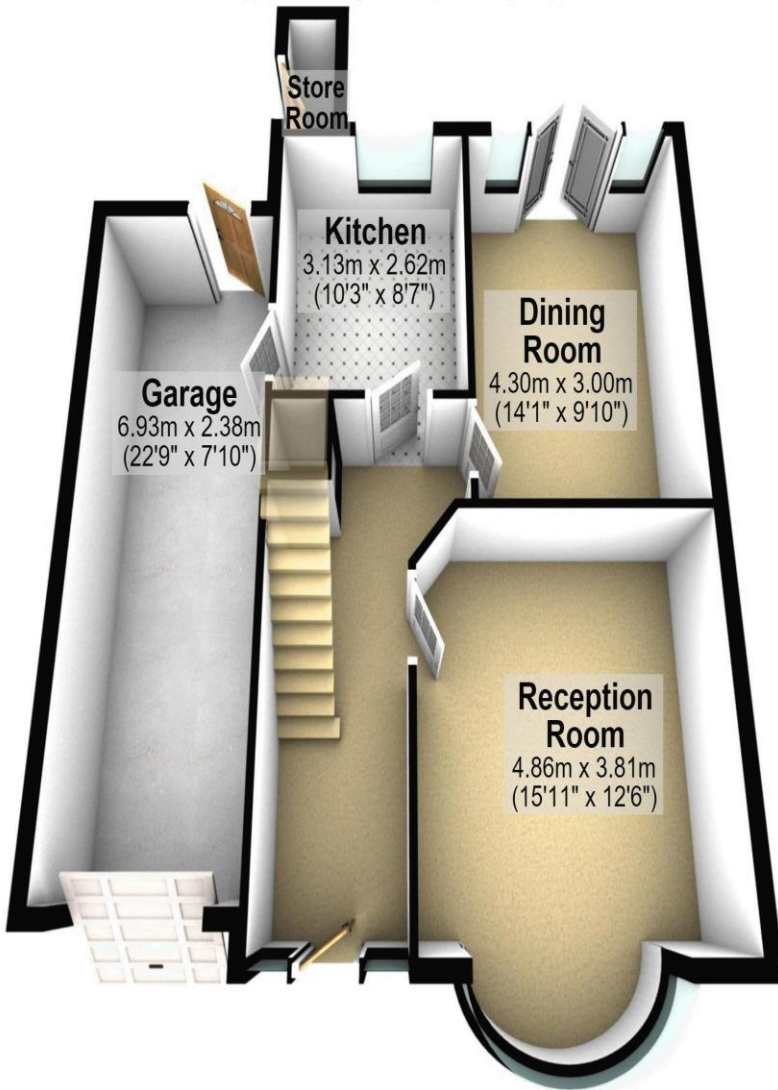

## First Floor

Approx. 45.6 sq. metres (491.2 sq. feet)

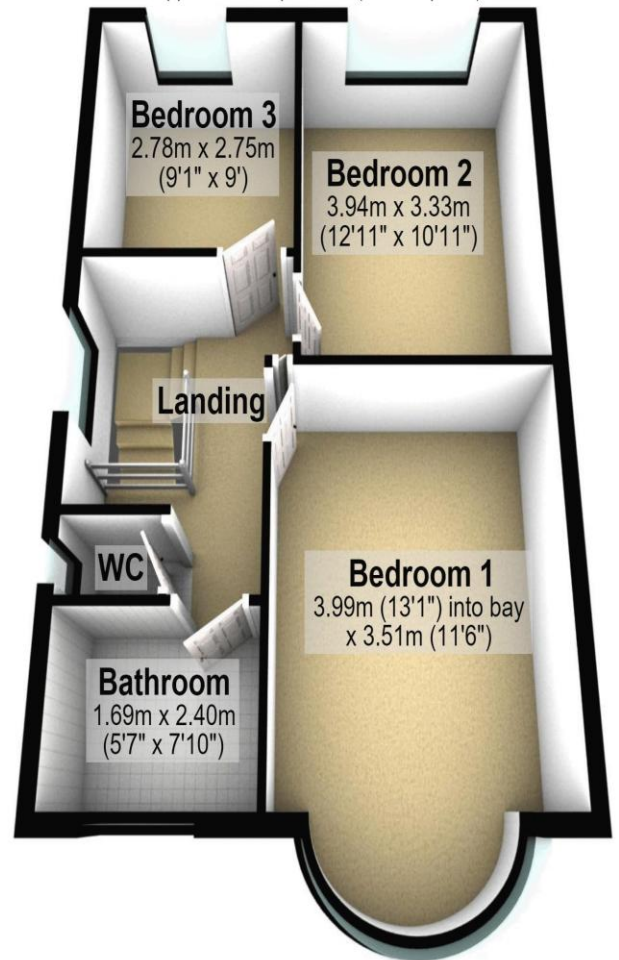

Total area: approx. 112.6 sq. metres (1211.6 sq. feet)



We have not sought to verify the legal title of the property, the existence of planning permissions and/or building regulation approvals and have been unable to check the working condition of any services or appliances.

Property layouts are for general guidance and are not drawn exactly to scale. Measurements are taken at the widest points and bays, alcoves, wardrobes etc. may not be shown.