



[www.jeffreygross.co.uk](http://www.jeffreygross.co.uk)

CARDIFF

VALE

CAERPHILLY

BRISTOL

*Glynrhondda Street*

CATHAYS



Comments by Mr Nicky Pearcey

**Property Specialist**  
**Mr Nicky Pearcey**  
Lettings Negotiator

nicky@jeffreycross.co.uk



Comments by the Homeowner

Glynhondda Street, Cathays

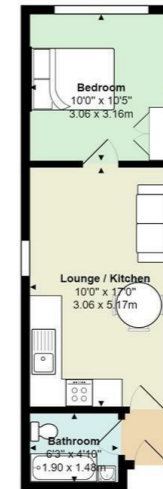

Total Area: 327 ft<sup>2</sup> ... 30.4 m<sup>2</sup>

All measurements are approximate and for display purposes only



Energy Efficiency Rating		Current	Potential
Very energy efficient - lower running costs			
(92 plus) <b>A</b>			
(81-91) <b>B</b>			
(69-80) <b>C</b>		70	82
(55-68) <b>D</b>			
(39-54) <b>E</b>			
(21-38) <b>F</b>			
(1-20) <b>G</b>			
Not energy efficient - higher running costs			
<b>England &amp; Wales</b>	EU Directive 2002/91/EC		



# Glynrhondda Street

Cathays, Cardiff, CF24 4AN

PCM

£850 PCM



1 Bedroom(s)



1 Bathroom(s)



sq ft



Contact our  
**Students Branch**

02920 499680

Slap bang in the middle of Cathays is this very impressive and extremely spacious one bedroom apartment in a great, GREAT location. Located on Glynrhondda Street, this first-floor apartment has been recently (and very nicely!) renovated by its owner to make a brilliant property! Offering open-plan lounge kitchen with lovely laminate flooring, stylish kitchen and top-quality furnishings, it's a perfect space for a couple. The bedroom (to the back of the property) is a brilliant size too with excellent clothes storage. The property is completed by an equally stylish shower suite. Perfect for those who are in need of living so close to the SU and all the action!

GAS CENTRAL HEATING. FURNISHED. FULL RENT PAYABLE FROM START OF CONTRACT.

EPC RATING of C

A holding fee of £50 per person will be payable to secure the dwelling. This will be deducted from the final balance payable upon moving into the dwelling, subject to a successful application. Jeffrey Ross Limited reserves the right to retain this payment should the applicant have provided false or misleading information at the time of applying for the dwelling or failed to take reasonable steps to enter into the Standard Occupation Contract.





CARDIFF

VALE

CAERPHILLY

BRISTOL

[www.jeffreygross.co.uk](http://www.jeffreygross.co.uk)