



## Ashford Road, NW2

£375,000

A bright and spacious two double bedroom apartment featuring a large reception room ideal for both relaxing and entertaining and a separate fully fitted kitchen. Further benefits include a 24 hour porter, long lease and no onward chain, making it an excellent purchase for both homeowners and investors alike.

Ashford Road is set in the heart of Cricklewood, close to local shops, cafés and everyday amenities. Superb transport links via Cricklewood railway station and Willesden Green station offer easy access into central London.

### Features

- Two Double Bedrooms
- Large Reception Room
- Separate Kitchen
- 24 Hour Porter
- Long Lease
- No Onward Chain

# Ashford Road, London, NW2

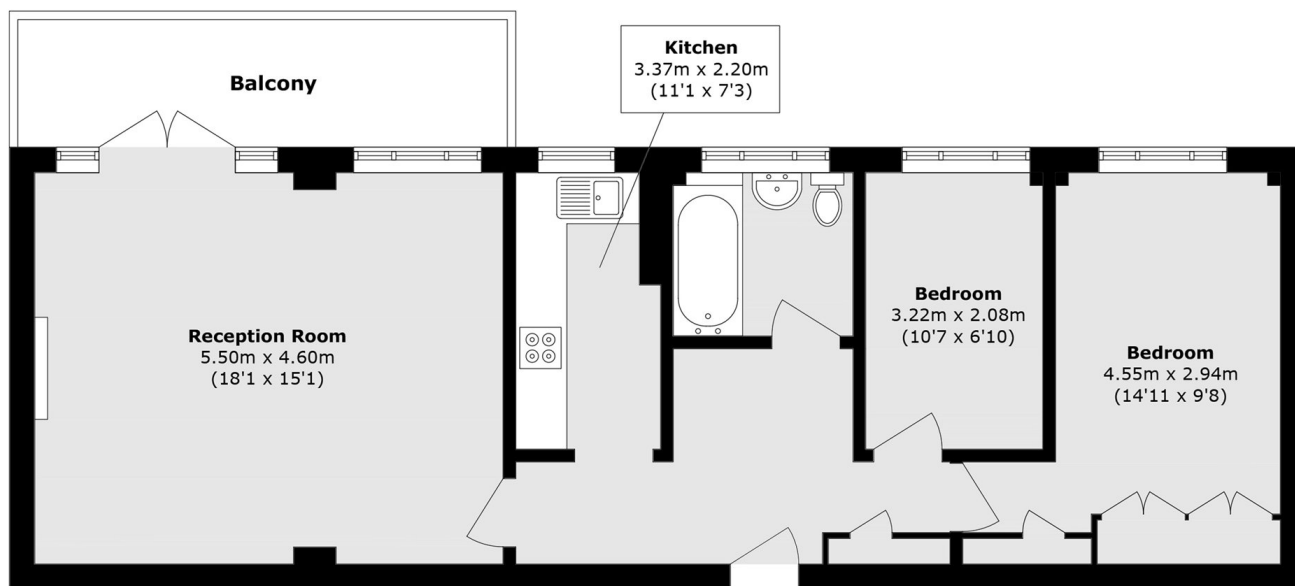

Total area (approx.): 67.2 sq. m (723.3 sq. ft)

Balcony area (approx.): 8.2 sq. m (88.2 sq. ft)