

29 Stryd Yr Wylan, Ruthin, LL15 1QJ – £255,000

Tenure: Freehold | EPC: B83 | Council Tax: D

A modern family home set in a desirable cul-de-sac, located near good schools and local amenities. This well presented and appointed three bedroom semi-detached property built in 2019 comprises of a lounge leading into a modern fitted kitchen diner with integrated appliances, spacious downstairs cloak room, a family bathroom and three bedrooms with the master having an en-suite, further benefits are south facing landscaped enclosed garden and handstanding driveway providing ample off road parking.

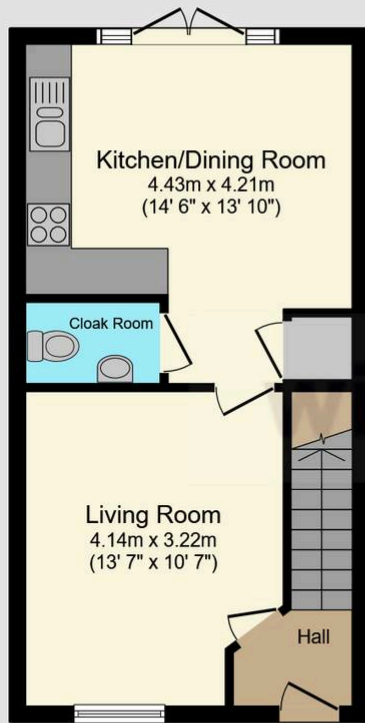

Ground Floor

Floor area 36.9 sq.m. (397 sq.ft.)

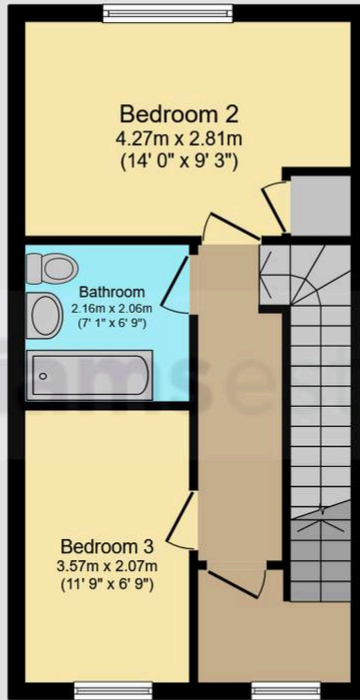

First Floor

Floor area 36.9 sq.m. (397 sq.ft.)

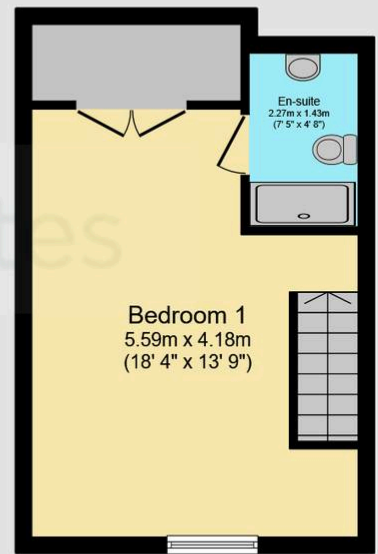

Second Floor

Floor area 28.0 sq.m. (302 sq.ft.)

Total floor area: 101.8 sq.m. (1,096 sq.ft.)

This floor plan is for illustrative purposes only. It is not drawn to scale. Any measurements, floor areas (including any total floor area), openings and orientations are approximate. No details are guaranteed, they cannot be relied upon for any purpose and do not form any part of any agreement. No liability is taken for any error, omission or misstatement. A party must rely upon its own inspection(s). Powered by www.Propertybox.io



YOUR FREE
PROPERTY REPORT



WE OFFER FREE ADVICE

MORTGAGES - SURVEYS - SOLICITORS

