



Compton Road, N1

£1,200,000

Set within a picturesque terrace of Grade II listed, Georgian houses in Canonbury. This two double-bedroom home is situated on the lower ground floor. Other benefits include a communal garden and a private entrance.

Compton Road is a prime residential street in the heart of Canonbury. Highbury & Islington Station (Victoria line, London Overground and National Rail) provides excellent transport links as well as numerous bus routes from Highbury Corner providing links to the City, West End and beyond. Upper Street is a short walk away with an array of cafés, independent shops, restaurants and bars.

Features

- Two Bedrooms
- Period Conversion
- Private Entrance
- Separate Kitchen
- Desirable Location
- Communal Garden

Compton Road, London, N1

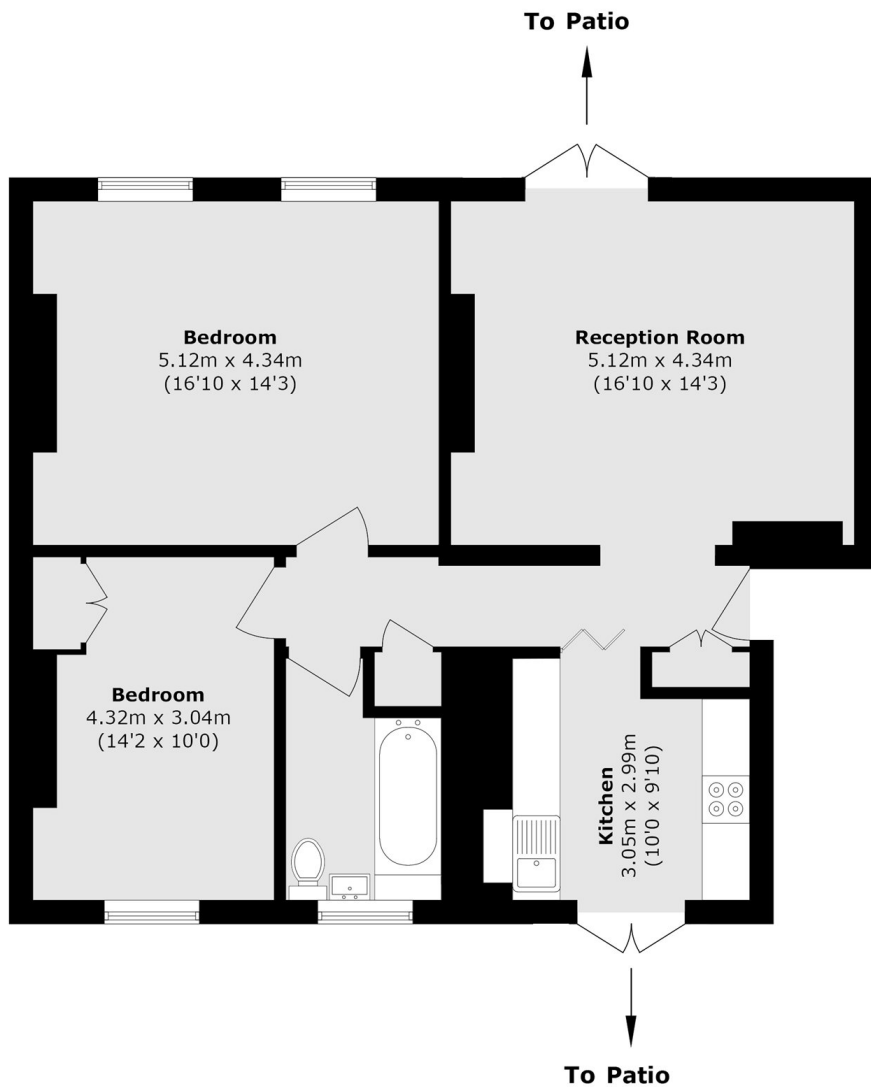

Total area (approx.): 94.6 sq. m (1019.0 sq. ft)