



Castles

ASKING PRICE

**£700,000**

**Pembroke Avenue**

Enfield, EN1 4HE

## PROPERTY SUMMARY

A beautifully presented semi-detached home offering a perfect blend of modern comfort and classic style, with 1,760 sq ft of generous living space.

The property features four bedrooms—three on the first floor and a loft bedroom with an en-suite. There are three bathrooms in total, including one on the ground floor. The home also offers two bright and spacious reception rooms and a high-spec, fully updated kitchen, ready for immediate move-in.

The loft room provides excellent privacy, while the large garage offers ample space for cars and additional storage.

Outside, you'll find both a front and rear garden, fully gated and equipped with an intercom front gate, adding convenience and security.

This is an ideal family home in a friendly neighbourhood with great local amenities.



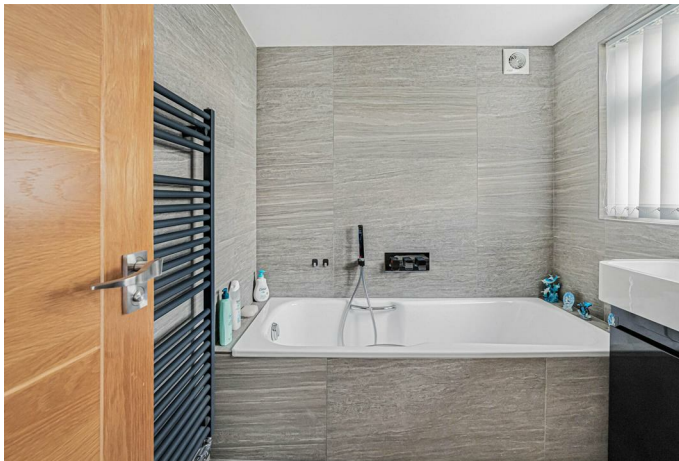

Pembroke Avenue, Enfield, EN1

Approximate Gross Internal Area = 1760 sq ft / 163.4 sq m  
(Including Garage & Outbuilding)

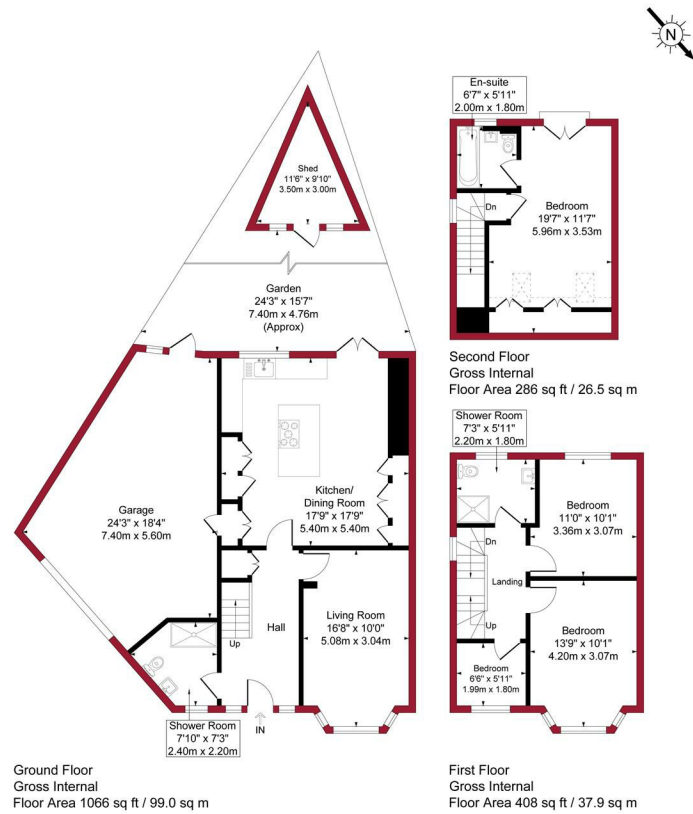

For a guide to the area  
please scan this code for  
more information

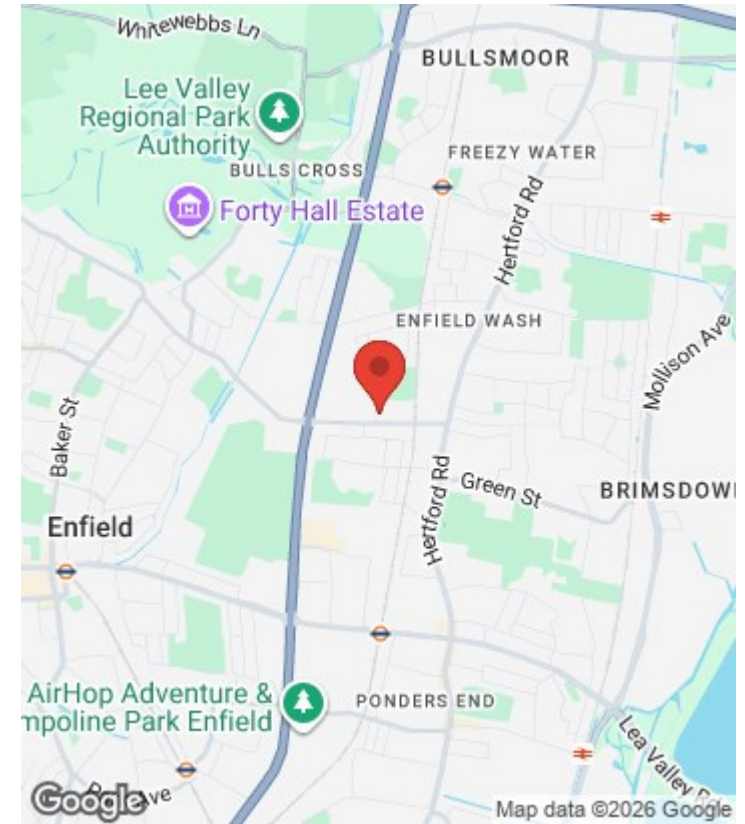

House - Semi-Detached

Freehold

**Council:** Enfield

**Council Tax Band:** D

Agents Note: Whilst every care has been taken to prepare these particulars, they are for guidance purposes only. All measurements are approximate and are for general guidance purposes only and whilst every care has been taken to ensure their accuracy, they should not be relied upon and potential buyers/tenants are advised to recheck the measurements



**OFFICE ADDRESS**

243 - 245 Hertford Road  
Enfield  
London  
EN3 5JJ

**OFFICE DETAILS**

0208 804 8000  
enfield@castles.london  
<https://www.castles.london>

