



Connells

Ringlet Court Admiral Drive
STEVENAGE



Property Description

We are pleased to present a purpose built ground floor apartment with one double bedroom on the ever popular Chrysalis Park development, boasting spacious open plan living room with modern fitted kitchen. The apartment has electric heating, double glazing, secure entry phone system, modern 3 piece bathroom, utility cupboard, secure allocated parking and 139 years remaining on the lease.

Chrysalis Park is ideally located within easy reach of local amenities, good schooling for all ages & convenient road links to the town centre & A1M serving the north & south. Stevenage provides a fast & efficient link to London via the mainline station, the historic old high street with array of shops, restaurants, bars & the pedestrian new town centre with indoor market.

Communal Entrance Hall

Front Door

Entrance Hall

Open Plan Lounge / Kitchen

Bedroom

Bathroom

Allocated Parking Space



Communal Entrance Door



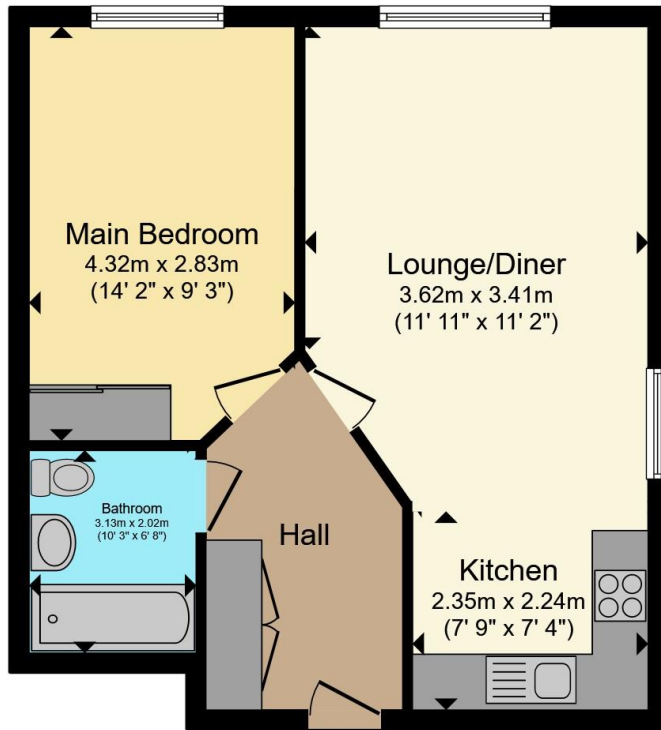

Total floor area 47.6 m² (512 sq.ft.) approx

This floor plan is for illustrative purposes only. It is not drawn to scale. Any measurements, floor areas (including any total floor area), openings and orientation are approximate. No details are guaranteed, they cannot be relied upon for any purpose and they do not form part of any agreement. No liability is taken for any error, omission or misstatement. A party must rely upon its own inspection(s). Powered by www.propertybox.io



To view this property please contact Connells on

T 01438 318 080
E stevenage@connells.co.uk

8 Market Place
 STEVENAGE SG1 1DB

EPC Rating:
 Awaited

Council Tax
 Band: B

Service Charge: Ask
 Agent

Ground Rent:
 Ask Agent

Tenure: Leasehold

view this property online connells.co.uk/Property/STV312702

This is a Leasehold property. We are awaiting further details about the Term of the lease. For further information please contact the branch. Please note additional fees could be incurred for items such as Leasehold packs.



1. MONEY LAUNDERING REGULATIONS Intending purchasers will be asked to produce identification documentation at a later stage and we would ask for your co-operation in order that there will be no delay in agreeing the sale. 2. These particulars do not constitute part or all of an offer or contract. 3. The measurements indicated are supplied for guidance only and as such must be considered incorrect. Potential buyers are advised to recheck measurements before committing to any expense. 4. We have not tested any apparatus, equipment, fixtures, fittings or services and it is in the buyers interest to check the working condition of any appliances.

Connells Residential is registered in England and Wales under company number 1489613, Registered Office is Cumbria House, 16-20 Hockliffe Street, Leighton Buzzard, Bedfordshire, LU7 1GN. VAT Registration Number is 500 2481 05.

See all our properties at www.connells.co.uk | www.rightmove.co.uk | www.zoopla.co.uk

Property Ref: STV312702 - 0002