

Harrowbarrow, Callington, PL17

Offers Over £385,000

4 2 1



A beautifully presented semi-detached period property, tucked away within a peaceful rural setting. Full of charm and character throughout, this attractive home benefits from four double bedrooms, off-road parking for two vehicles, and stunning countryside views.

Situated on the outskirts of the village of Harrowbarrow, approximately 4 miles from Callington and 8 miles from Tavistock, the property enjoys a peaceful countryside setting whilst remaining conveniently located for local amenities. The nearby villages of Harrowbarrow and Metherell, approximately 0.7 miles away, offer a community shop, primary school, public house, church, children's play park, bus services, and a thriving village hall.

Key Features

- TO ARRANGE A VIEWING PLEASE QUOTE BL0650
- Four Double Bedrooms (1 Ensuite)
- Family Bathroom & Utility Room
- Expansive Open-Plan Living Space
- Peaceful Rural Setting
- Semi-Detached
- Off-Road Parking For Two Vehicles
- Charm & Character Throughout
- Countryside Views
- Freehold

Approximate Gross Internal Area = 146.1 sq m / 1573 sq ft

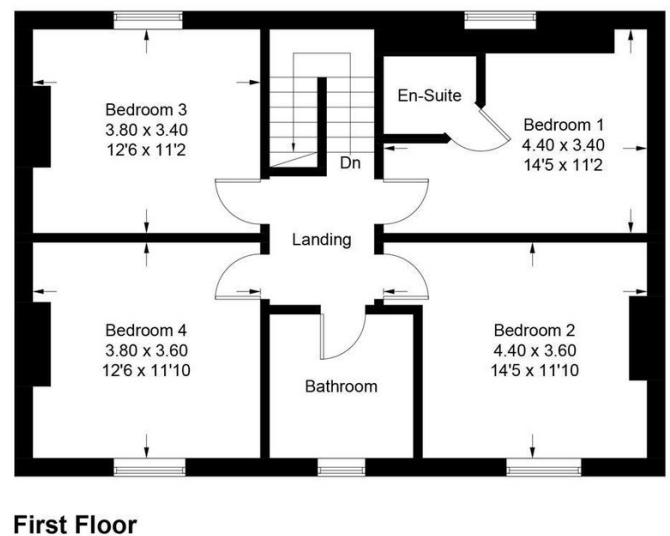
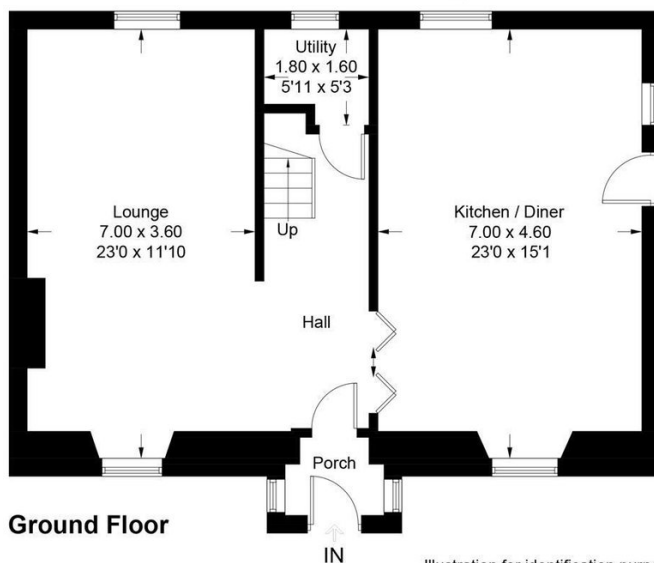

Illustration for identification purposes only, measurements are approximate, not to scale. floorplansUsketch.com © (ID908099)