



Lomond Avenue

Brighton, BN1 8SN

Offers in the region of £550,000



4



2



2





Description

Located in the charming area of Lomond Avenue, Brighton, this delightful four-bedroom house. With its spacious layout, the property boasts four generously sized double bedrooms, ensuring ample space for relaxation and privacy.

The house features two well-appointed bathrooms, providing convenience for busy mornings and accommodating guests with ease. The heart of the home is undoubtedly the inviting living area, which seamlessly connects to the garden through elegant bi-fold doors. This design not only enhances the natural light within the space but also creates a perfect flow for entertaining or enjoying quiet moments in the fresh air.

With no onward chain, this property is ready for immediate occupancy, allowing you to settle in without delay. The vibrant city of Brighton, known for its lively culture, stunning seafront, and excellent amenities, is just a stone's throw away, making this location both convenient and desirable.

In summary, this four-bedroom house on Lomond Avenue is a rare find, combining spacious living, potential for growth, and a prime location. Whether you are looking to move in or invest, this property is sure to impress.

Award
Estate Agents





Avard
Estate Agents



Floor Plan

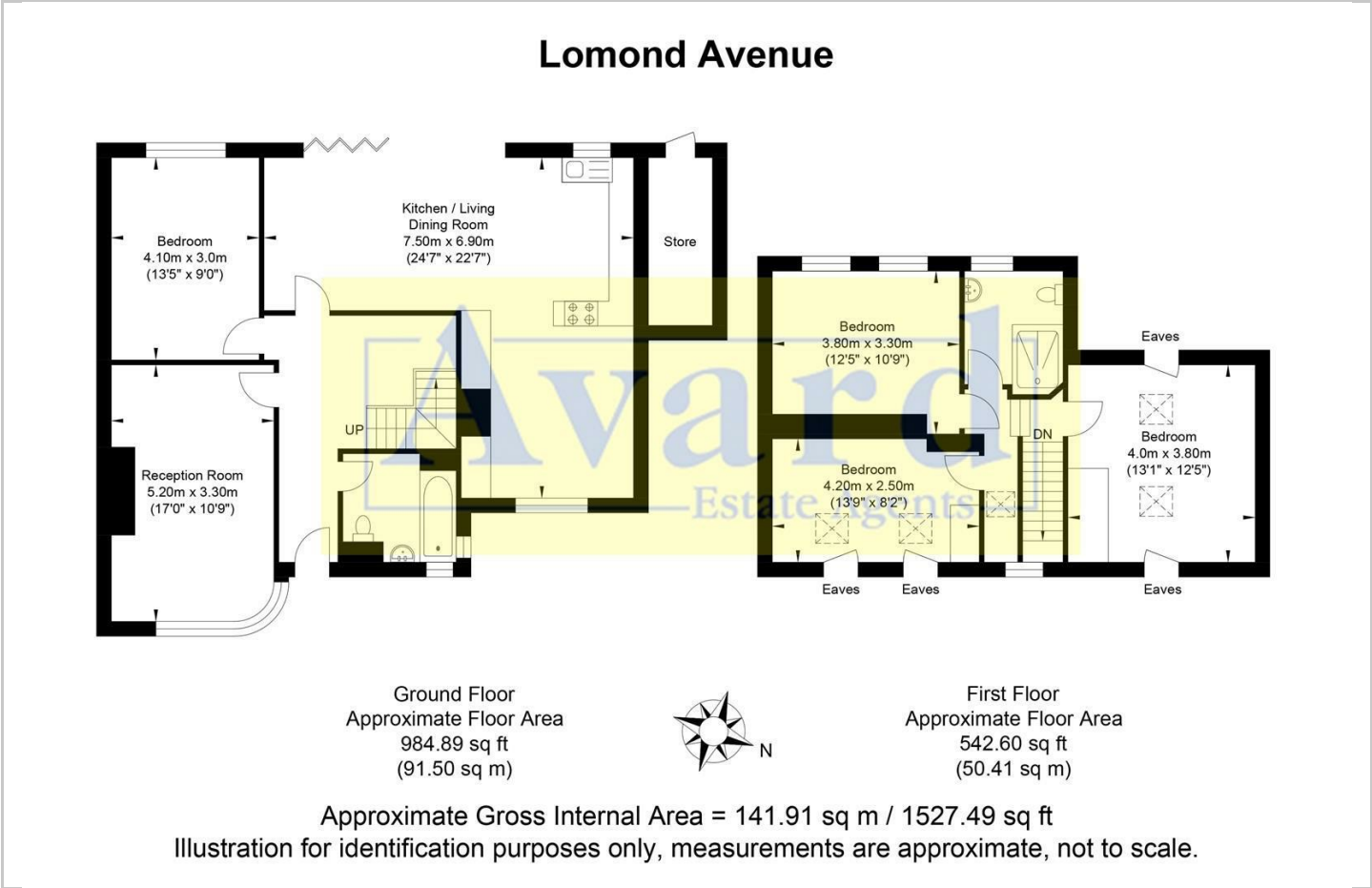

Area Map

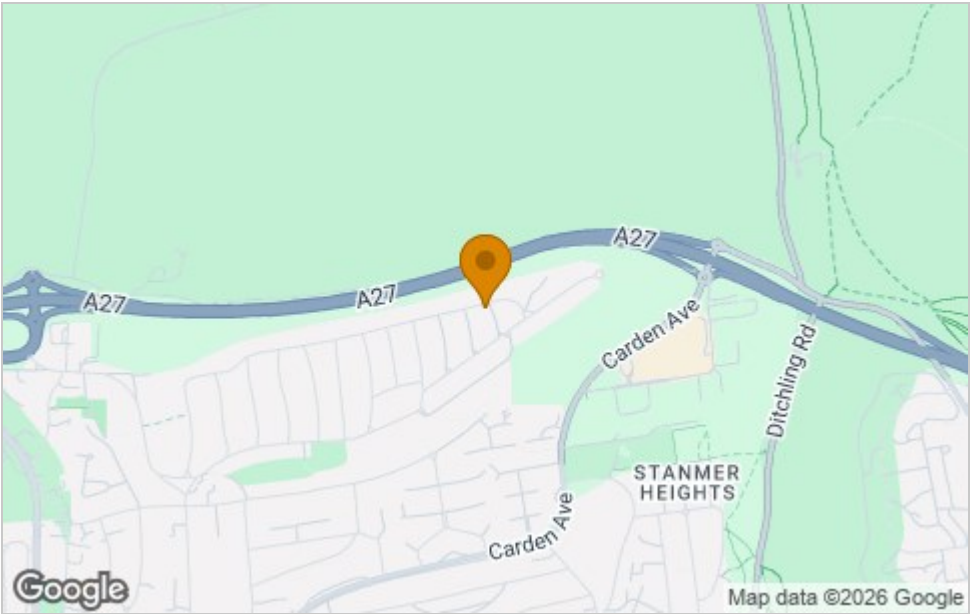

Energy Efficiency Graph

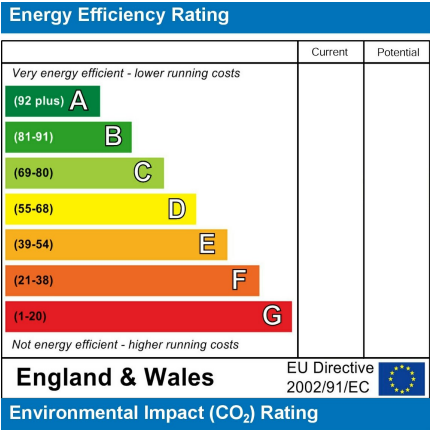

Viewing

Please contact our Avard Estate Agents Office on 01273696000 if you wish to arrange a viewing appointment for this property or require further information.

These particulars, whilst believed to be accurate are set out as a general outline only for guidance and do not constitute any part of an offer or contract. Intending purchasers should not rely on them as statements of representation of fact, but must satisfy themselves by inspection or otherwise as to their accuracy. No person in this firms employment has the authority to make or give any representation or warranty in respect of the property.