



Bowditch Row, Crewkerne TA18 7JH

welcome to

Bowditch Row, Crewkerne

Nestled in Crewkerne, this charming 2 bedroom end-of-terrace cottage is full of character and original features. Inside, the cottage is brimming with charm, offering a warm, inviting atmosphere. Just a short walk from the leisure centre, Waitrose and a range of public transport options.



Lounge

Entering the property, you step into a characterful lounge with original features, including a fireplace and multi-fuel stove, a single-glazed window to the front, and flagstone flooring.

Kitchen

A cozy kitchen with a single-glazed window to the back, partly tiled splashback, top and bottom units, oven, sink, and space/plumbing for a washing machine. There's also a useful storage cupboard under the stairs.

Bedroom One

A good-sized double bedroom with a single-glazed front window, plenty of space for storage, and access to the loft.

Bedroom Two

A single bedroom with a single-glazed window to the back, carpeted, radiator.

Bathroom

A bathroom fitted with a bath, WC, and hand basin. Radiator.

Garden

The enclosed garden enjoys a good degree of privacy with access to the side, and a shed - perfect for gardening or sitting out.

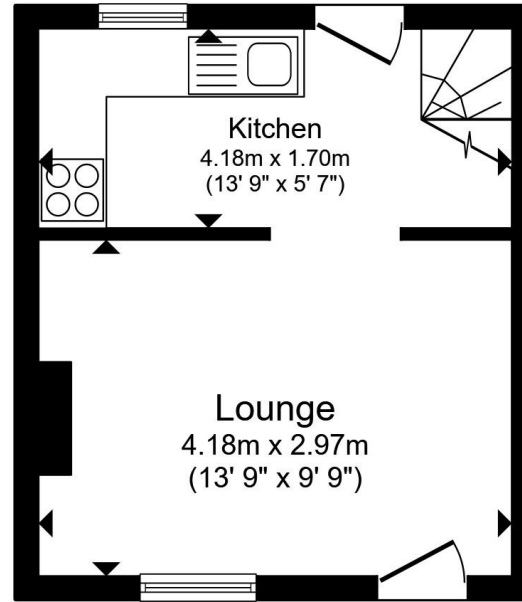

Ground Floor

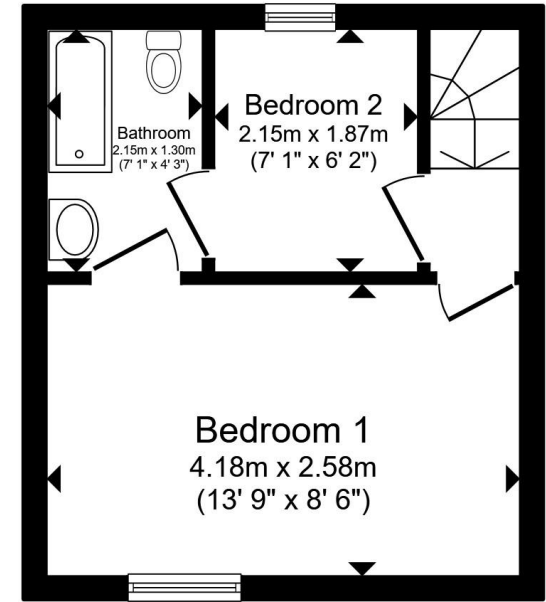

First Floor

Total floor area 40.4 m² (435 sq.ft.) approx

This floor plan is for illustrative purposes only. It is not drawn to scale. Any measurements, floor areas (including any total floor area), openings and orientation are approximate. No details are guaranteed, they cannot be relied upon for any purpose and they do not form part of any agreement. No liability is taken for any error, omission or misstatement. A party must rely upon its own inspection(s). Powered by www.propertybox.io

 fox & sons



view this property online fox-and-sons.co.uk/Property/CRK106597



welcome to

Bowditch Row, Crewkerne

- End of Terrace Cottage
- Two Bedrooms
- Grade II Listed
- Enclosed Garden

Tenure: Freehold EPC Rating: Exempt
Council Tax Band: A

£180,000



Please note the marker reflects the
postcode not the actual property

view this property online fox-and-sons.co.uk/Property/CRK106597



Property Ref:
CRK106597 - 0005

1. MONEY LAUNDERING REGULATIONS Intending purchasers will be asked to produce identification documentation at a later stage and we would ask for your co-operation in order that there is no delay in agreeing the sale. 2. These particulars do not constitute part or all of an offer or contract. 3. The measurements indicated are supplied for guidance only and as such must be considered incorrect. Potential buyers are advised to recheck measurements before committing to any expense. 4. We have not tested any apparatus, equipment, fixtures or services and it is in the buyers interest to check the working condition of any appliances. 5. Where an EPC, or a Home Report (Scotland only) is held for this property, it is available for inspection at the branch by appointment. If you require a printed version of a Home Report, you will need to pay a reasonable production charge reflecting printing and other costs. 6. We are not able to offer an opinion either written or verbal on the content of these reports and this must be obtained from your legal representative. 7. Whilst we take care in preparing these reports, a buyer should ensure that his/her legal representative confirms as soon as possible all matters relating to title including the extent and boundaries of the property and other important matters before exchange of contracts.

Fox & Sons is a trading name of Sequence (UK) Limited which is registered in England and Wales under company number 4268443, Registered Office is Cumbria House, 16-20 Hockliffe Street, Leighton Buzzard, Bedfordshire, LU7 1GN. VAT Registration Number is 500 2481 05.

fox & sons



01460 73421



Crewkerne@fox-and-sons.co.uk



1-3 Market Square, CREWKERNE, Somerset,
TA18 7LE



fox-and-sons.co.uk