

Location:

Key points:

- Share of Freehold with 999 year leases
- 10 year structural warranty
- Early preview for shortlisted registrations before formal launch
- Formal Launch May 2026
- Parking Available to selected units

Do Better:

Acton
sales@astonrowe.co.uk

57-59 Churchfield Road,
Acton, London, W3 6AY

020 8992 3600

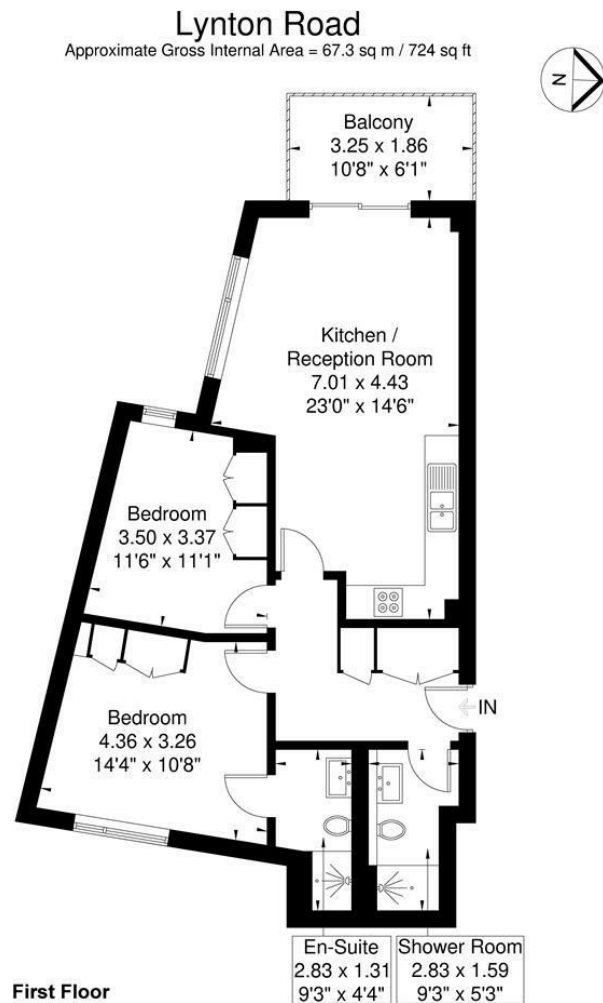

Although every attempt has been made to ensure accuracy, all measurements are approximate. The floorplan is for illustrative purposes only and not to scale.
© www.perspective.co.uk

£690,000

Lynton Road, London W3 9HP

Energy Efficiency Rating		Environmental Impact (CO ₂) Rating	
Current	Potential	Current	Potential

England & Wales EU Directive 2002/91/EC

- 1 Reception Rooms
- 2 Bedrooms
- 2 Bathrooms

The current owner says:



COMING SOON. REGISTER EARLY FOR EXCLUSIVE EARLY ACCESS BEFORE FORMAL LAUNCH- to this exciting new development on Lynton Road, a few minutes walk from Acton Mainline for the Elizabeth Line.

A contemporary, collection of just nine 1, 2 and 3 bedroom apartments, offering duplex apartments, high specification finishes by a leading local developer, and with private outside space and parking to selected units, we are now taking registrations for a pre-launch for just a handful of selected applicants before a formal Launch in May 2026, so register early for access and further details.

Prices start from £525,000. Please register for a brochure and further information with our New Homes Team

What's better: