

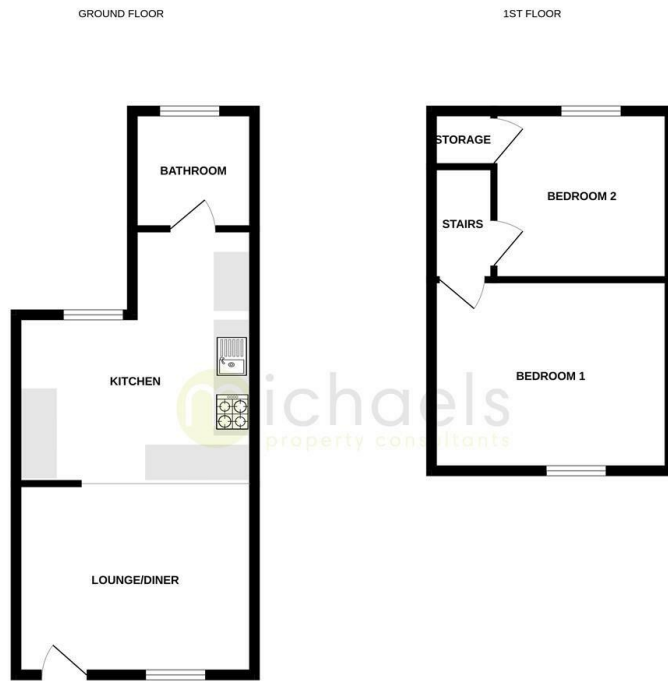

38 Hythe Hill, Colchester, CO1 2NQ

£1,100 Per Month

- Recently Refurbished
- Contemporary Family Bathroom With Bath And Overhead Shower
- Walking Distance To Hythe Station With Direct Links To London Liverpool Street
- Spacious Open-Plan Living And Dining Area
- Large Private Garden
- Available From July
- Modern Fitted Kitchen With Breakfast Bar
- Close To Colchester City Centre And Local Amenities



Whilst every attempt has been made to ensure the accuracy of the floorplan contained herein, measurements of doors, windows, rooms and any other items are approximate and no responsibility is taken for any errors, omissions or mis-statements. This plan is for guidance purposes only and should be used in conjunction with any prospective purchase. The services, systems and appliances shown have not been tested and no guarantee as to their operability or efficiency can be given. Made with Metropix (2025)

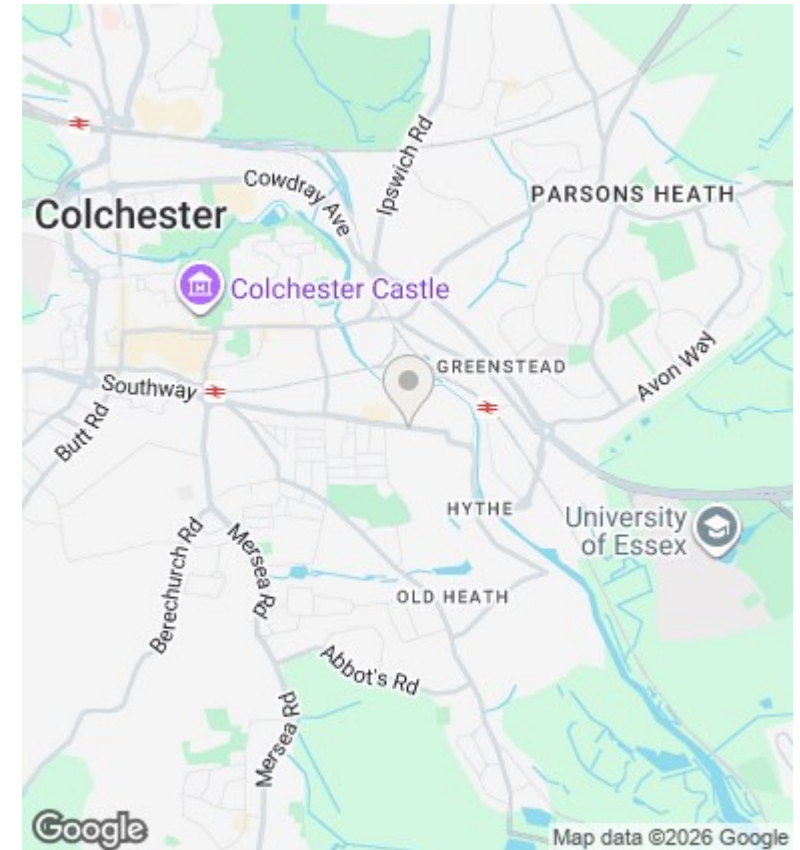

Directions

Viewings

Viewings by arrangement only. Call 01206 572555 to make an appointment.

Council Tax Band

B

EPC Rating:

Energy Efficiency Rating		
	Current	Potential
<i>Very energy efficient - lower running costs</i>		
(92 plus) A		
(81-91) B		
(69-80) C		
(55-68) D		
(39-54) E		
(21-38) F		
(1-20) G		
<i>Not energy efficient - higher running costs</i>		
England & Wales	EU Directive 2002/91/EC	