

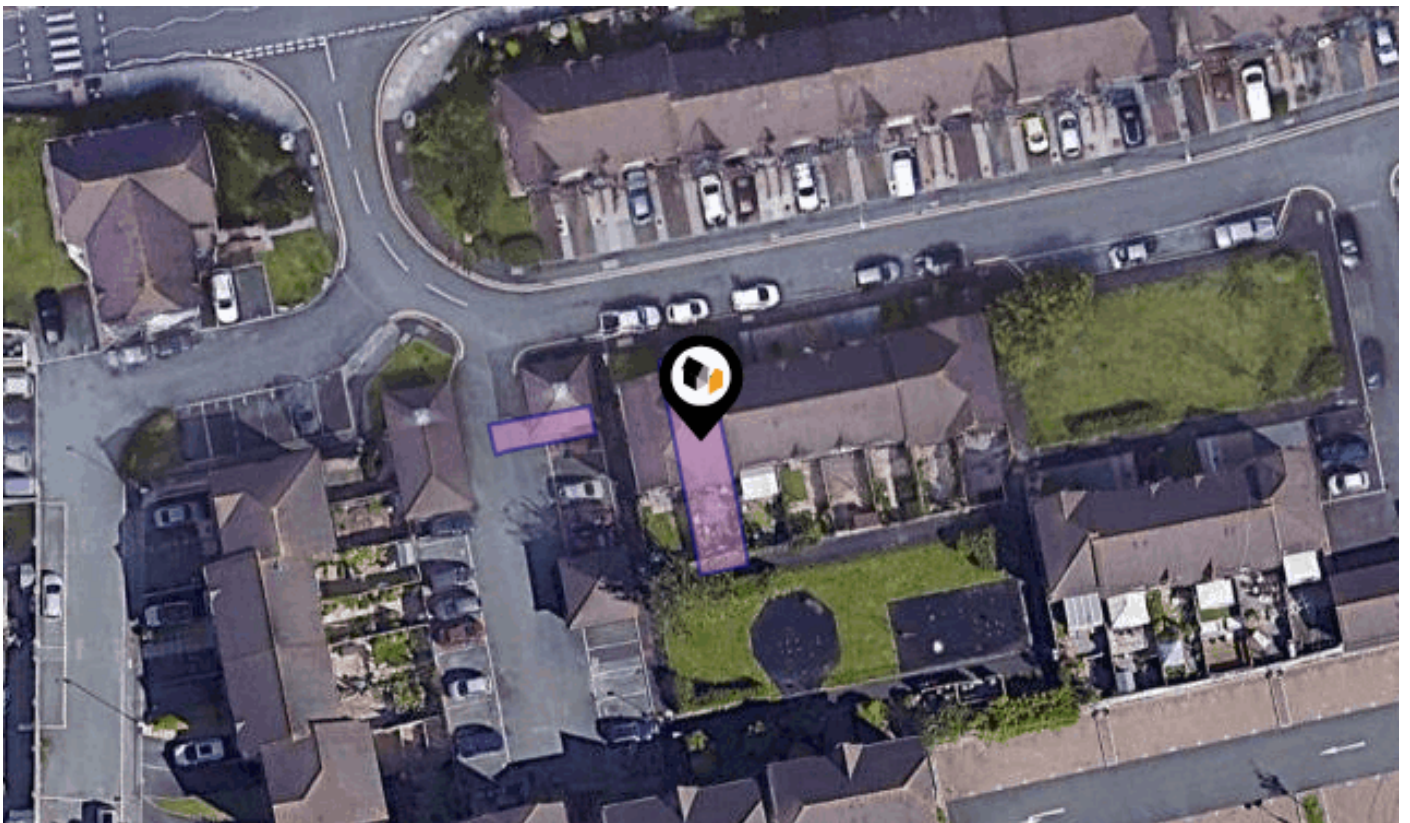

See More Online

KFB: Key Facts For Buyers

A Guide to This Property & the Local Area
Monday 15th June 2026



78, WHITE FRIARS LANE, ST. JUDES, PLYMOUTH, PL4 9RB

Lang Town & Country

6 Mannamead Road, Plymouth, PL4 7AA

01752 456000

carrie@langtownandcountry.com

www.langtownandcountry.com



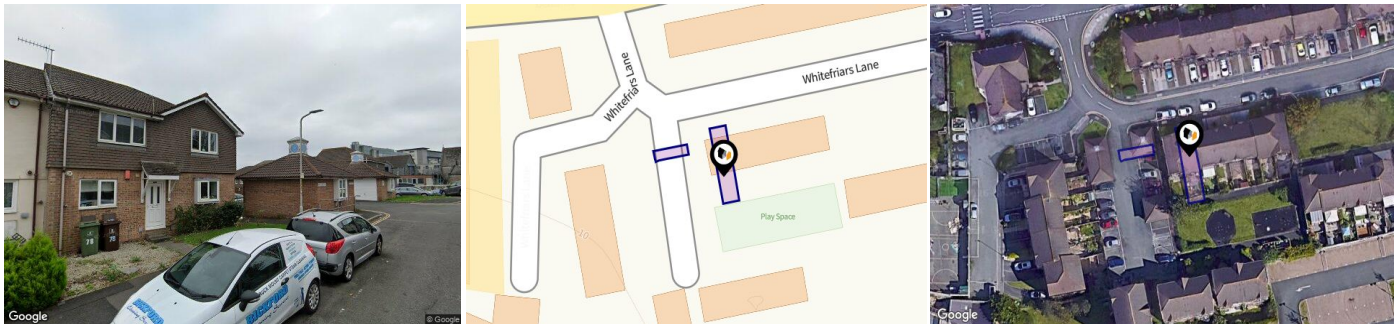



Property

Type:	Terraced	Tenure:	Freehold
Bedrooms:	3		
Floor Area:	678 ft ² / 63 m ²		
Plot Area:	0.03 acres		
Year Built :	1983-1990		
Council Tax :	Band C		
Annual Estimate:	£2,171		
Title Number:	DN327202		
UPRN:	100040503831		
Restrictive Covenants:	Yes		

Local Area

Local Authority:	City of plymouth
Conservation Area:	No
Flood Risk:	
• Rivers & Seas	Very low
• Surface Water	Low

Estimated Broadband Speeds (Standard - Superfast - Ultrafast)

16 mb/s	80 mb/s	1800 mb/s
		

Mobile Coverage: (based on calls indoors)



Satellite/Fibre TV Availability:



78, WHITE FRIARS LANE, ST. JUDES, PLYMOUTH, PL4 9RB

First Floor

Approx. 31.3 sq. metres (336.8 sq. feet)

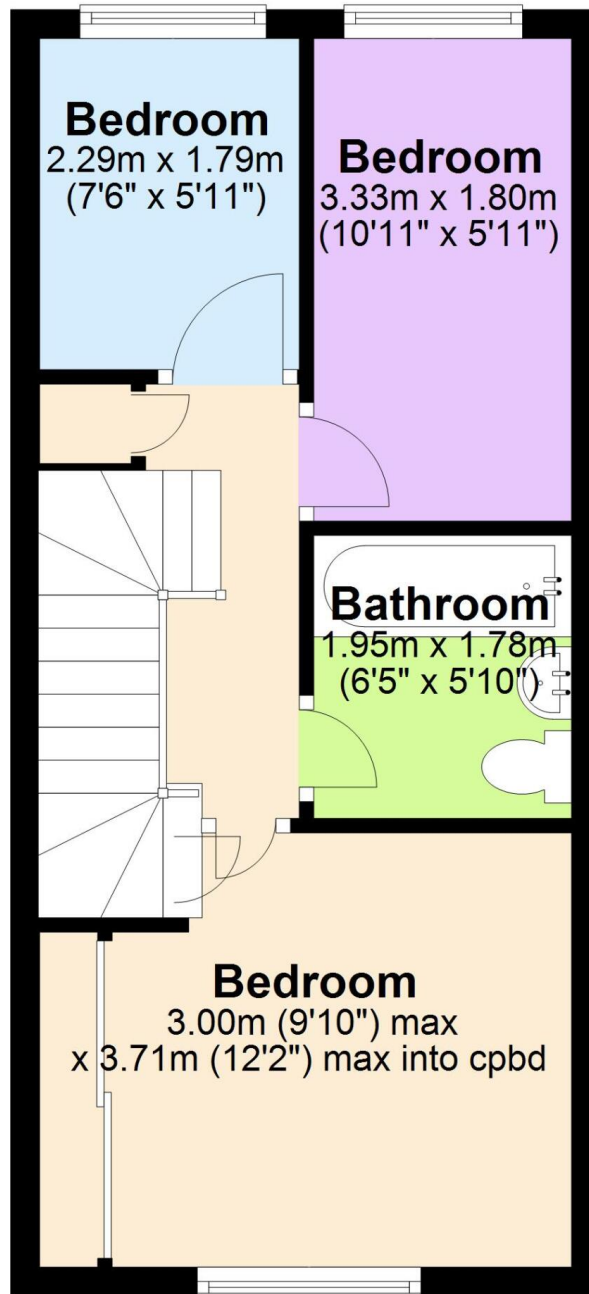

78, WHITE FRIARS LANE, ST. JUDES, PLYMOUTH, PL4 9RB

Ground Floor

Approx. 31.2 sq. metres (336.2 sq. feet)

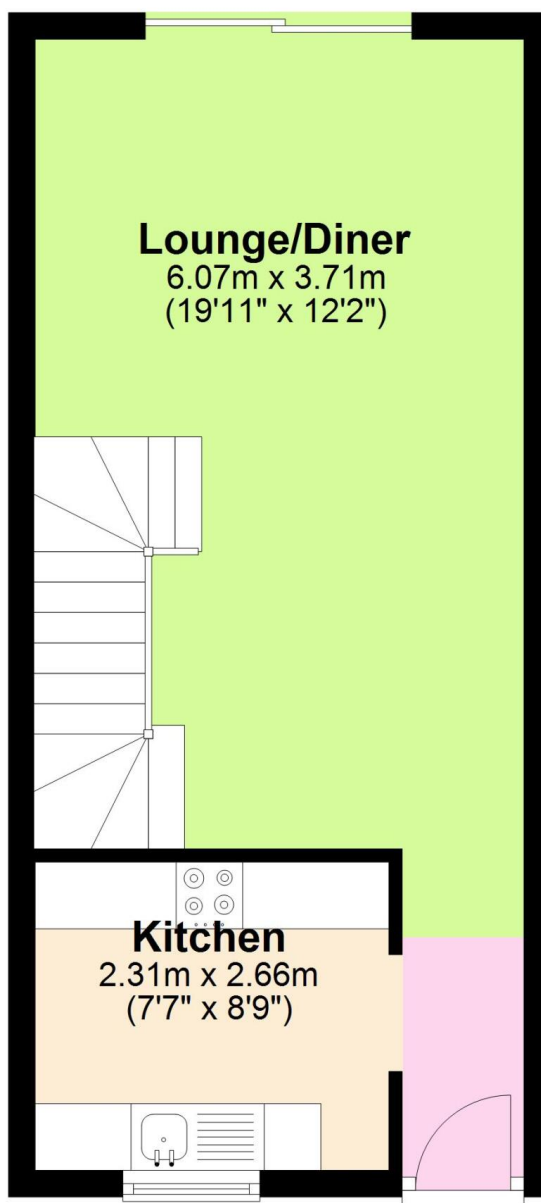

Total area: approx. 62.5 sq. metres (673.0 sq. feet)

78, WHITE FRIARS LANE, ST. JUDES, PLYMOUTH, PL4 9RB

Ground Floor

Approx. 31.2 sq. metres (336.2 sq. feet)

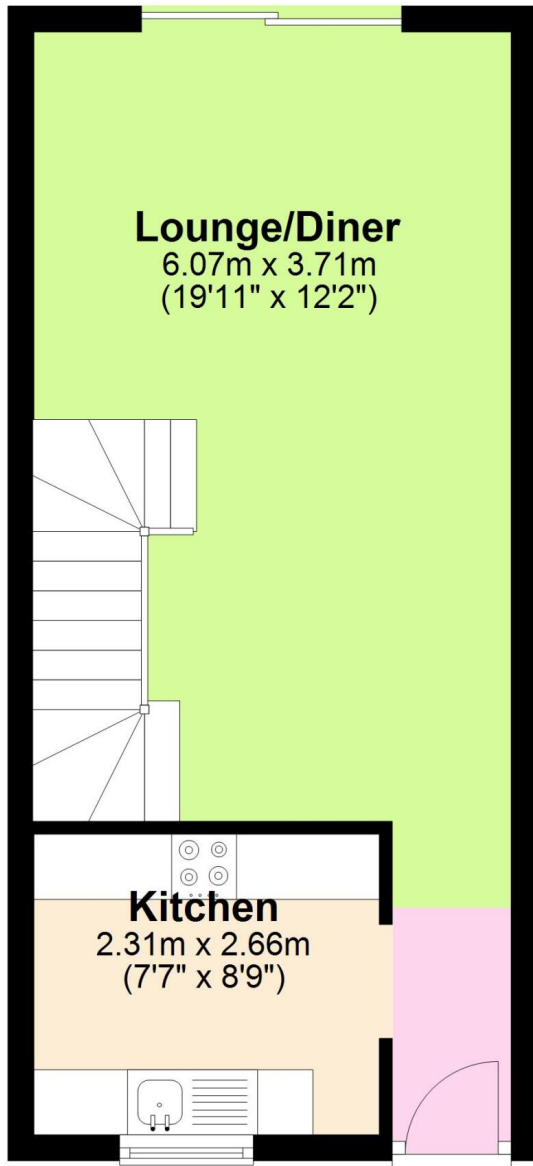

First Floor

Approx. 31.3 sq. metres (336.8 sq. feet)

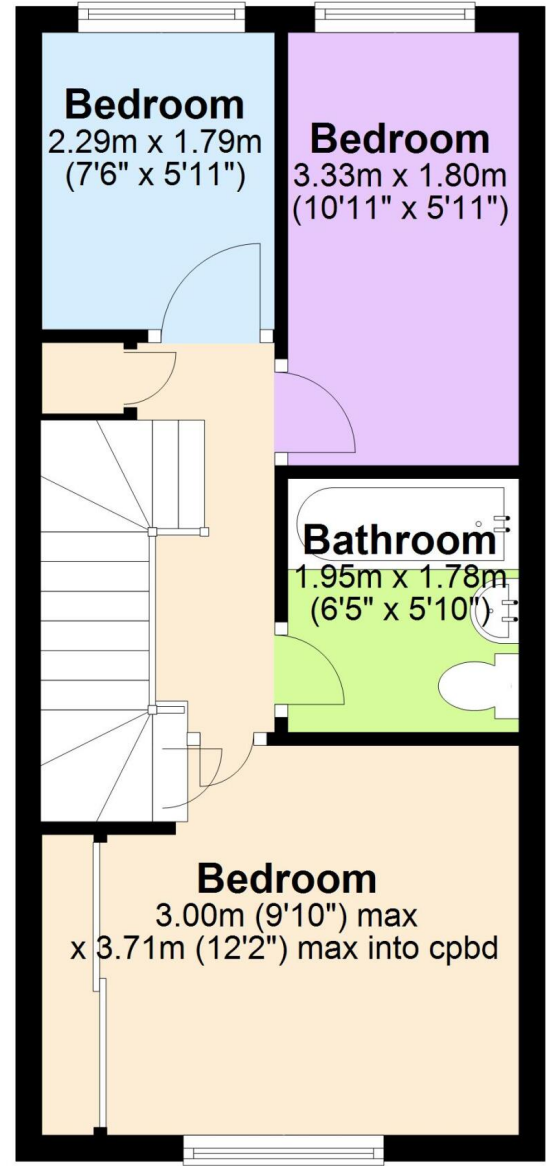

Total area: approx. 62.5 sq. metres (673.0 sq. feet)

78, White Friars Lane, St. Judes, PL4 9RB

Energy rating

D

Valid until 07.11.2026

Score	Energy rating	Current	Potential
92+	A		
81-91	B		87 B
69-80	C		
55-68	D	67 D	
39-54	E		
21-38	F		
1-20	G		

Additional EPC Data

Property Type:	House
Build Form:	Mid-Terrace
Transaction Type:	Rental (private)
Energy Tariff:	Single
Main Fuel:	Mains gas (not community)
Main Gas:	Yes
Glazing Type:	Double glazing, unknown install date
Previous Extension:	0
Open Fireplace:	0
Ventilation:	Natural
Walls:	Cavity wall, as built, insulated (assumed)
Walls Energy:	Good
Roof:	Pitched, 75 mm loft insulation
Roof Energy:	Average
Main Heating:	Boiler and radiators, mains gas
Main Heating Controls:	Programmer, TRVs and bypass
Hot Water System:	From main system
Hot Water Energy Efficiency:	Good
Lighting:	Low energy lighting in 67% of fixed outlets
Floors:	Suspended, no insulation (assumed)
Total Floor Area:	63 m ²

This map displays nearby coal mine entrances and their classifications.

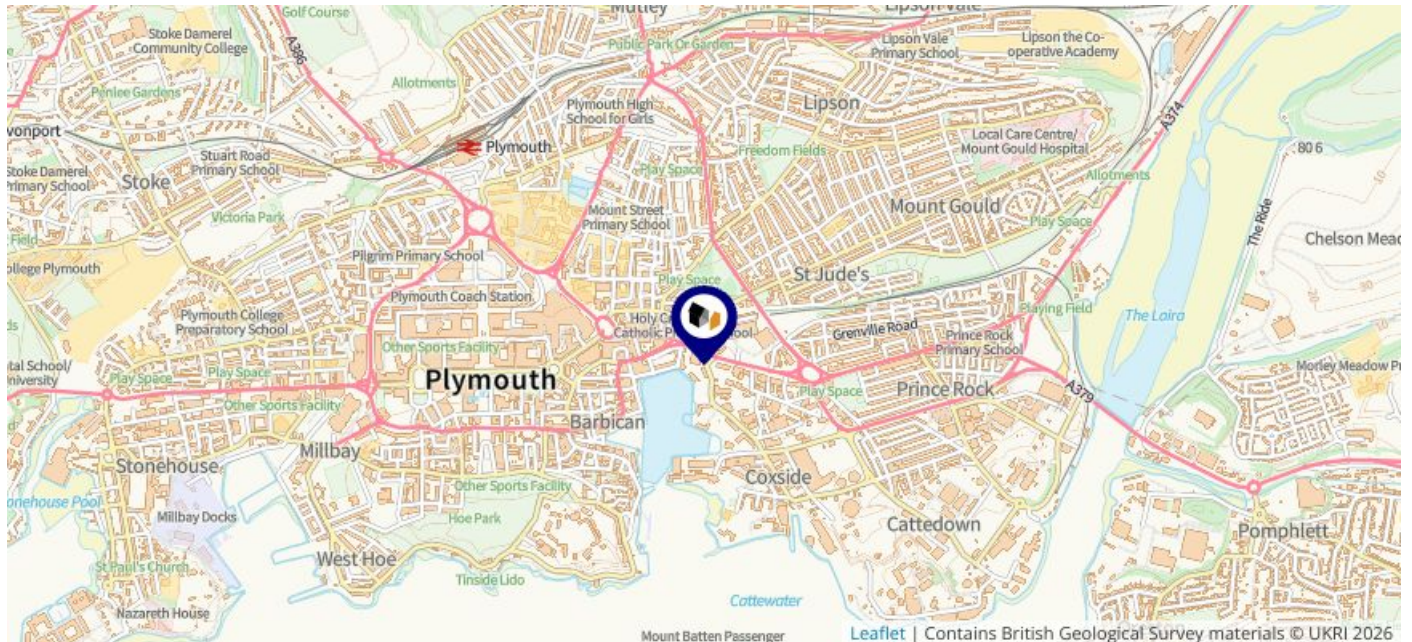

Mine Entry

- ✕ Adit
- ✕ Gutter Pit
- ✕ Shaft

The Coal Authority has records of over 175,000 mine entries within the UK captured in the National Coal Mining database, derived from sources including abandonment plans, geological and topographical plans.

Coal mining activity is recorded as far back as the 13th century, but prior to 1872 there was no requirement to deposit abandonment plans. It is therefore believed there may be many unrecorded mine entries of which the Authority has no information or knowledge. These entries do not, therefore, appear within the Authority's national dataset as shown on this map.

Maps

Conservation Areas

This map displays nearby official conservation areas. Every local authority in England has at least one conservation area. Most are designated by the Council as the local planning authority, though Historic England and the Secretary of State also have the power to create them.

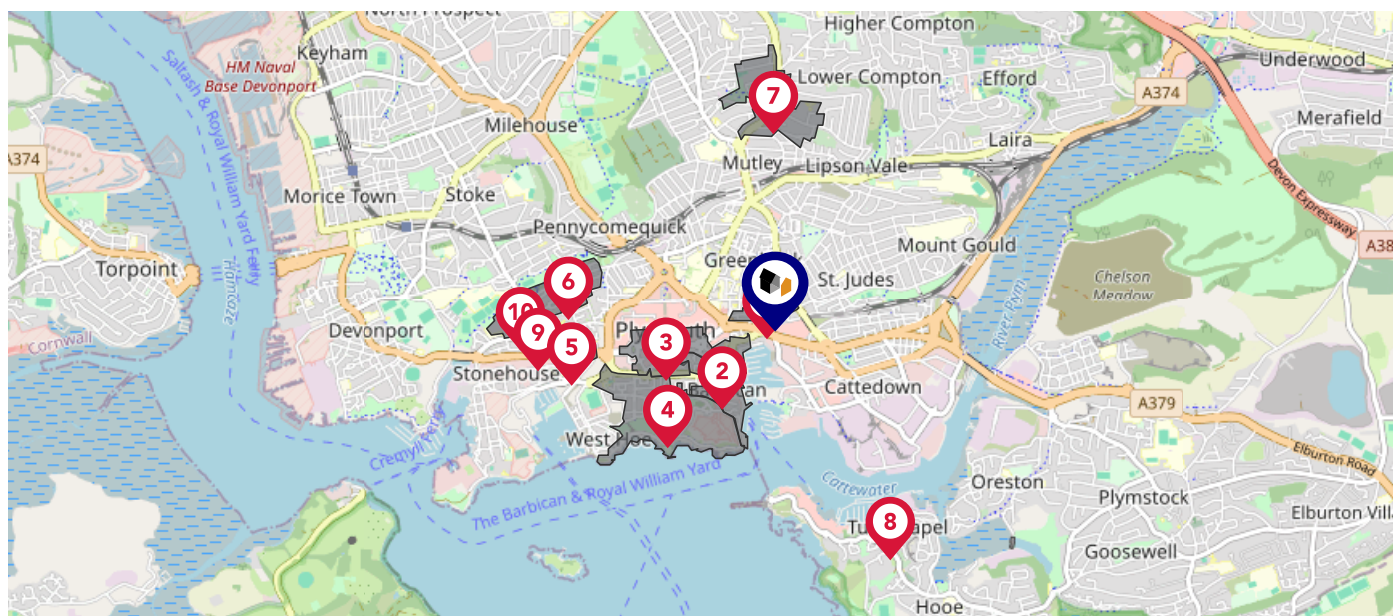

Nearby Conservation Areas

- 1 Ebrington Street
- 2 Barbican
- 3 City Centre
- 4 The Hoe
- 5 Union Street
- 6 North Stonehouse
- 7 Mannamead
- 8 Turnchapel
- 9 Adelaide Street/Clarence Place
- 10 Royal Naval Hospital







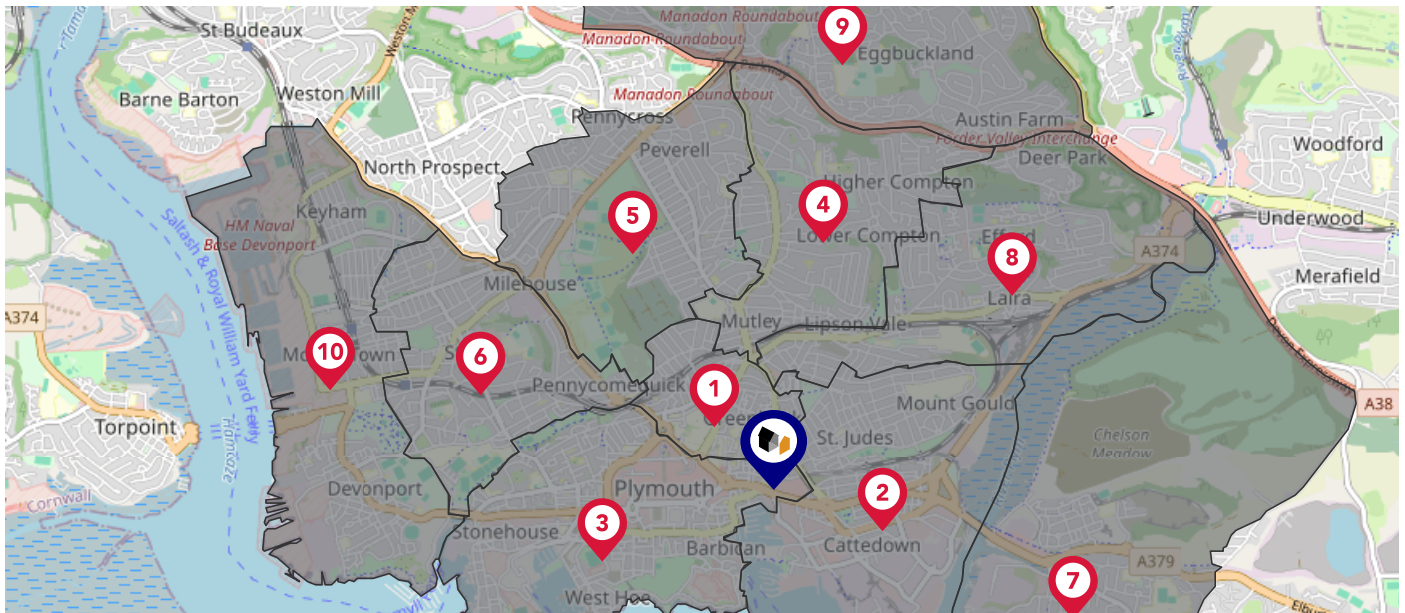



Maps

Council Wards

The UK is divided into wards that are used for local elections to elect local government councillors. Sometimes these are known as 'electoral divisions'. Population counts can vary substantially between wards, but the national average is about 5,500



Nearby Council Wards

-  Drake Ward
-  Sutton and Mount Gould Ward
-  St. Peter and the Waterfront Ward
-  Compton Ward
-  Peverell Ward
-  Stoke Ward
-  Plymstock Radford Ward
-  Efford and Lipson Ward
-  Egguckland Ward
-  Devonport Ward

This map displays the noise levels from nearby network rail and HS1 railway routes that affect this property...

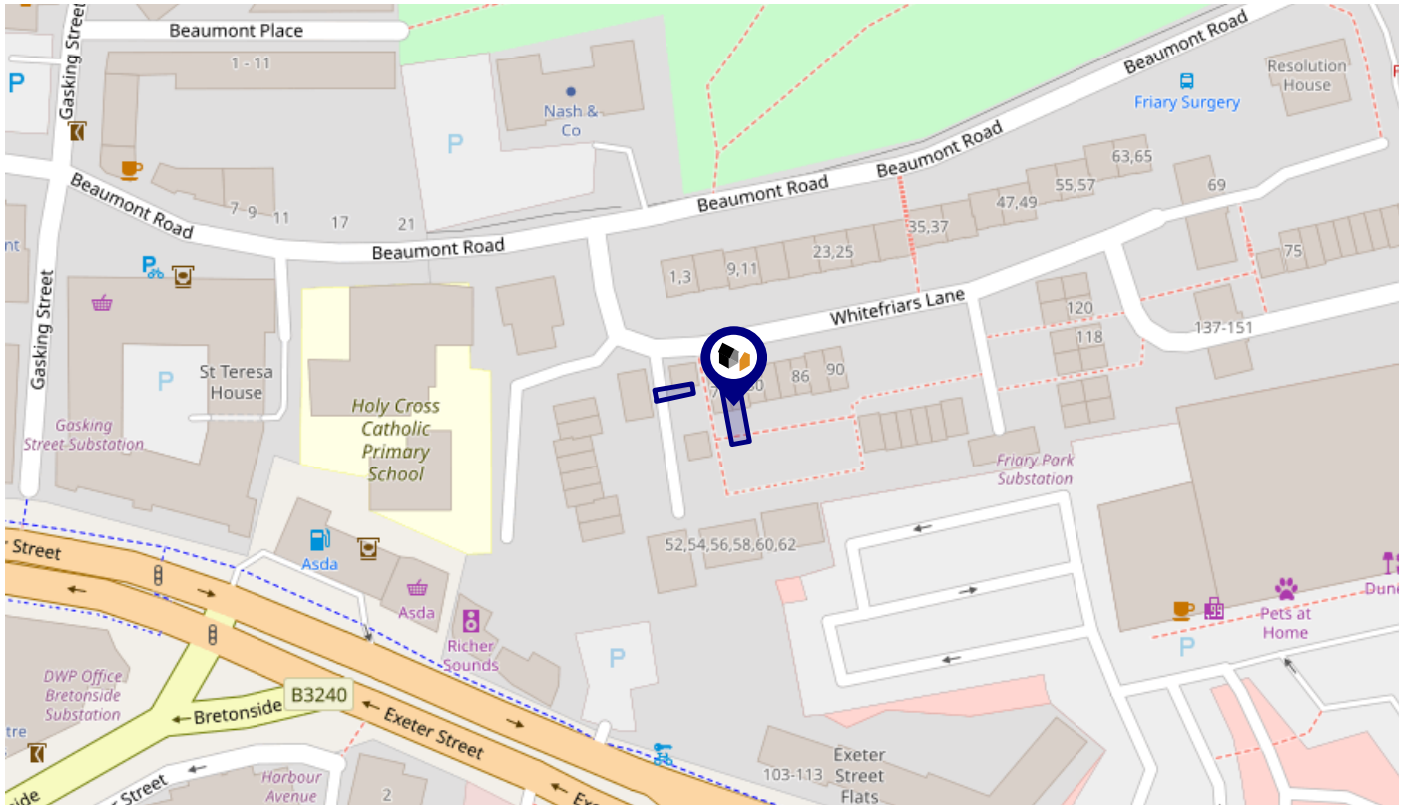

Rail Noise Data

This data indicates the level of noise according to the strategic noise mapping of rail sources within areas with a population of at least 100,000 people (agglomerations) and along Network Rail and HS1 traffic routes.

The data indicates the annual average noise levels for the 16-hour period between 0700 - 2300.

Noise levels are modelled on a 10m grid at a receptor height of 4m above ground, polygons are then produced by merging neighbouring cells within the following noise classes:

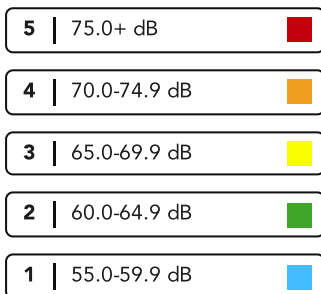

Flood Risk

Rivers & Seas - Flood Risk

This map shows the chance of flooding from rivers and / or the sea, taking into account flood defences and their condition.

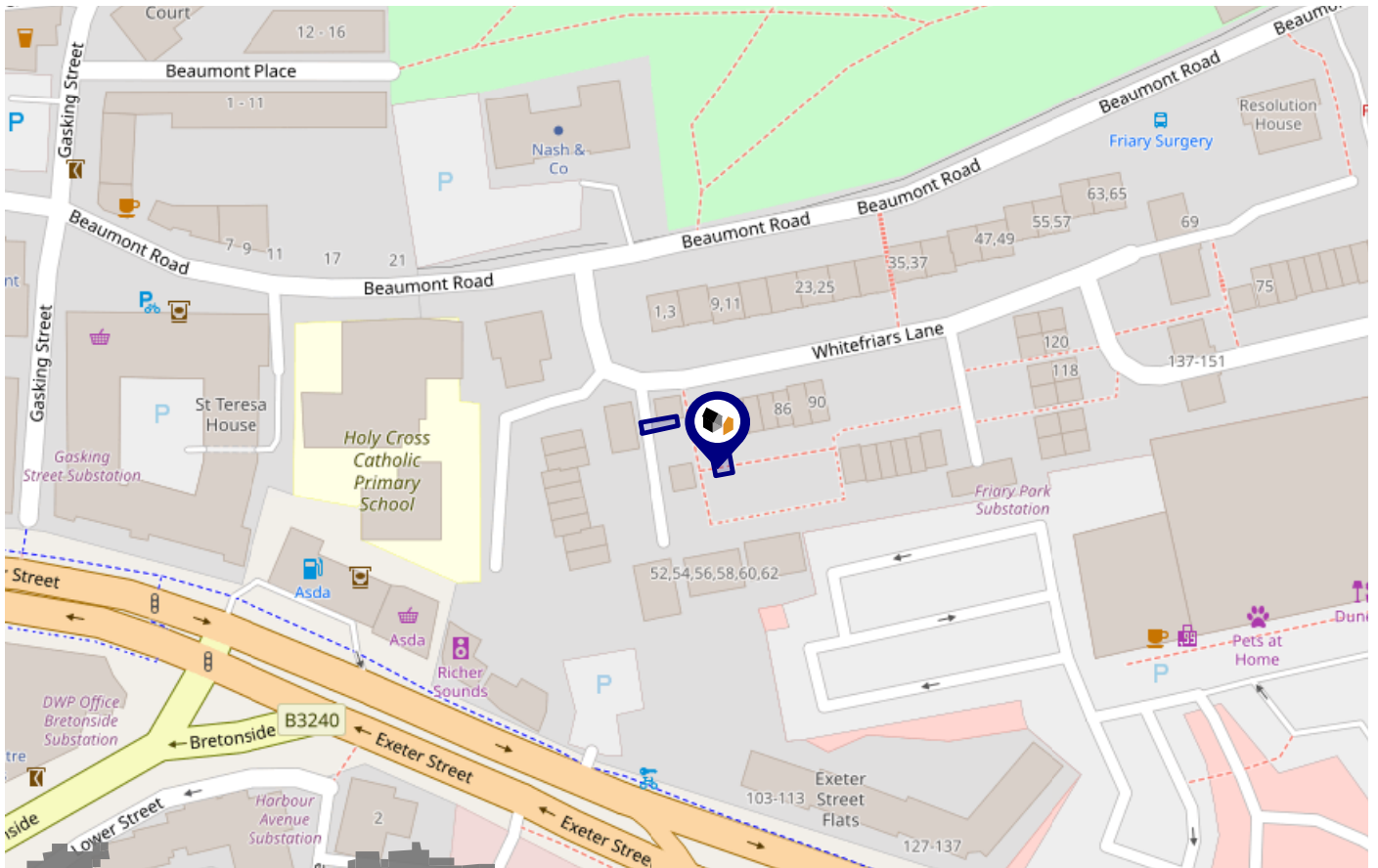

Risk Rating: Very low

The map does not contain sufficient information for it to be used to determine flood risk to individual properties, but it does give you an indication of whether your area may be affected by surface water flooding at this risk level.

- High Risk** - an area which has a chance of flooding of greater than 1 in 30 (3.3%) in any one year.
- Medium Risk** - an area which has a chance of flooding of greater than 1 in 100 (1.0%) in any one year.
- Low Risk** - an area which has a chance of flooding of greater than 1 in 1000 (0.1%) in any one year.
- Very Low Risk** - an area in which the risk is below 1 in 1000 (0.1%) in any one year.

Chance of flooding to the following depths at this property:



Flood Risk

Rivers & Seas - Climate Change

This map shows the future chance of flooding from rivers and / or the sea **between 2036 and 2069**, taking into account flood defences and their condition. The government climate change models cannot predict exactly when the chance of flooding will go up. It could happen at any time during the time period.

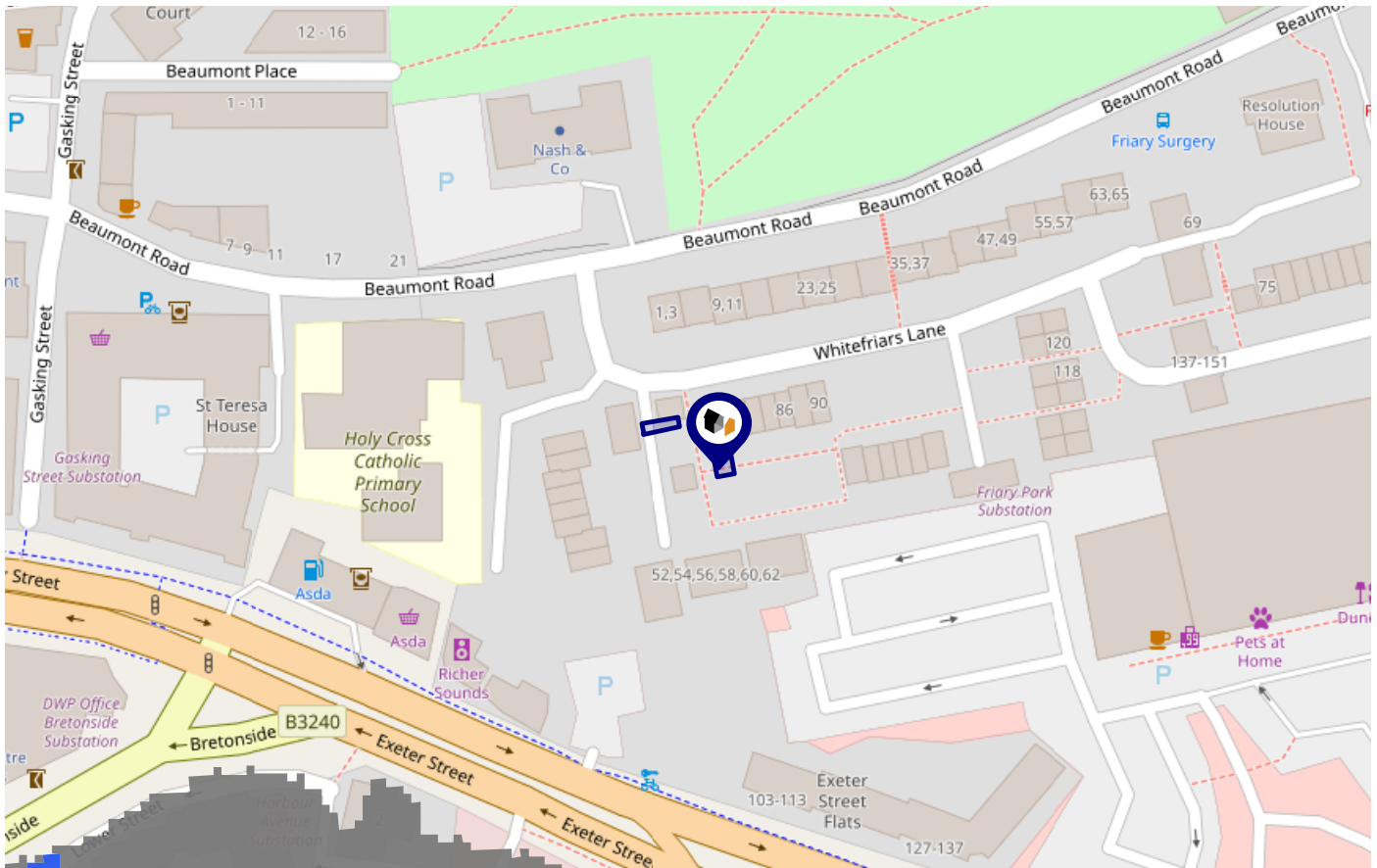

Risk Rating: Very low

The map does not contain sufficient information for it to be used to determine flood risk to individual properties, but it does give you an indication of whether your area may be affected by surface water flooding at this risk level.

- High Risk** - an area which has a chance of flooding of greater than 1 in 30 (3.3%) in any one year.
- Medium Risk** - an area which has a chance of flooding of greater than 1 in 100 (1.0%) in any one year.
- Low Risk** - an area which has a chance of flooding of greater than 1 in 1000 (0.1%) in any one year.
- Very Low Risk** - an area in which the risk is below 1 in 1000 (0.1%) in any one year.

Chance of flooding to the following depths at this property:



Flood Risk

Surface Water - Flood Risk

This map shows the chance of flooding where rainwater has nowhere to drain. This kind of flooding can occur far from rivers or seas.

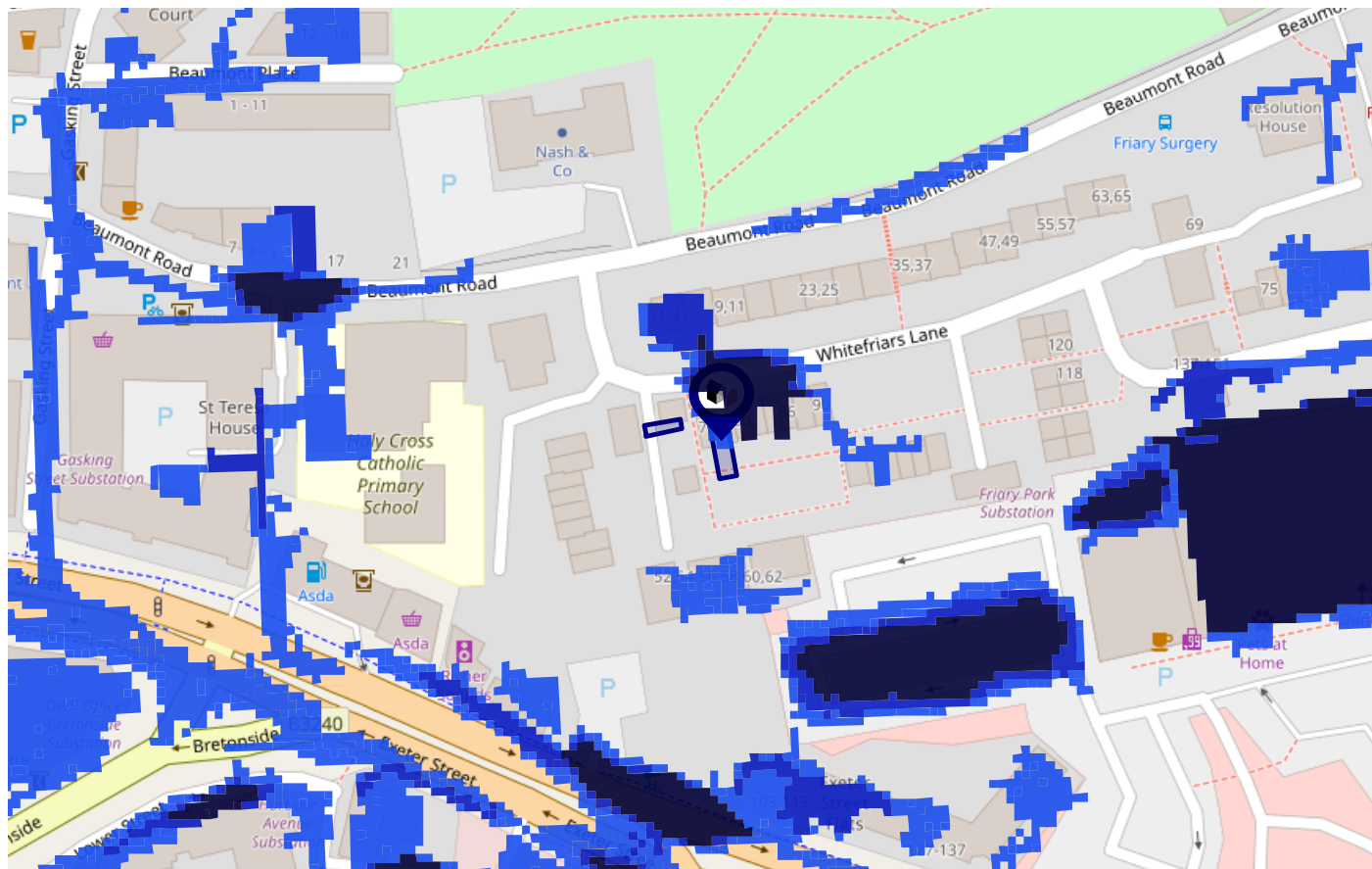

Risk Rating: Low

The map does not contain sufficient information for it to be used to determine flood risk to individual properties, but it does give you an indication of whether your area may be affected by surface water flooding at this risk level.

- High Risk** - an area which has a chance of flooding of greater than 1 in 30 (3.3%) in any one year.
- Medium Risk** - an area which has a chance of flooding of greater than 1 in 100 (1.0%) in any one year.
- Low Risk** - an area which has a chance of flooding of greater than 1 in 1000 (0.1%) in any one year.
- Very Low Risk** - an area in which the risk is below 1 in 1000 (0.1%) in any one year.

Chance of flooding to the following depths at this property:

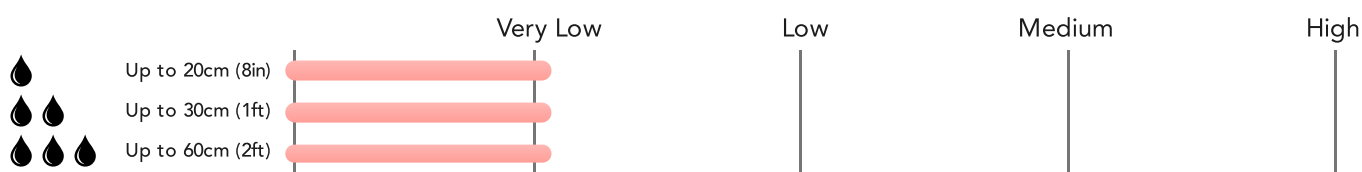

Flood Risk

Surface Water - Climate Change



This map shows the future chance of flooding **between 2040 and 2060** where rainwater has nowhere to drain. This kind of flooding can occur far from rivers or seas. The government climate change models cannot predict exactly when the chance of flooding will go up. It could happen at any time during the time period.

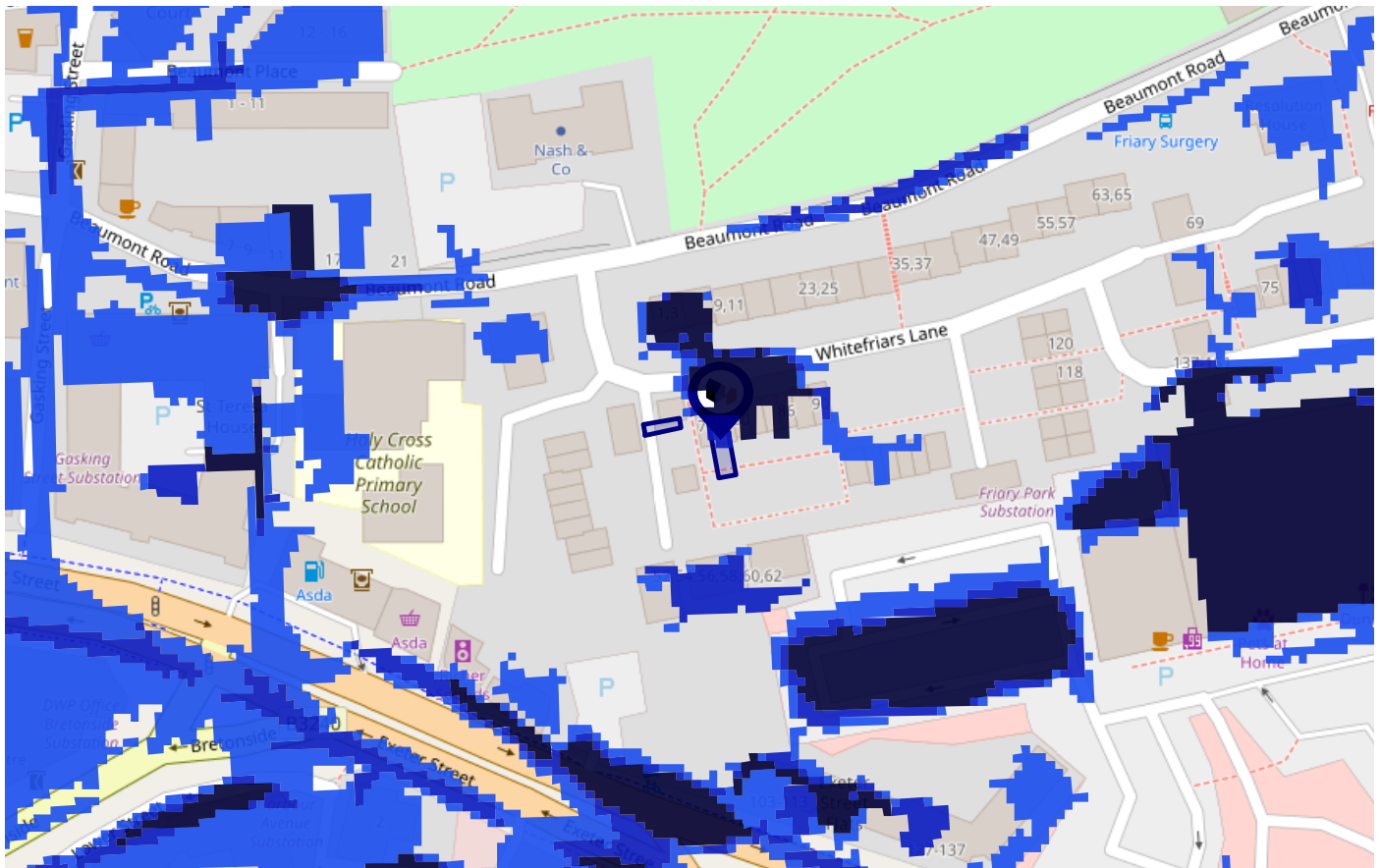

Risk Rating: Medium

The map does not contain sufficient information for it to be used to determine flood risk to individual properties, but it does give you an indication of whether your area may be affected by surface water flooding at this risk level.

- High Risk** - an area which has a chance of flooding of greater than 1 in 30 (3.3%) in any one year.
- Medium Risk** - an area which has a chance of flooding of greater than 1 in 100 (1.0%) in any one year.
- Low Risk** - an area which has a chance of flooding of greater than 1 in 1000 (0.1%) in any one year.
- Very Low Risk** - an area in which the risk is below 1 in 1000 (0.1%) in any one year.

Chance of flooding to the following depths at this property:



This map displays nearby areas that have been designated as Green Belt...

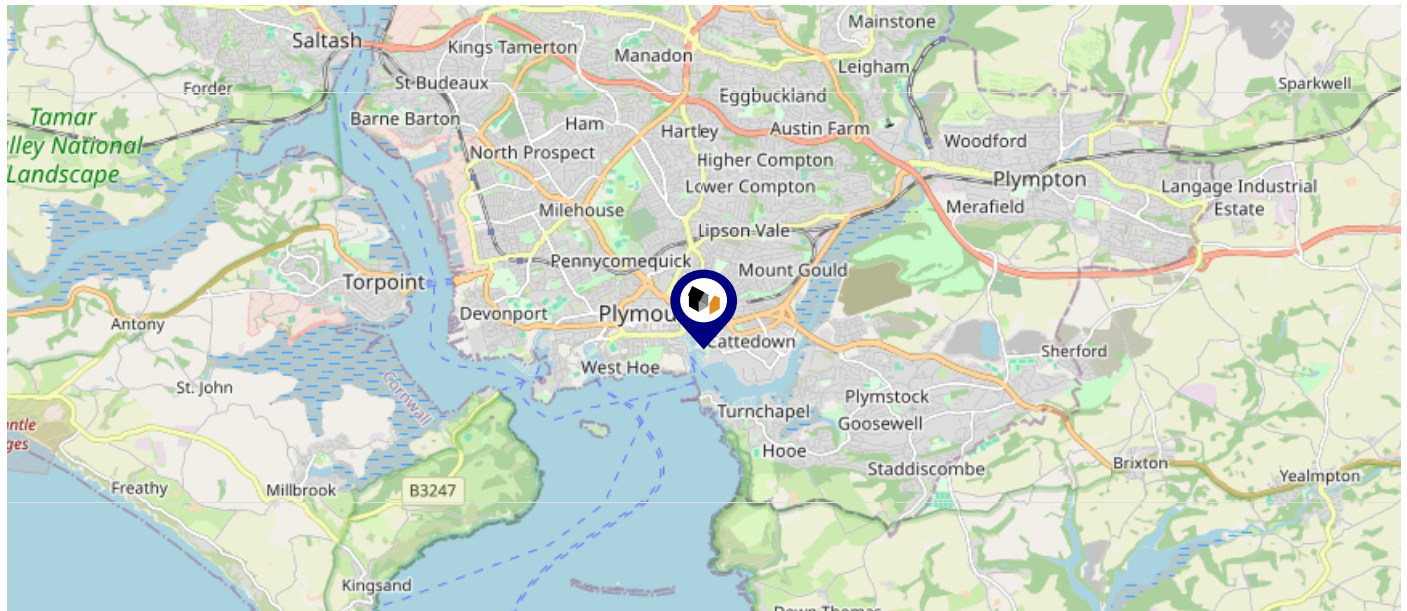

Nearby Green Belt Land

No data available.

This map displays the location of known landfill sites. Historic sites are where there is no environmental permit in force. Active sites are currently authorised by the Environment Agency under Environmental Permitting Regulations.

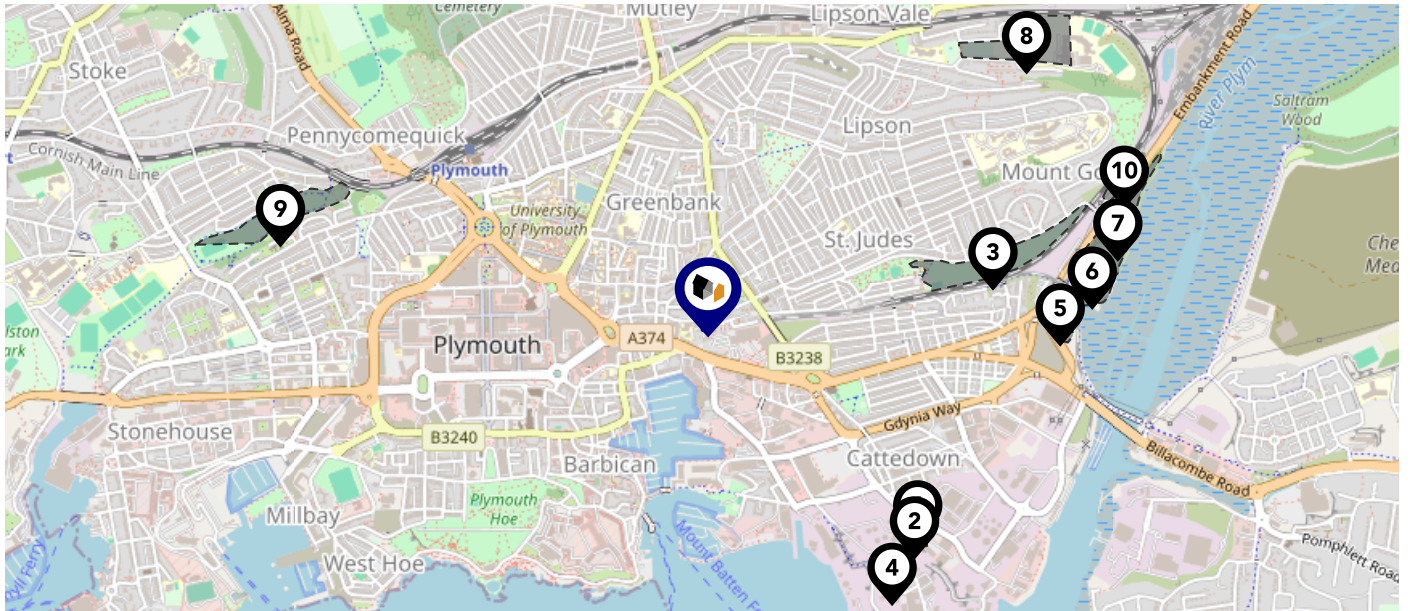

Nearby Landfill Sites

1	MacAdam Road-Cattedown, Plymouth	Historic Landfill	<input type="checkbox"/>
2	Cattedown Road-Cattedown, Plymouth	Historic Landfill	<input type="checkbox"/>
3	Tothill Park Recreation Ground-Tothill Park Recreation Ground Mount Gold/Laira, Plymouth	Historic Landfill	<input type="checkbox"/>
4	Sevenside Waste Paper-Wallsend Industrial Estate, Cattedown, Plymouth, Devon	Historic Landfill	<input type="checkbox"/>
5	Cattedown Junction Playing Field-Embankment Road, Plymouth	Historic Landfill	<input type="checkbox"/>
6	Blagdons Shipyard-Embankment Road Lane, Laira, Plymouth	Historic Landfill	<input type="checkbox"/>
7	Embankment Road-Laira, Plymouth	Historic Landfill	<input type="checkbox"/>
8	Laira Lipson College-Laira, Plymouth	Historic Landfill	<input type="checkbox"/>
9	Victoria Park-Victoria Park, Plymouth	Historic Landfill	<input type="checkbox"/>
10	Allotments Embankment Road-Laira, Plymouth	Historic Landfill	<input type="checkbox"/>

Maps

Listed Buildings



This map displays nearby listed buildings and protected structures, as well as their listed tier and distance from the target property...

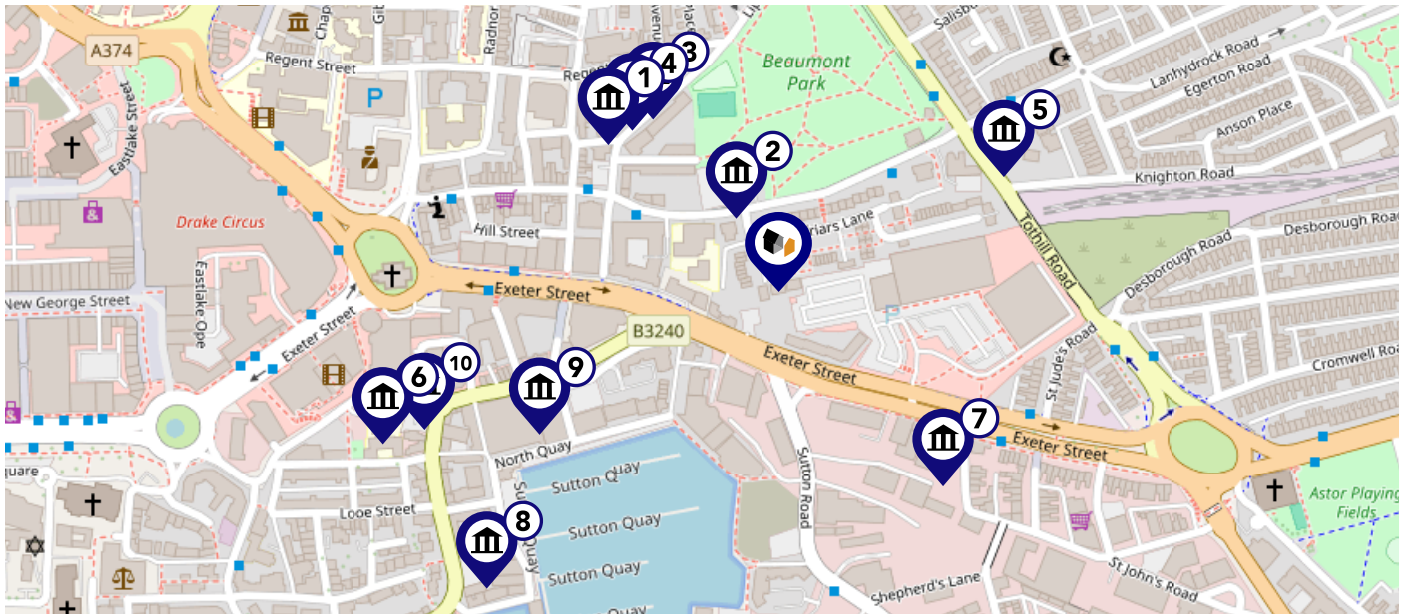



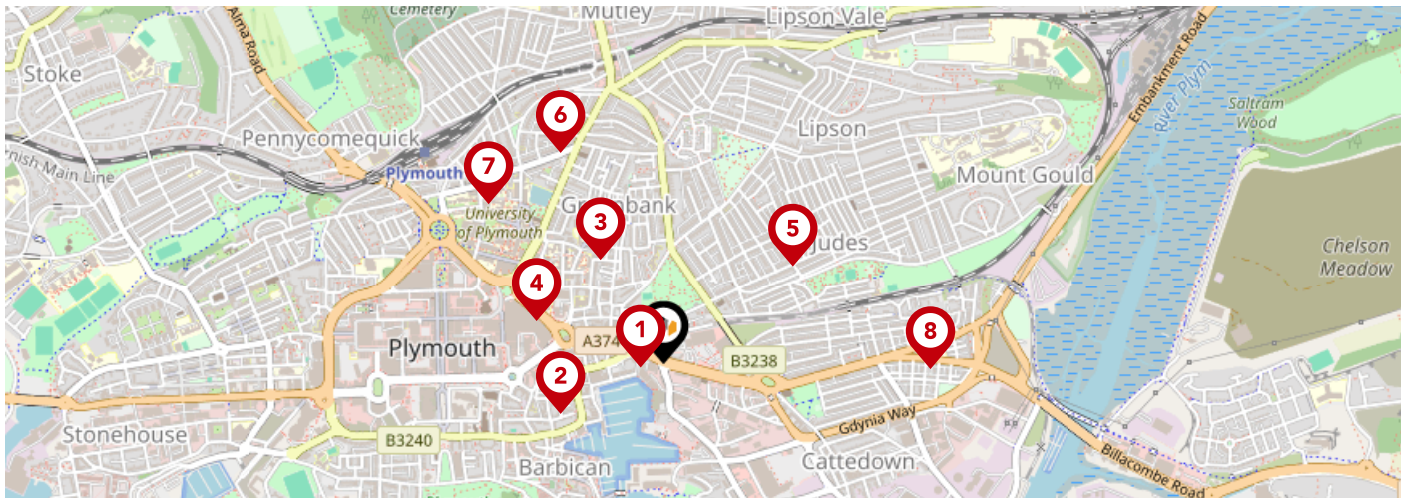



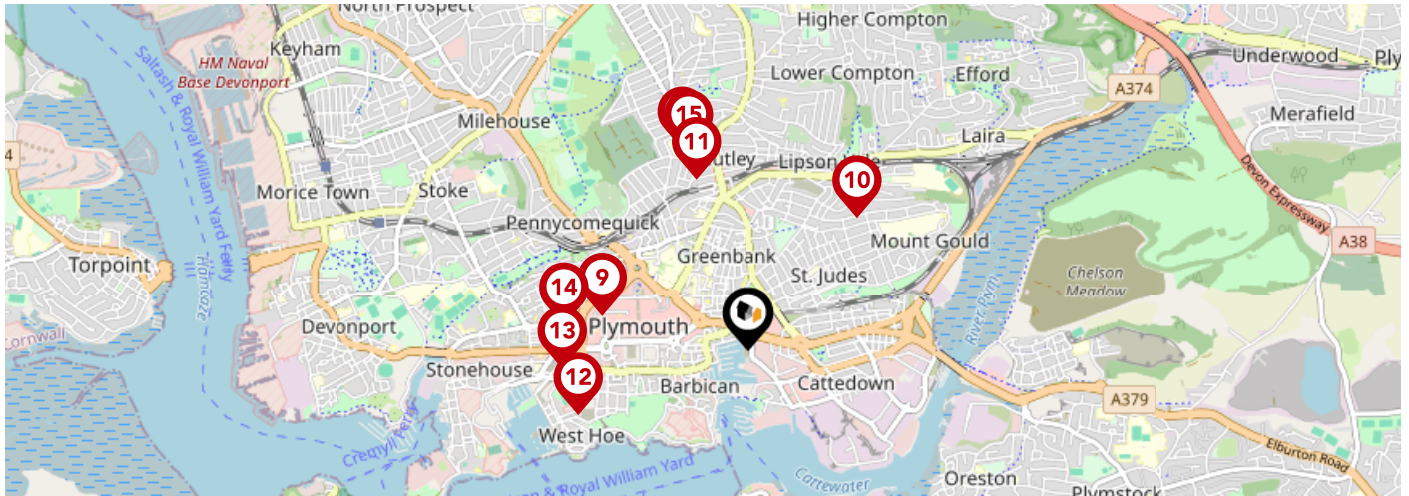

Listed Buildings in the local district		Grade	Distance
	1390890 - 4 Gascoyne Place Including Statuary Friezes In Rear Courtyard	Grade II	0.1 miles
	1330560 - Beaumont House	Grade II	0.1 miles
	1113338 - 9 And 10, Gascoyne Place	Grade II	0.1 miles
	1322018 - 7, Gascoyne Place	Grade II	0.1 miles
	1330561 - Church Of St Jude	Grade II	0.2 miles
	1130005 - Arches At St Martins Gate School	Grade II	0.2 miles
	1244521 - Church Of St John The Evangelist	Grade II	0.2 miles
	1386424 - 5, Sutton Wharf	Grade II	0.2 miles
	1330582 - Mayflower House	Grade II	0.2 miles
	1330581 - Kings Head Public House	Grade II	0.2 miles



		Nursery	Primary	Secondary	College	Private
1	Holy Cross Catholic Primary School Ofsted Rating: Good Pupils: 306 Distance:0.05	<input type="checkbox"/>	<input checked="" type="checkbox"/>	<input type="checkbox"/>	<input type="checkbox"/>	<input type="checkbox"/>
2	ACE Schools Plymouth Ofsted Rating: Good Pupils: 233 Distance:0.27	<input type="checkbox"/>	<input type="checkbox"/>	<input checked="" type="checkbox"/>	<input type="checkbox"/>	<input type="checkbox"/>
3	Mount Street Primary School Ofsted Rating: Good Pupils: 258 Distance:0.29	<input type="checkbox"/>	<input checked="" type="checkbox"/>	<input type="checkbox"/>	<input type="checkbox"/>	<input type="checkbox"/>
4	Arts University Plymouth Ofsted Rating: Good Pupils:0 Distance:0.32	<input type="checkbox"/>	<input type="checkbox"/>	<input checked="" type="checkbox"/>	<input type="checkbox"/>	<input type="checkbox"/>
5	Salisbury Road Primary School Ofsted Rating: Good Pupils: 381 Distance:0.39	<input type="checkbox"/>	<input checked="" type="checkbox"/>	<input type="checkbox"/>	<input type="checkbox"/>	<input type="checkbox"/>
6	Plymouth High School for Girls Ofsted Rating: Good Pupils: 816 Distance:0.56	<input type="checkbox"/>	<input type="checkbox"/>	<input checked="" type="checkbox"/>	<input type="checkbox"/>	<input type="checkbox"/>
7	Fletewood School at Derry Villas Ofsted Rating: Good Pupils: 58 Distance:0.56	<input type="checkbox"/>	<input checked="" type="checkbox"/>	<input type="checkbox"/>	<input type="checkbox"/>	<input type="checkbox"/>
8	Prince Rock Primary School Ofsted Rating: Outstanding Pupils: 408 Distance:0.64	<input type="checkbox"/>	<input checked="" type="checkbox"/>	<input type="checkbox"/>	<input type="checkbox"/>	<input type="checkbox"/>



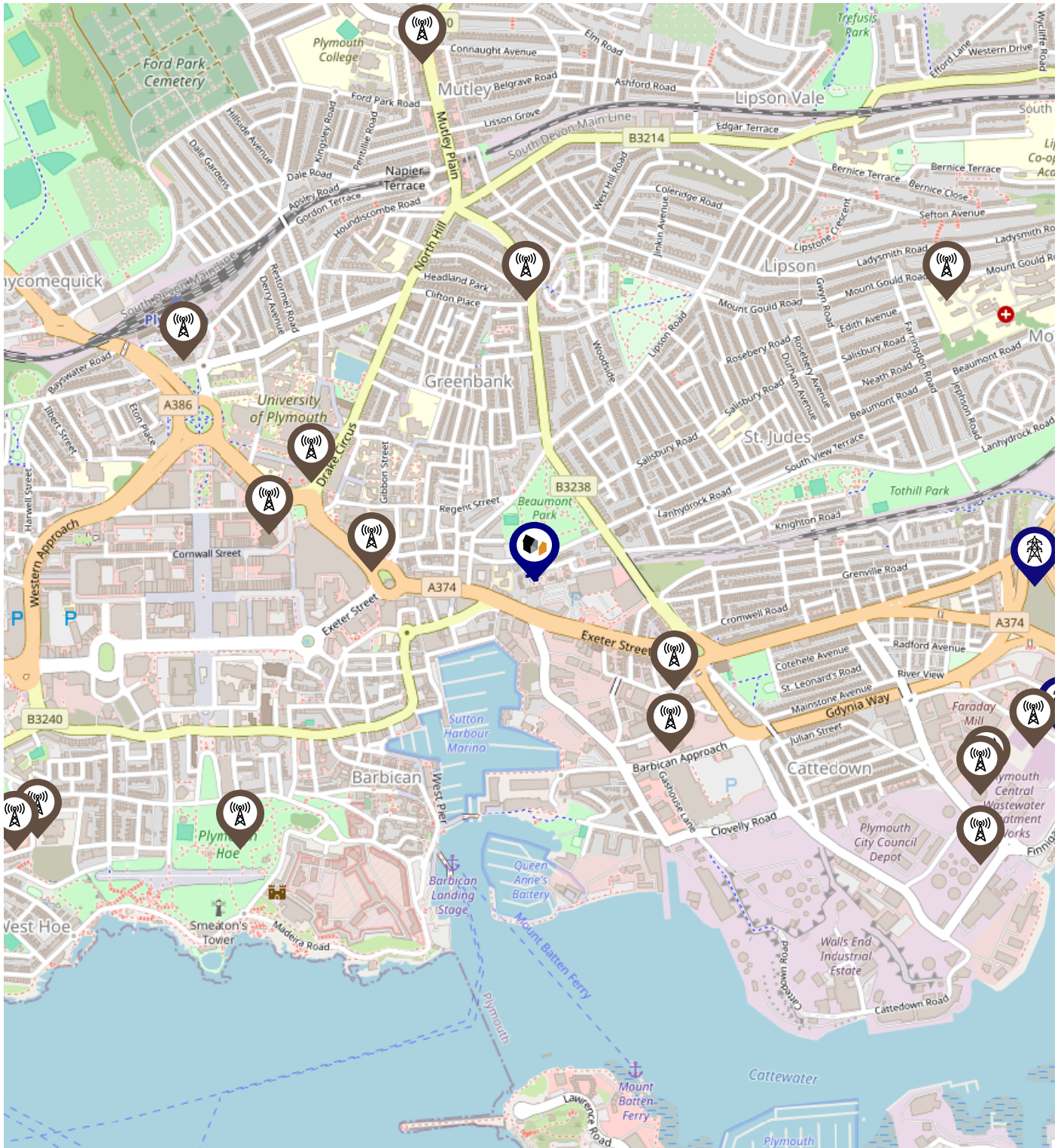

		Nursery	Primary	Secondary	College	Private
	Pilgrim Primary Academy Ofsted Rating: Outstanding Pupils: 390 Distance:0.71	<input type="checkbox"/>	<input checked="" type="checkbox"/>	<input type="checkbox"/>	<input type="checkbox"/>	<input type="checkbox"/>
	Lipson Vale Primary School Ofsted Rating: Good Pupils: 405 Distance:0.81	<input type="checkbox"/>	<input checked="" type="checkbox"/>	<input type="checkbox"/>	<input type="checkbox"/>	<input type="checkbox"/>
	Plymouth College Ofsted Rating: Not Rated Pupils: 513 Distance:0.84	<input type="checkbox"/>	<input type="checkbox"/>	<input checked="" type="checkbox"/>	<input type="checkbox"/>	<input type="checkbox"/>
	St Andrew's Cof E VA Primary School Ofsted Rating: Good Pupils: 208 Distance:0.86	<input type="checkbox"/>	<input checked="" type="checkbox"/>	<input type="checkbox"/>	<input type="checkbox"/>	<input type="checkbox"/>
	St Peter's CofE Primary School Ofsted Rating: Good Pupils: 154 Distance:0.88	<input type="checkbox"/>	<input checked="" type="checkbox"/>	<input type="checkbox"/>	<input type="checkbox"/>	<input type="checkbox"/>
	The Cathedral School of St Mary Ofsted Rating: Requires improvement Pupils: 109 Distance:0.88	<input type="checkbox"/>	<input checked="" type="checkbox"/>	<input type="checkbox"/>	<input type="checkbox"/>	<input type="checkbox"/>
	Hyde Park Infants' School Ofsted Rating: Not Rated Pupils: 243 Distance:0.98	<input type="checkbox"/>	<input checked="" type="checkbox"/>	<input type="checkbox"/>	<input type="checkbox"/>	<input type="checkbox"/>
	Hyde Park Junior School Ofsted Rating: Good Pupils: 355 Distance:1	<input type="checkbox"/>	<input checked="" type="checkbox"/>	<input type="checkbox"/>	<input type="checkbox"/>	<input type="checkbox"/>

Local Area Masts & Pylons



Key:

-  Power Pylons
-  Communication Masts

What is Radon?

Radon is a natural radioactive gas, which enters buildings from the ground. Exposure to high concentrations increases the risk of lung cancer. The UK Health Security Agency (UKHSA) recommends that radon levels should be reduced in homes where the annual average is at or above 200 becquerels per cubic metre (200 Bq/m³).

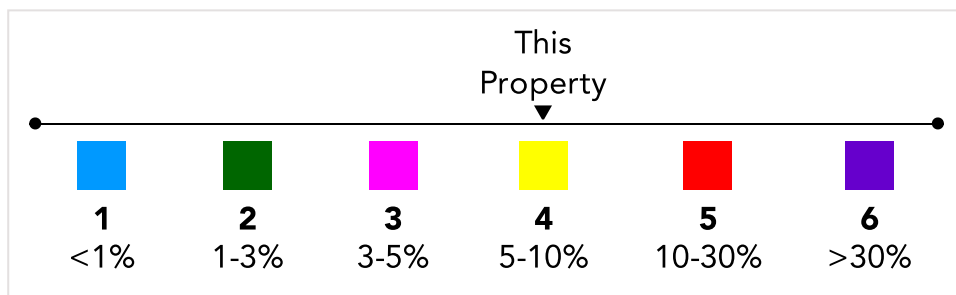
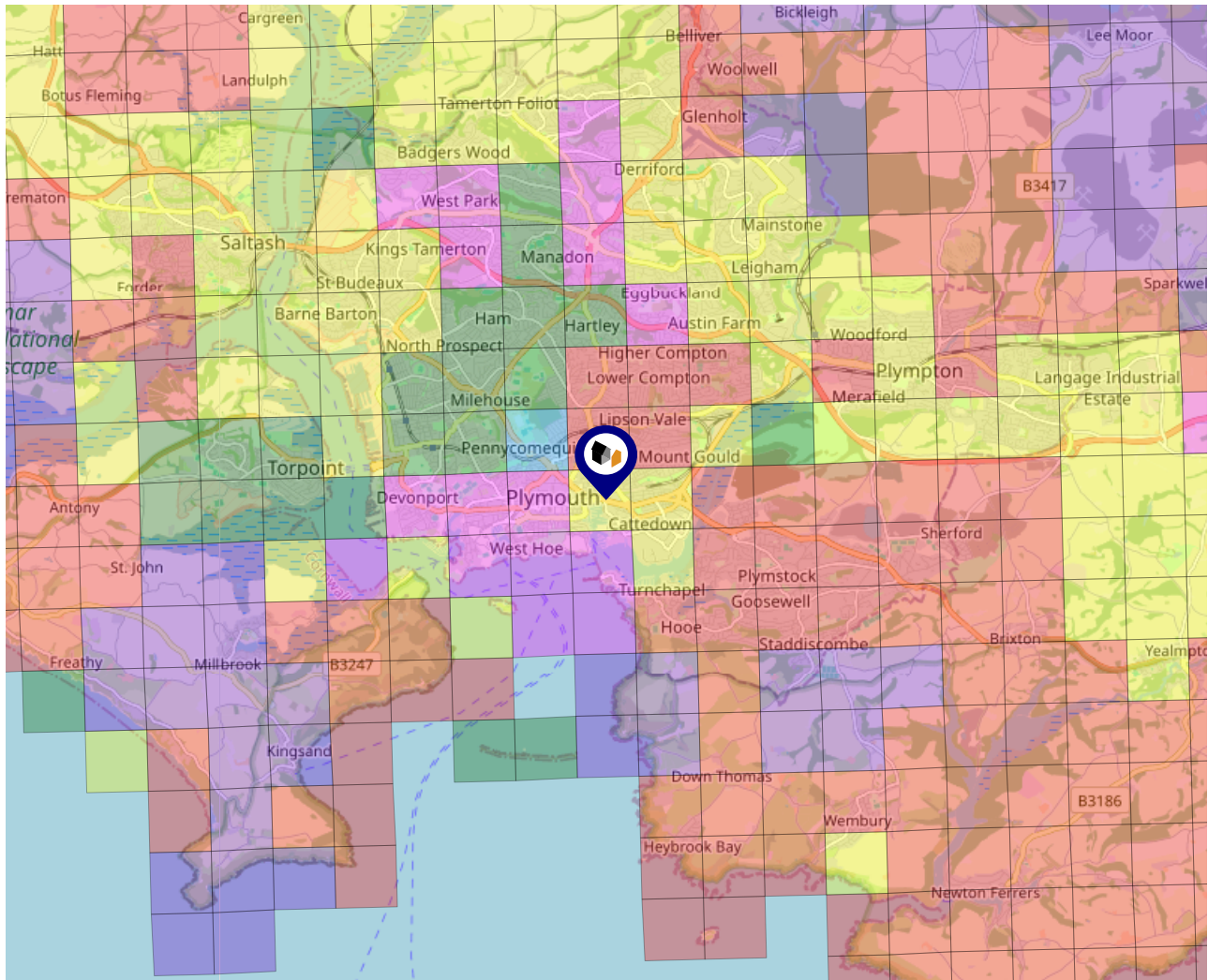

Local Area Road Noise

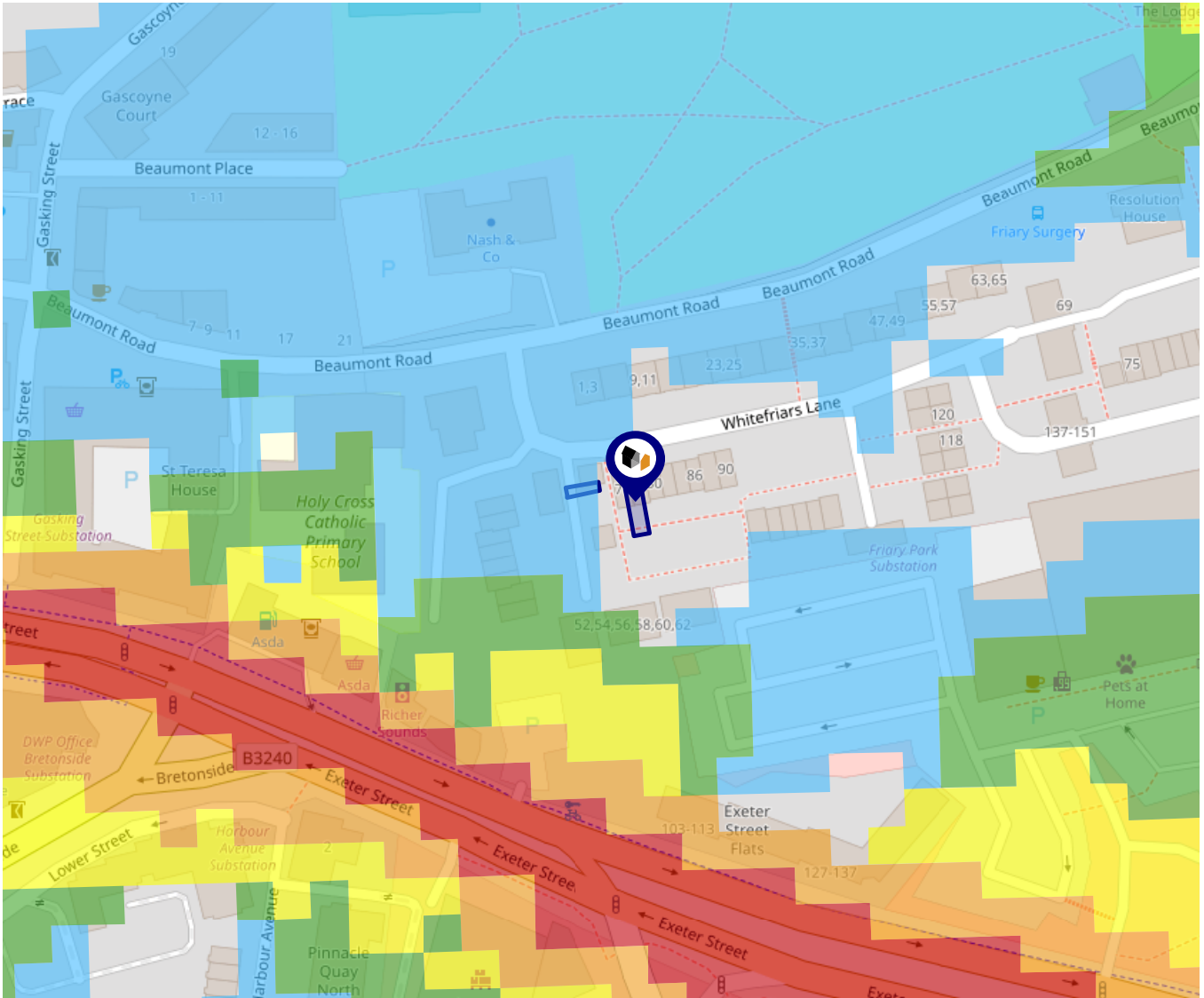

The data indicates the level of noise according to strategic noise sources across all traffic routes. This indicates a 25 house annual average noise level with separate weightings for the evening and the night periods.

- 75.0+ dB
- 70.0-74.9 dB
- 65.0-69.9 dB
- 60.0-64.9 dB
- 55.0-59.9 dB

Ground Composition for this Address (Surrounding square kilometer zone around property)

Carbon Content:	VARIABLE	Soil Texture:	LOAM TO SILTY LOAM
Parent Material Grain:	ARGILLIC - ARENACEOUS	Soil Depth:	INTERMEDIATE-SHALLOW
Soil Group:	MEDIUM TO LIGHT(SILTY) TO HEAVY		

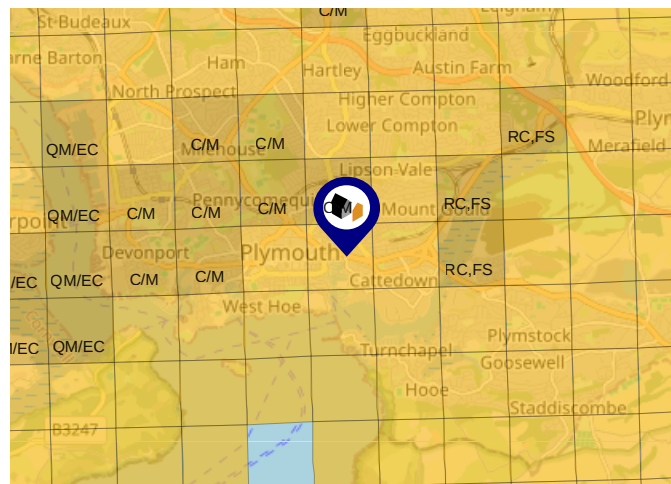

Primary Classifications (Most Common Clay Types)

C/M	Claystone / Mudstone
FPC,S	Floodplain Clay, Sand / Gravel
FC,S	Fluvial Clays & Silts
FC,S,G	Fluvial Clays, Silts, Sands & Gravel
PM/EC	Prequaternary Marine / Estuarine Clay / Silt
QM/EC	Quaternary Marine / Estuarine Clay / Silt
RC	Residual Clay
RC/LL	Residual Clay & Loamy Loess
RC,S	River Clay & Silt
RC,FS	Riverine Clay & Floodplain Sands and Gravel
RC,FL	Riverine Clay & Fluvial Sands and Gravel
TC	Terrace Clay
TC/LL	Terrace Clay & Loamy Loess

Area Transport (National)

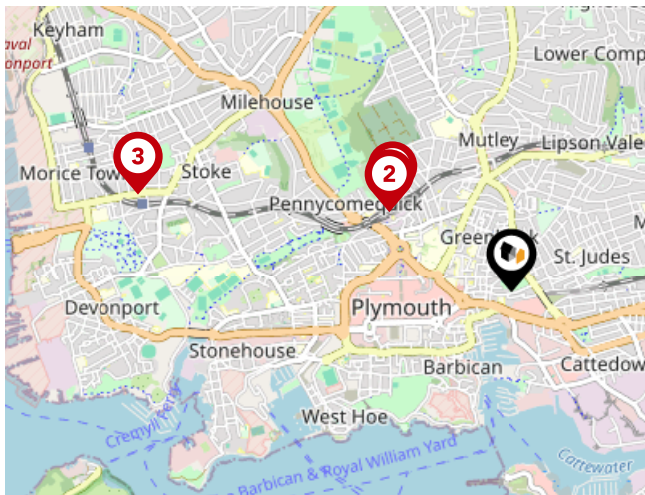

National Rail Stations

Pin	Name	Distance
1	Plymouth Rail Station	0.69 miles
2	Plymouth Rail Station	0.69 miles
3	Devonport Rail Station	1.82 miles

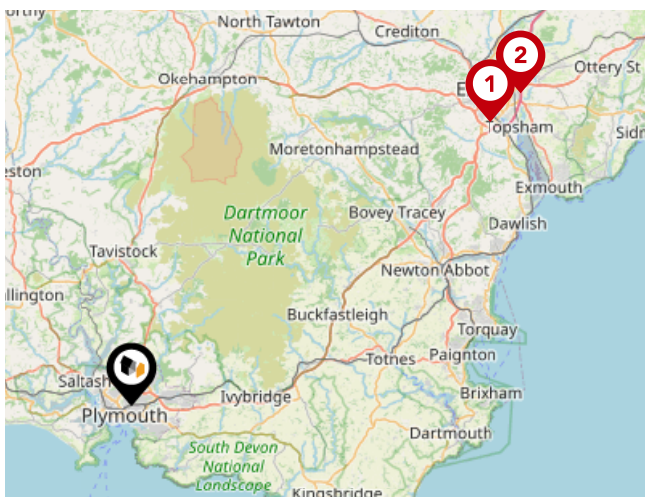

Trunk Roads/Motorways

Pin	Name	Distance
1	M5 J31	34.45 miles
2	M5 J30	37.6 miles

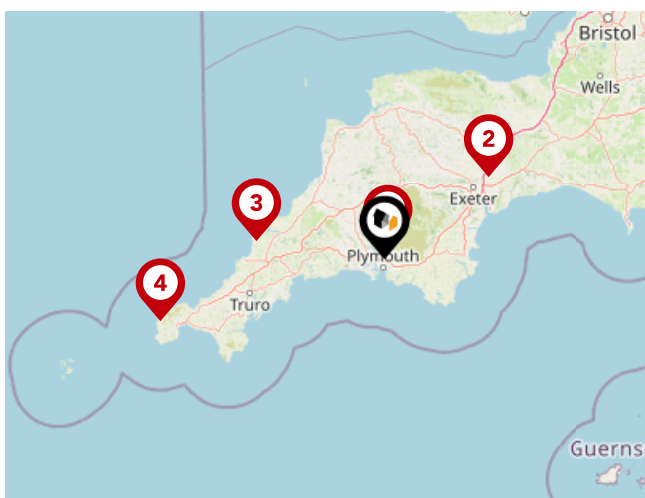

Airports/Helipads

Pin	Name	Distance
1	Glenholt	3.61 miles
2	Exeter Airport	40.03 miles
3	St Mawgan	38.91 miles
4	Joppa	70.51 miles

Area Transport (Local)



Bus Stops/Stations

Pin	Name	Distance
1	Friary Surgery	0.08 miles
2	St Therasas Court	0.08 miles
3	Gasking Street	0.12 miles
4	Exeter Street	0.15 miles
5	Friary Park	0.18 miles

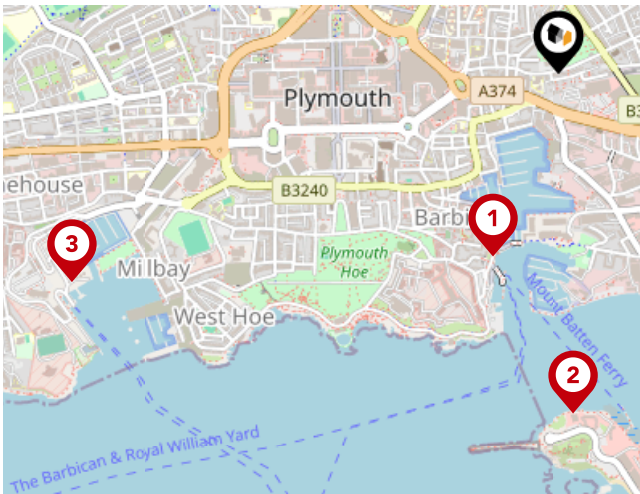

Ferry Terminals

Pin	Name	Distance
1	Plymouth (Barbican) Landing Stage	0.46 miles
2	Plymouth Mount Batten Ferry Landing	0.8 miles
3	Plymouth Ferry Terminal	1.25 miles

Lang Town & Country Data Quality

We are committed to comprehensive property data being made available upfront to make the home buying and selling process quicker, easier and cheaper. This is why we have partnered with Sprift, the UK's leading supplier of property-specific data.



Contains public sector information licensed under the Open Government License v3.0

The information contained within this report is for general information purposes only.

Sprift Technologies Ltd aggregate this data from a wide variety of sources and while we endeavour to keep the information up to date and correct, we make no representations or warranties of any kind, express or implied, about the completeness, accuracy, reliability, of the information or related graphics contained within this report for any purpose.

Any reliance you place on such information is therefore strictly at your own risk. In no event will we be liable for any loss or damage including without limitation, indirect or consequential loss or damage, or any loss or damage whatsoever arising from loss of data or profits arising out of, or in connection with, the use of this report.



Lang Town & Country

6 Mannamead Road, Plymouth, PL4 7AA

01752 456000

carrie@langtownandcountry.com

www.langtownandcountry.com

