



Villiers Crescent, St Albans, AL4 9HZ

£685,000

3 1 2



Set along the ever-popular Villiers Crescent, this attractive link-detached family home enjoys a peaceful residential setting that feels just right for day-to-day living. It's a spot that works beautifully for families, with a great choice of well-regarded schools close by, local shops, cafés, restaurants and bars at Jersey Farm and The Quadrant, and some lovely green spaces right on your doorstep. Weekend walks are easy to enjoy with Jersey Farm Woodland Park and Heartwood Forest just around the corner, while St Albans city centre and the mainline station are both within easy reach for days out or commuting into London. It's a location that balances convenience with a strong sense of community and a really enjoyable way of life.

Inside, the home has been thoughtfully extended to create bright, flexible spaces that suit modern living. It's a house that flows well, with practical storage throughout and a layout that works just as well for busy family life as it does for quiet evenings at home.

The ground floor is very much the heart of the house, with a generous open-plan living space leading into a stylish kitchen and dining area. The modern kitchen, complete with a central island, is ideal for everyday meals, homework sessions or catching up with friends. Doors open straight out to the garden, bringing in plenty of natural light and making indoor and outdoor living feel nicely connected. A downstairs WC, separate utility room and handy store room add to the practical feel of the space.

Upstairs, there are three well-proportioned bedrooms, all served by a smart, contemporary family bathroom, offering comfortable and easy living for growing families or professionals alike.

Outside, the front garden is neatly kept and provides useful off-street parking. To the rear, the south-facing garden is a real highlight, enclosed, sunny and well cared for, with a good-sized patio and lawn. It's a lovely spot for relaxed evenings, outdoor dining and family time in the warmer months.

Homes in this location are always popular, so we'd recommend



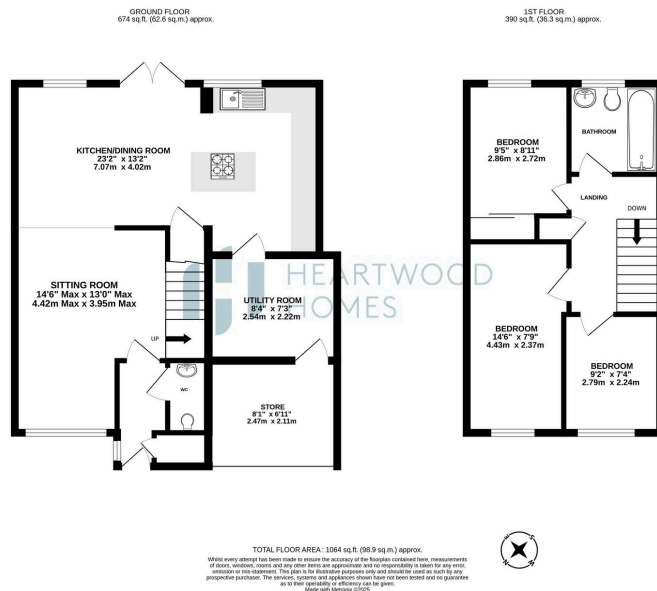

- Ideal for families with well-regarded schools nearby
- Easy access to countryside walks and green spaces
- Modern kitchen with island, perfect for family life
- Excellent storage, utility room and downstairs WC
- Convenient links to St Albans and London commuting
- Close to Jersey Farm/The Quadrant shops, cafés and restaurants
- Extended home with bright, open-plan living
- Three well-sized bedrooms and family bathroom
- South-facing private garden for relaxing and dining
- EPC Grade C

