



## Bloomfield Road

Harpenden, AL5 4DD

Handsome, detached four bedroom home of circa 1,907 sq ft with potential for extension and renovation (STPP). Mature, private rear garden in excess of 60ft with a westerly aspect, driveway and garage. Ideally located for excellent schooling and within walking distance of the town centre and station. **\*\*CHAIN FREE\*\***

**Guide price £1,375,000**

# Bloomfield Road

Harpenden, AL5 4DD



- Detached house
- Private rear garden
- Ideally located for excellent schooling
- \*\*CHAIN FREE\*\*
- Four bedrooms
- Driveway & garage
- Walking distance to the town centre & station
- Three reception rooms
- Potential for extension and renovation (STPP)
- Council Tax Band G

## Entrance Hall

## Living Room

17'4" x 11'11" (5.30 x 3.64)

## Dining Room

12'10" x 10'11" (3.93 x 3.33)

## Breakfast Room

10'10" x 10'9" (3.32 x 3.30)

## Kitchen

10'8" x 8'5" (3.26 x 2.57)

## Utility Room

6'5" x 5'7" (1.98 x 1.71)

## W/C

## Landing

## Bedroom One

17'10" (5.46)

## Bedroom Two

16'9" x 8'7" (5.13 x 2.64)

## Bedroom Three

12'0" x 9'6" (3.68 x 2.92)

## Bedroom Four

10'11" x 10'5" (3.33 x 3.19)

## Bathroom

## Garage

17'9" x 8'6" (5.43 x 2.60)

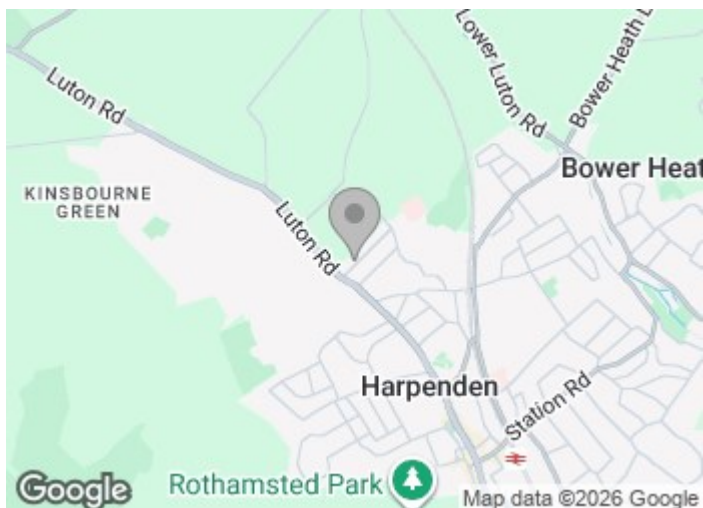

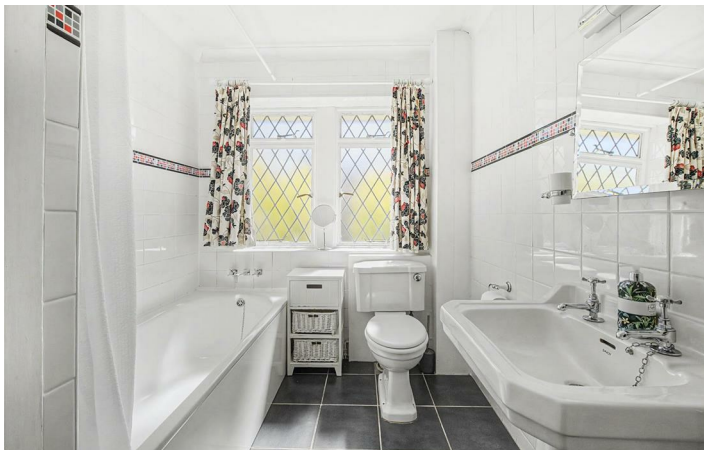

## Bloomfield Road

Approximate Gross Internal Area = 117.0 sq m / 1907 sq ft

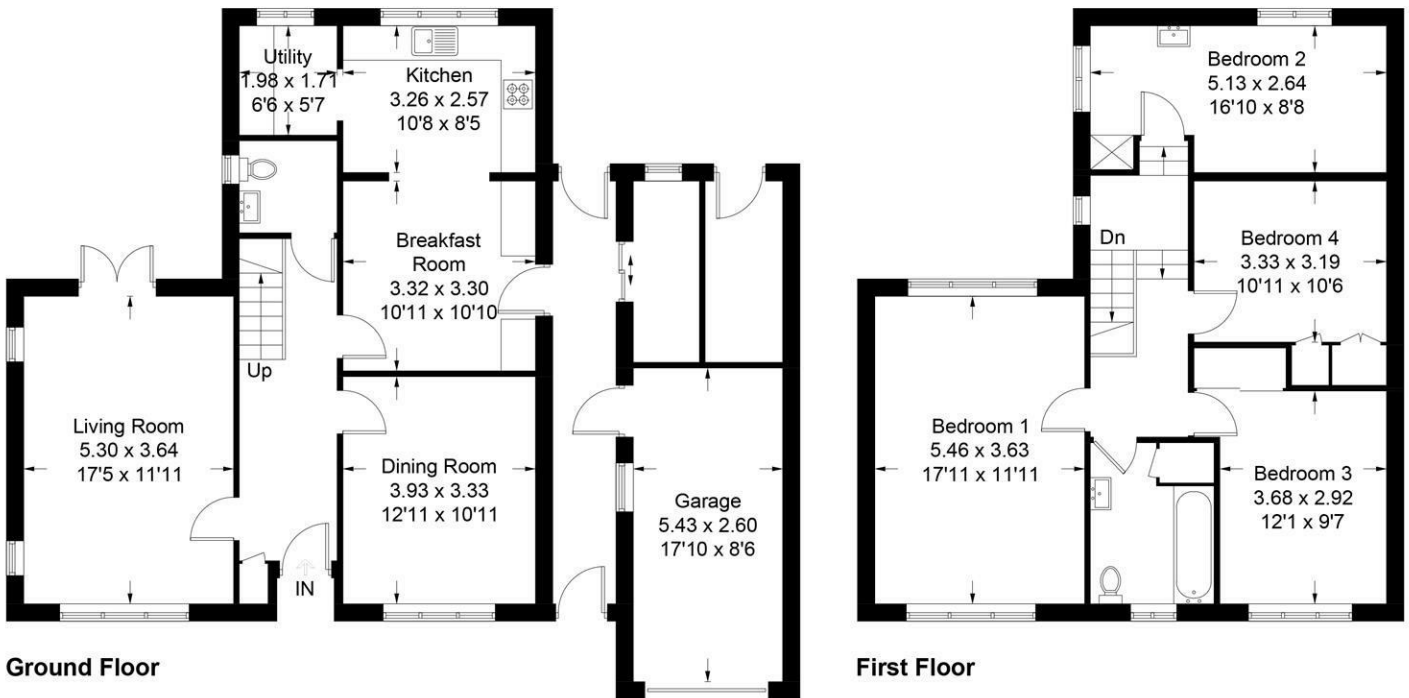

This plan is for layout guidance only. Not drawn to scale unless stated. Windows and door openings are approximate. Whilst every care is taken in the preparation of this plan, please check all dimensions, shapes and compass bearings before making any decisions reliant upon them. (ID1298518)

These particulars, whilst believed to be accurate are set out as a general outline only for guidance and do not constitute any part of an offer or contract. Intending purchasers should not rely on them as statements of representation of fact, but must satisfy themselves by inspection or otherwise as to their accuracy. No person in this firm's employment has the authority to make or give any representation or warranty in respect of the property.

