

KEYSTONE



St. Matthews Street, Ipswich, IP1 3EW

£550 PCM

- Studio Apartment - West Ipswich Town Centre
- GAS & WATER BILLS INCLUDED
- AVAILABLE AFTER 26/05/26
- Please note there is NO PARKING AT ALL WITH THIS PROPERTY >>>
- You will still need to pay Electric & Council Tax
- Gas central heating & Double Glazed
- EPC rating E

GROUND FLOOR
288 sq.ft. (26.8 sq.m.) approx.

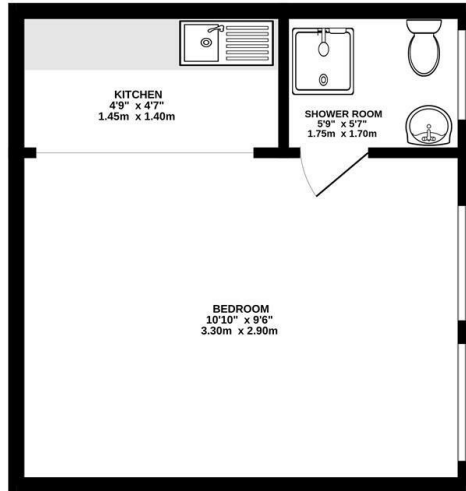

TOTAL FLOOR AREA: 288 sq.ft. (26.8 sq.m.) approx.
While every effort has been made to ensure the accuracy of the foregoing contained here, measurements of doors, windows, openings and any other items are approximate and no responsibility is taken for any error, omission or misstatement. This plan is for illustrative purposes only and should not be used as such for any prospective purchase. The services, systems and appliances shown have not been tested and no guarantee can be given.
Made with Mirograph C2024

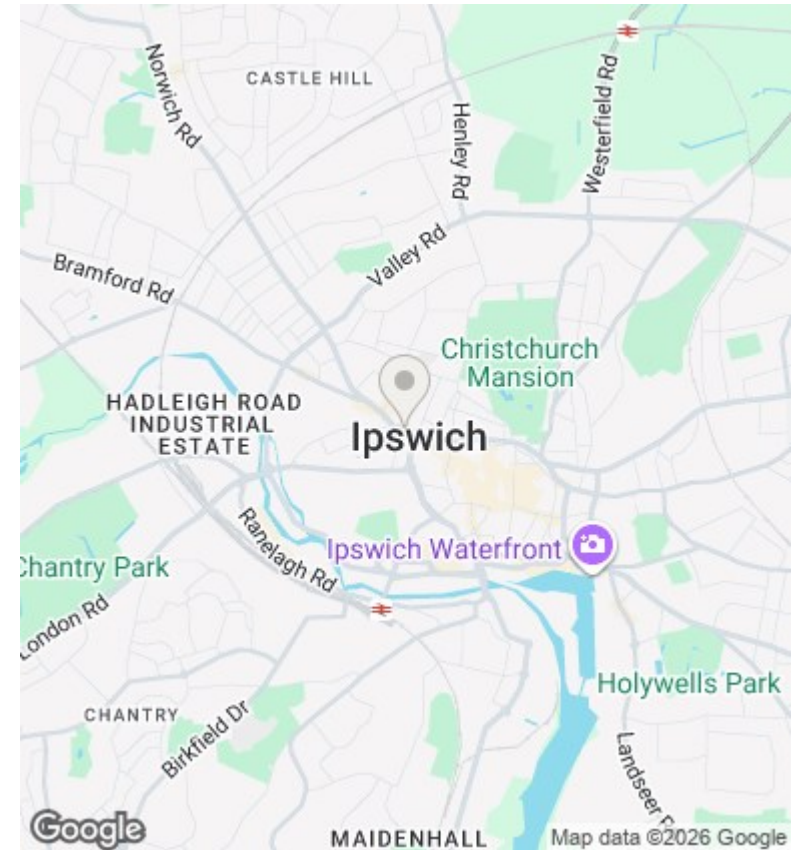

Directions

Viewings

Viewings by arrangement only. Call 01473 221 399 to make an appointment.

EPC Rating:

E

Energy Efficiency Rating		Current	Potential
<i>Very energy efficient - lower running costs</i>			
(92 plus)	A		
(81-91)	B		
(69-80)	C		
(55-68)	D		
(39-54)	E	54	64
(21-38)	F		
(1-20)	G		
<i>Not energy efficient - higher running costs</i>			
England & Wales		EU Directive 2002/91/EC	