

HUNTERS®

HERE TO GET *you* THERE



North Street

Oldland Common, Bristol, BS30 8TU

£1,850 Per Month



Nestled in the charming area of Oldland Common, Bristol, this delightful detached cottage on North Street perfectly combines modern living with traditional character.

The property features three well-proportioned bedrooms, including a stylish principal bedroom with en suite, making it ideal for families or professionals seeking comfort and convenience.

The spacious reception room provides a welcoming space for relaxation and entertaining, while the modern kitchen comes complete with integrated appliances for a seamless living experience. In addition to the en suite, there is a well-appointed family bathroom and a convenient downstairs W/C, ensuring practicality throughout.

Outside, enjoy a private courtyard—perfect for relaxing and low maintenance. Benefit from parking for two vehicles, a valuable bonus in this sought-after location.

The property offers space for an office or a laundry room.



Area Map



Floor Plans

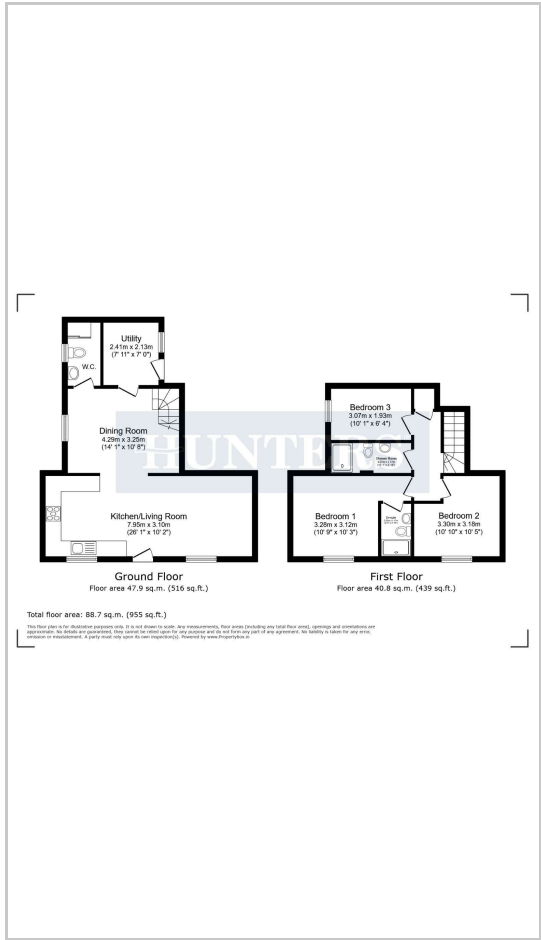

Energy Efficiency Graph

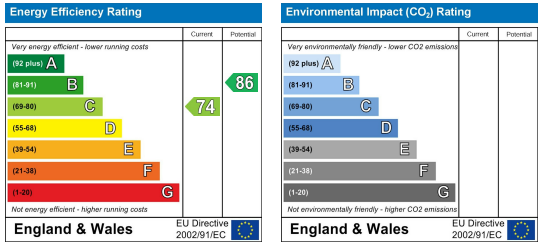

These particulars are intended to give a fair and reliable description of the property but no responsibility for any inaccuracy or error can be accepted and do not constitute an offer or contract. We have not tested any services or appliances (including central heating if fitted) referred to in these particulars and the purchasers are advised to satisfy themselves as to the working order and condition. If a property is unoccupied at any time there may be reconnection charges for any switched off/disconnected or drained services or appliances - All measurements are approximate. **THINKING OF SELLING?** If you are thinking of selling your home or just curious to discover the value of your property, Hunters would be pleased to provide free, no obligation sales and marketing advice. Even if your home is outside the area covered by our local offices we can arrange a Market Appraisal through our national network of Hunters estate agents.