



**POOLE
TOWNSEND**

Corner Cottage, Lowick Green, LA12 8DU

£170,000

3 1 1



- Within Lake District National Park
- Close Proximity to Windermere & Coniston
- Picturesque Views
- No Upper Chain
- Log Burning Stove
- Freehold
- Off Road Parking
- Ideal Holiday Let/ Second Home
- Full of Character
- EPC - F



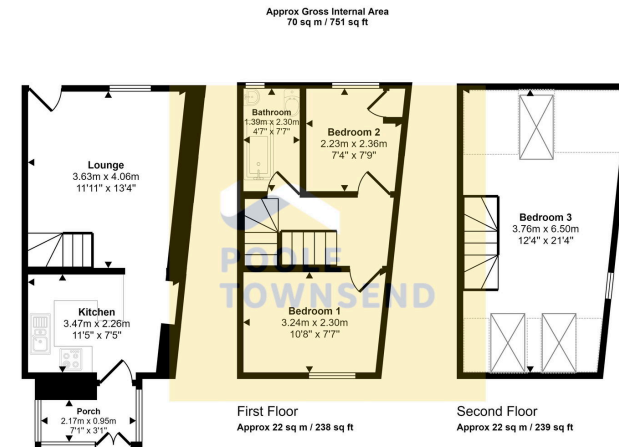

This delightful Lakeland Cottage is beautifully presented, offering comfortable accommodation that extends to 3 floors including an impressive loft conversion where there are lovely elevated views to the nearby fields. Set in the Lake District National Park and only a short trip by car to Fell Foot Park on the shores of Lake Windermere (approx 8 miles), to the tip of Coniston Water (approx 3 miles) and to Coniston Village, home of Donald Campbell's record breaking Bluebird hydroplane (approx 9 miles). This property would be an ideal home, a holiday retreat or an investment/Airbnb opportunity. The accommodation includes a lounge with solid fuel stove, fitted kitchen, 2 double bedrooms, a single bedroom and a 3-piece bathroom. There is off-road parking in front of the property and in the near lay-by and a detached patio garden across the road overlooking fields. Furnishings/contents are available by

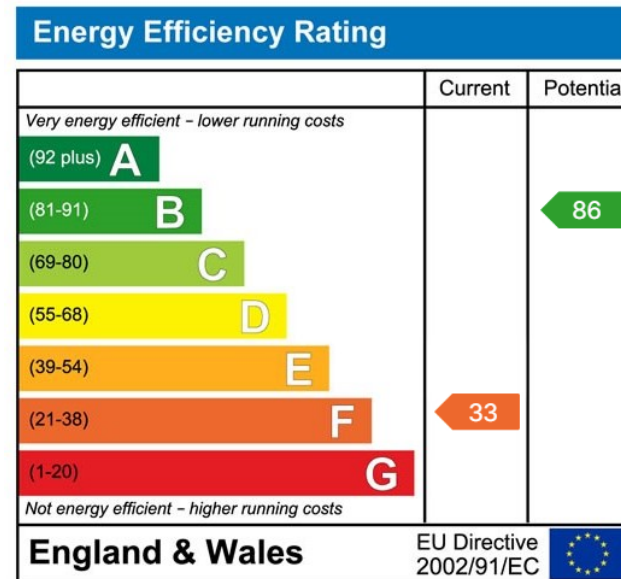

Visit us at
www.pooletownsend.co.uk
enquiries@pooletownsend.co.uk

We are open
 Monday – Friday 9.00 – 5.00
 Saturday 9.00 – 1.00

Barrow 01229 811811
 Ulverston 01229 588111
 Grange 015395 33316
 Kendal 01539 734455
 Milnthorpe 015395 62044