



Apartment 2 Chelford House | Offerton | SK2 5GE

EDWARD
mellor



Features

- Stunning 2 Bedroom Ground Floor Apartment
- 2 Genuine Double Bedrooms
- 2 Bathrooms Inc En Suite
- No Onward Chain
- Superbly Fitted Kitchen

Add a touch of "Grandure" to apartment living with this beautifully presented and incredibly spacious 2 double bedroom, 2 bathroom apartment opposite Stockport Golf Club. This executive style development known as "Chelford House" stands within picturesque and manicured

grounds and is accessed via electric security gates with resident and visitor parking and is being offered For Sale with No Onward Chain so a quick completion can be accommodated. The property enjoys a much favoured ground floor position and features a beautifully fitted and open plan kitchen

with integrated appliances, superb en suite shower room to the master bedroom, attractively fitted 3 piece bathroom and a spacious lounge / living room providing ample room for entertaining. Viewing essential.



Chelford House enjoys a slightly elevated and private position off Offerton Road and is within easy access of Hazel Grove centre and Marple village. The property will suit a range of buyers from young professionals to those wishing to downsize on one level and whilst still retaining a real sense of space. The accommodation on offer briefly comprises : Communal entrance with security entry system, private and welcoming entrance hall with useful cloaks cupboard, impressive front living room which is open plan into the beautifully fitted kitchen with breakfast bar area, 2 generous size double bedrooms with en suite shower room to the master bedroom whilst a lovely 3 piece bathroom suite completes the living space. Externally, there is allocated residents and visitor parking beyond the security entry gates and beautiful, landscaped communal gardens surrounding the development.



FLOOR LAYOUT

Not to Scale - For Identification Purposes Only

GROUND FLOOR
785 sq.ft. (72.9 sq.m.) approx.

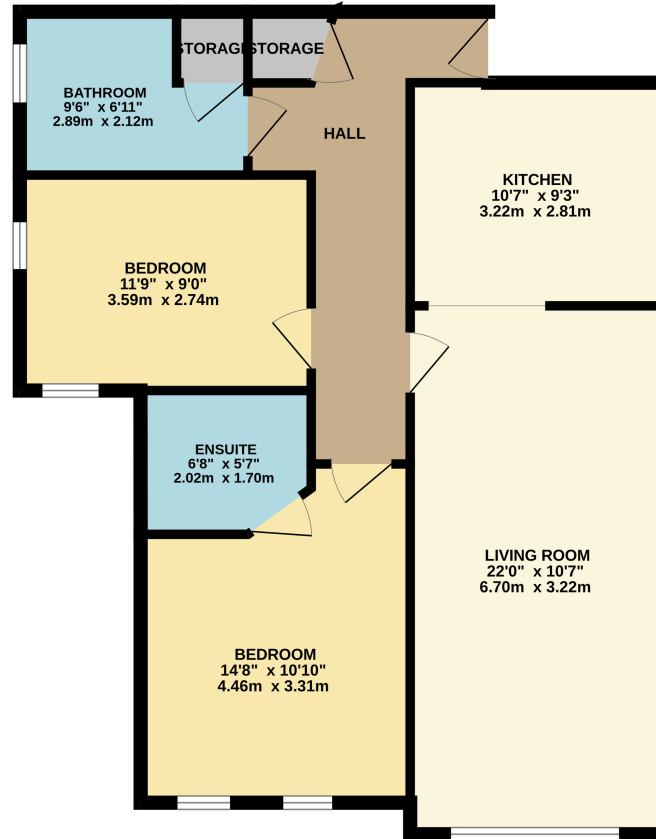

TOTAL FLOOR AREA: 785 sq.ft. (72.9 sq.m.) approx.

Whilst every attempt has been made to ensure the accuracy of the floorplan contained here, measurements of doors, windows, rooms and any other items are approximate and no responsibility is taken for any error, omission or mis-statement. This plan is for illustrative purposes only and should be used as such by any prospective purchaser. The services, systems and appliances shown have not been tested and no guarantee as to their operability or efficiency can be given.

Made with Metropix ©2025

Important Information

- Council Tax Band: D
- Tenure: Leasehold
- Years Remaining on the Lease : 977 Years

EPC Rating

182, London Road, SK7 4DQ
T: 0161 456 6000
E: hazelgrove@edwardmellor.co.uk

The agent has not tested apparatus, equipment, fittings or services and so cannot verify they are in working order or fit for their purpose. The buyer is advised to obtain verification from their Solicitor or Surveyor. Photographs are reproduced for general information and it must not be inferred that any item is included for sale with the property. Please note that all measurements are approximate. These particulars are issued on the understanding that any negotiations in regard to this property are carried out through Edward Mellor Ltd. This property is offered subject to not being sold or withdrawn on receipt of reply. These particulars are believed to be correct but do not form a contract for sale. None of the statements contained in these particulars as to this property are to be relied on as statements or representations of fact. The vendor does not make or give, and neither Edward Mellor Ltd. nor any person in their employment has any authority to make or give, any representation or warranty in relation to this property.