



*Jordan fishwick*

280-282 Burton Road, M20 2DH  
Guide Price £1,500 Per Calendar Month



**Burton Road West Didsbury  
M20 2DH**

**£1,500 Per Calendar Month**



### The Property

\*\*\* AVAILABLE JULY \*\*\* Jordan Fishwick are delighted to bring to the rental market this stunning two double bedroom apartment in the heart of West Didsbury on the ever-popular Burton Road. The property located on Burton Road and is a few minutes' walk from local shops, bars, restaurants, cafés and Metrolink and is ideal for a professional couple or sharers. In brief the property comprises; entrance hall with storage cupboard, fully fitted modern kitchen with built in appliances, large lounge area, two double bedrooms with built in wardrobes, the master benefitting from en-suite and further three-piece bathroom suite. The property also benefits from gas central heating, HIVE thermostatic control, double glazing and secure gated off-road parking. Offered on an unfurnished basis. Contact our Didsbury office to arrange a viewing.

View our Virtual Tour Here - <https://youtu.be/b87P3UnA-bc>

EPC Rating - B // Council Tax Band D

- Available July
- Two Double Bedrooms
- Two Bathrooms
- Unfurnished
- Great Location of Burton Road
- Walking Distance to all Amenities
- Ideal for Sharers or a Couple
- Secure Parking
- Council Tax Band D
- EPC Rating B



Energy Efficiency Rating		
	Current	Potential
Very energy efficient - lower running costs		
(92 plus) <b>A</b>		
(81-91) <b>B</b>	<b>82</b>	<b>82</b>
(69-80) <b>C</b>		
(55-68) <b>D</b>		
(39-54) <b>E</b>		
(21-38) <b>F</b>		
(1-20) <b>G</b>		
Not energy efficient - higher running costs		
<b>England &amp; Wales</b>	EU Directive 2002/91/EC	



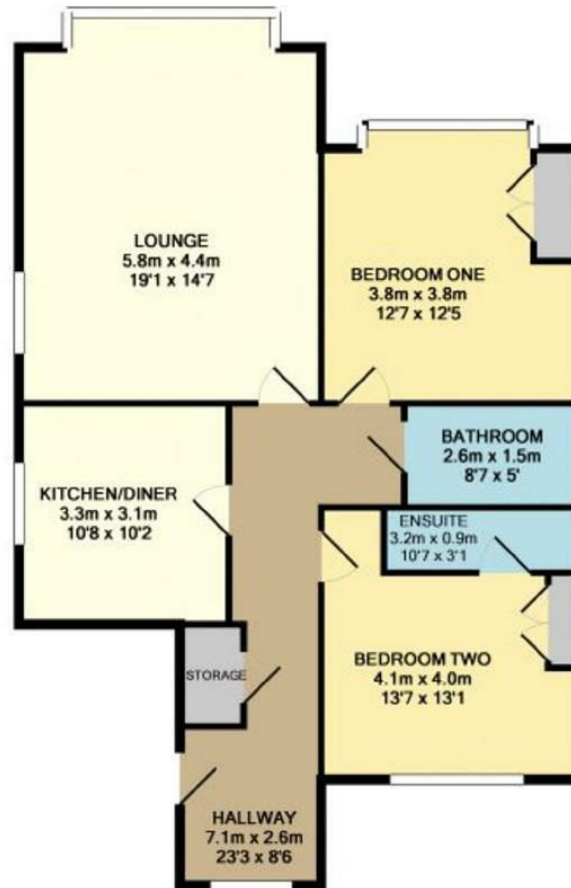

TOTAL APPROX. FLOOR AREA 83.8 SQ.M. (902 SQ.FT.)

Whilst every attempt has been made to ensure the accuracy of the floor plan contained here, measurements of doors, windows, rooms and any other items are approximate and no responsibility is taken for any error, omission, or mis-statement. This plan is for illustrative purposes only and should be used as such by any prospective purchaser. The services, systems and appliances shown have not been tested and no guarantee as to their operability or efficiency can be given.  
Made with Metropix ©2018



These particulars are believed to be accurate but they are not guaranteed and do not form a contract. Neither Jordan Fishwick nor the vendor or lessor accept any responsibility in respect of these particulars, which are not intended to be statements or representations of fact and any intending purchaser or lessee must satisfy himself by inspection or otherwise as to the correctness of each of the statements contained in these particulars. Any floorplans on this brochure are for illustrative purposes only and are not necessarily to scale.

Offices at: Chorlton, Didsbury, Disley, Hale, Glossop, Macclesfield, Manchester Deansgate, Manchester Whitworth Street, New Mills, Sale, Wilmslow and Withington