



The Greenway, Epsom

In Excess of **£500,000**



The Greenway

Epsom

Delightful 3-bed semi-detached home in sought-after location. Spacious reception room, 3 generous bedrooms, family bathroom. Large rear garden with summerhouse. Close to Epsom & Ashted. Call now to view!

Council Tax band: D

Tenure: Freehold

EPC Energy Efficiency Rating: D

EPC Environmental Impact Rating: G

- No Onward Chain
- Popular Location
- Large Summerhouse/Ideal As Gym/Home Working
- Bright Reception
- Modern Kitchen
- Three Generous Bedrooms
- Family Bathroom
- Good Size Garden
- Easy Reach of Epsom & Ashted & Stations



Introducing this delightful three-bedroom semi-detached residence, offered to the market with no onward chain and situated in a highly sought-after location.

This well-presented home features a bright and spacious through reception room enjoying an abundance of natural light, complemented by a fitted galley-style kitchen. The first floor comprises three well-proportioned bedrooms, ideal for family living, together with a modern family bathroom.

Externally, the property benefits from a generous rear garden providing ample space for outdoor entertaining and relaxation. A substantial summerhouse further enhances the appeal, offering versatile use as a home office, gym, or studio.

Perfectly positioned within easy reach of both Epsom and Ashted, each offering mainline train stations and an array of shops and amenities, this superb property combines comfort, convenience, and excellent connectivity.

Call us today to schedule your viewing!

The Greenway, Epsom, KT18

Approximate Area = 718 sq ft / 66.7 sq m

Outbuilding = 142 sq ft / 13.1 sq m

Total = 860 sq ft / 79.8 sq m

For identification only - Not to scale

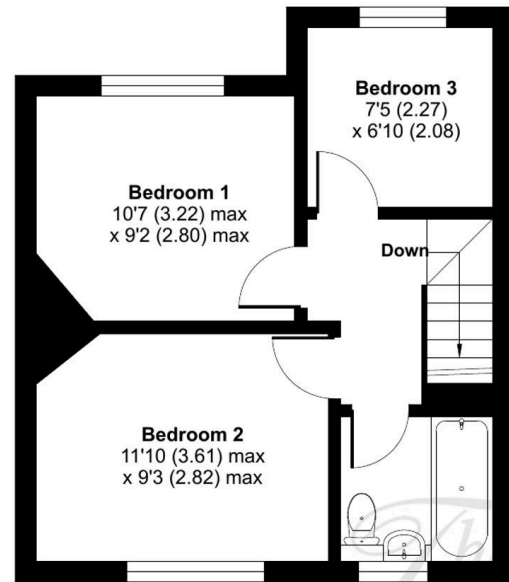

FIRST FLOOR

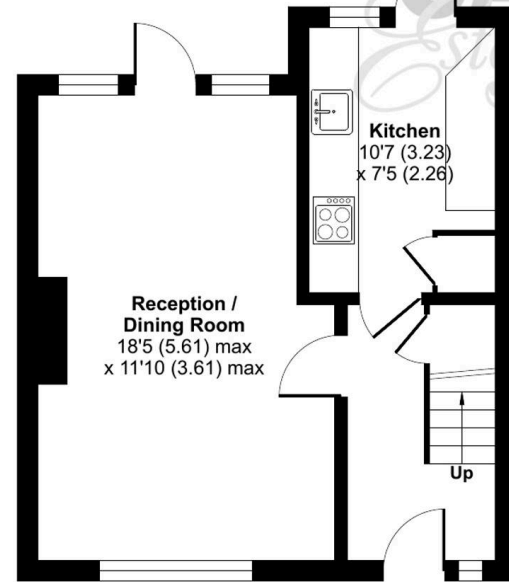

GROUND FLOOR



CAIRDS
Estate Agents

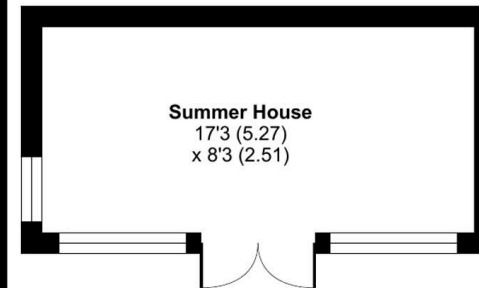





Cairds The Estate Agents

Cairds The Estate Agents, 128-130 High Street - KT19 8BT

01372 743033 • homes@cairds.co.uk • www.cairds.co.uk