



## 30 Brenda Crescent

, Liverpool, L23 4TZ

**Offers in the region of £380,000**



Nestled in the charming area of Brenda Crescent, this stunning semi-detached house is a true gem, perfect for families or those seeking a comfortable home. Immaculately presented and neutrally decorated throughout, this property is ready for you to move in without any hassle.

Upon entering, you are greeted by a spacious entrance hallway that leads to two inviting reception rooms. The front room serves as a cosy lounge, complete with a delightful log burner. The rear reception room can be utilised as a dining area, providing a perfect space for family meals and entertaining guests. The separate fitted kitchen boasts French doors that open onto a lovely south-west facing garden, allowing for an abundance of natural light and a seamless indoor-outdoor living experience.

The first floor comprises three well-proportioned bedrooms, each offering ample space for relaxation and rest. A modern family bathroom suite, featuring a shower cubicle and convenient storage, completes the upper level of this delightful home.

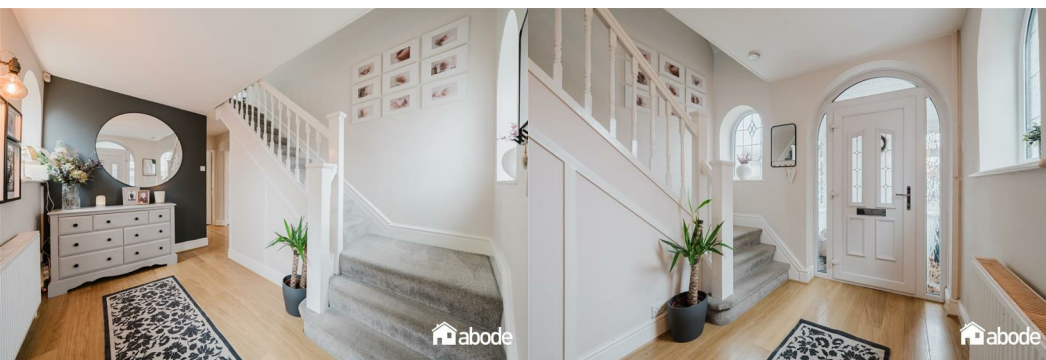

Area Map

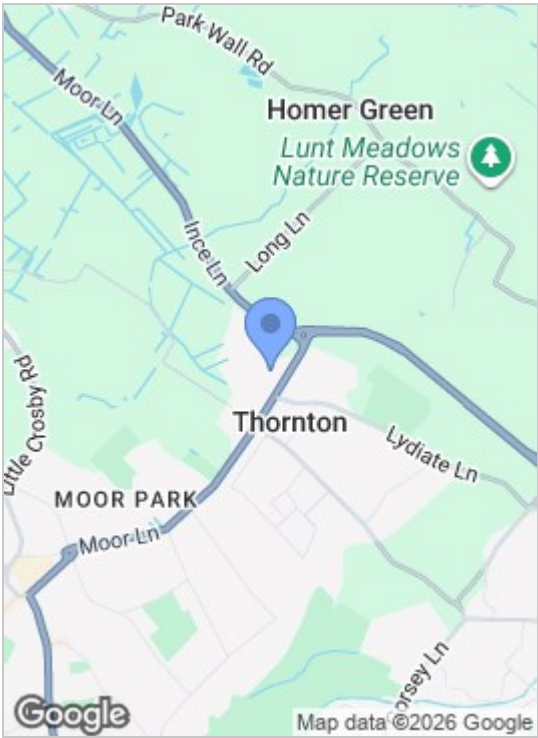

Floor Plans

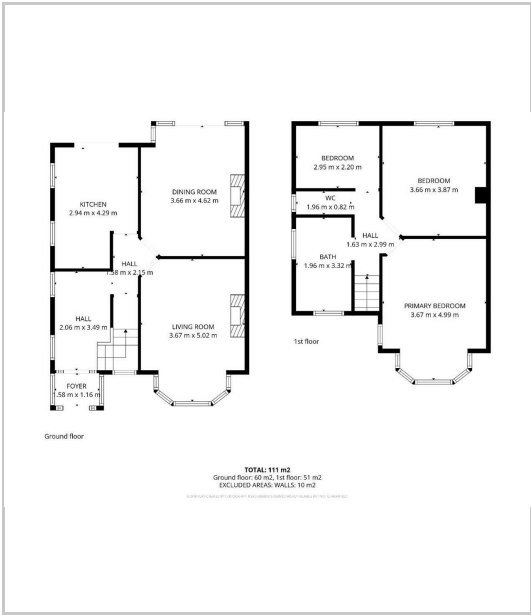

Energy Efficiency Graph



These particulars, whilst believed to be accurate are set out as a general outline only for guidance and do not constitute any part of an offer or contract. Intending purchasers should not rely on them as statements of representation of fact, but must satisfy themselves by inspection or otherwise as to their accuracy. No person in this firms employment has the authority to make or give any representation or warranty in respect of the property.

82 Coronation Road, Crosby, Liverpool L23 5RH  
**Tel:** 0151 909 3003  
**Email:** crosby@abode.group.co.uk  
**Web:** www.abode-group.co.uk

6 Allerton Road, Mossley Hill, Liverpool, L18 1LN  
**Tel:** 0151 601 3003  
**Email:** allerton@abode-group.co.uk  
**Web:** www.abode-group.co.uk

2 Chapel Lane, Formby, Liverpool, L37 4DU  
**Tel:** 01704 827 402  
**Email:** formby@abode-group.co.uk  
**Web:** www.abode-group.co.uk