



# GRANT HOUSE, SW8

£395,000

Three bedrooms  
Ground floor apartment  
Grade II listed building  
Close to Clapham Common  
Excellent local transport links  
Energy rating: d

@marshandparsons  
marshandparsons.co.uk

MARSH &  
PARSONS



# ABOUT THE PROPERTY

Spacious three double bedroom apartment located on the ground floor of a Grade II Listed building near Clapham Old Town and the open spaces of Clapham Common.

Ideally located just moments from the vibrant shops, bars, and restaurants of Clapham Common, this flat offers superb connectivity. Nearby transport links include Clapham North Underground Station (Northern Line) and Wandsworth Road overground station, providing direct routes to Clapham Junction and Canary Wharf via Canada Water, ensuring quick and easy access to the City and the West End.



# STEP INSIDE GRANT HOUSE

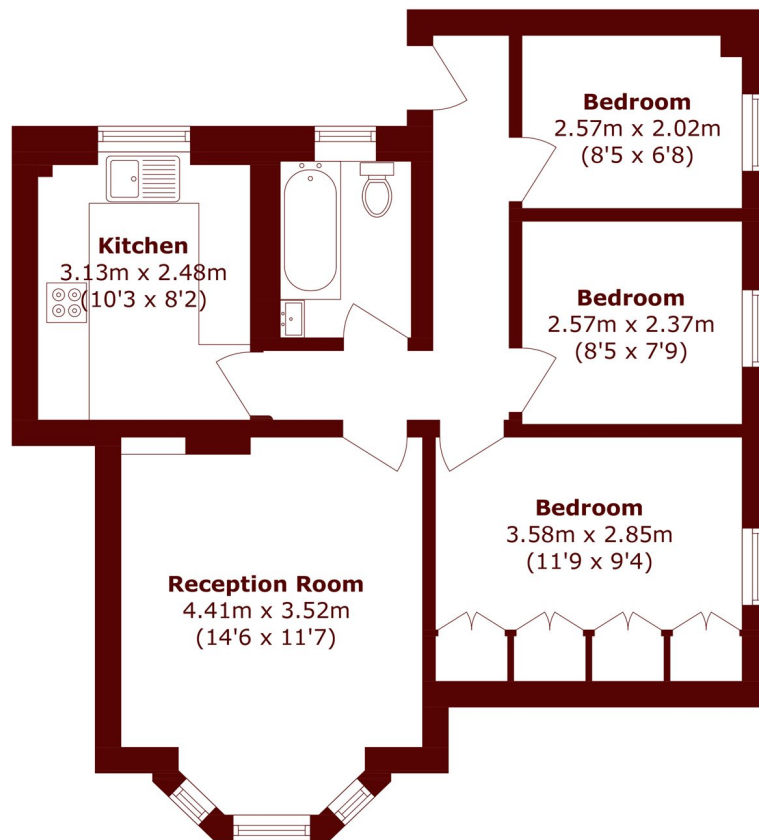

Total area (approx.): 56.9 sq. m (612.5 sq. ft)

**Clapham**  
020 7501 3666

Energy Rating: D We aim to make our particulars both accurate and reliable. However, they are not guaranteed; nor do they form part of an offer or contract. If you require clarification on any points then please contact us, especially if you're traveling some distance to view. Please note that appliances and heating systems have not been tested and therefore no warranties can be given as to their good working order

**MARSH &  
PARSONS**