



Rosemary Gardens

Mortlake, SW14

£2,000 per month
(£461.54 per week)

A recently refurbished top floor apartment within a secure and friendly development is presented in excellent condition throughout.

The flat benefits from double glazed windows, has a modern fitted kitchen which is semi-open plan with the main living room.

The apartment offers two bedrooms, with floor to ceiling wardrobes and fitted floating cupboards, and a modern tiled bathroom. On site parking is available to all residents.

Rosemary Gardens is superbly located next to Mortlake Station (0.1 miles away), the many restaurants, coffee shops and bakeries on Sheen Lane and the open spaces of the development, Mortlake Green and the River Thames accessed by the nearby footpath.

CHESTERTONS



Rosemary Gardens

Mortlake, SW14

- Two Bedrooms
- Recently refurbished
- Close to Mortlake Station
- Onsite parking



Deposit Required: £2,307.69
Local Authority: London Borough of Richmond upon Thames
Council Tax Band: C
EPC Rating: C
Furnished, Part Furnished, Unfurnished

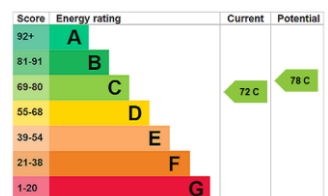

Chestertons East Sheen Lettings

254a Upper Richmond Road West
East Sheen
London
SW14 8AG
sheenlettingsusers@chestertons.co.uk
02081040580
chestertons.co.uk

Additional tenant charges apply (fees apply to non-AST tenancies only)
Tenancy Agreement Fee: £300
References per Tenant/Guarantor: £60
Inventory check (approx. £100 – £250 inc. VAT)
chestertons.co.uk/property-to-rent/applicable-fees

Rosemary Gardens, East Sheen, SW14



○ - Ceiling Height

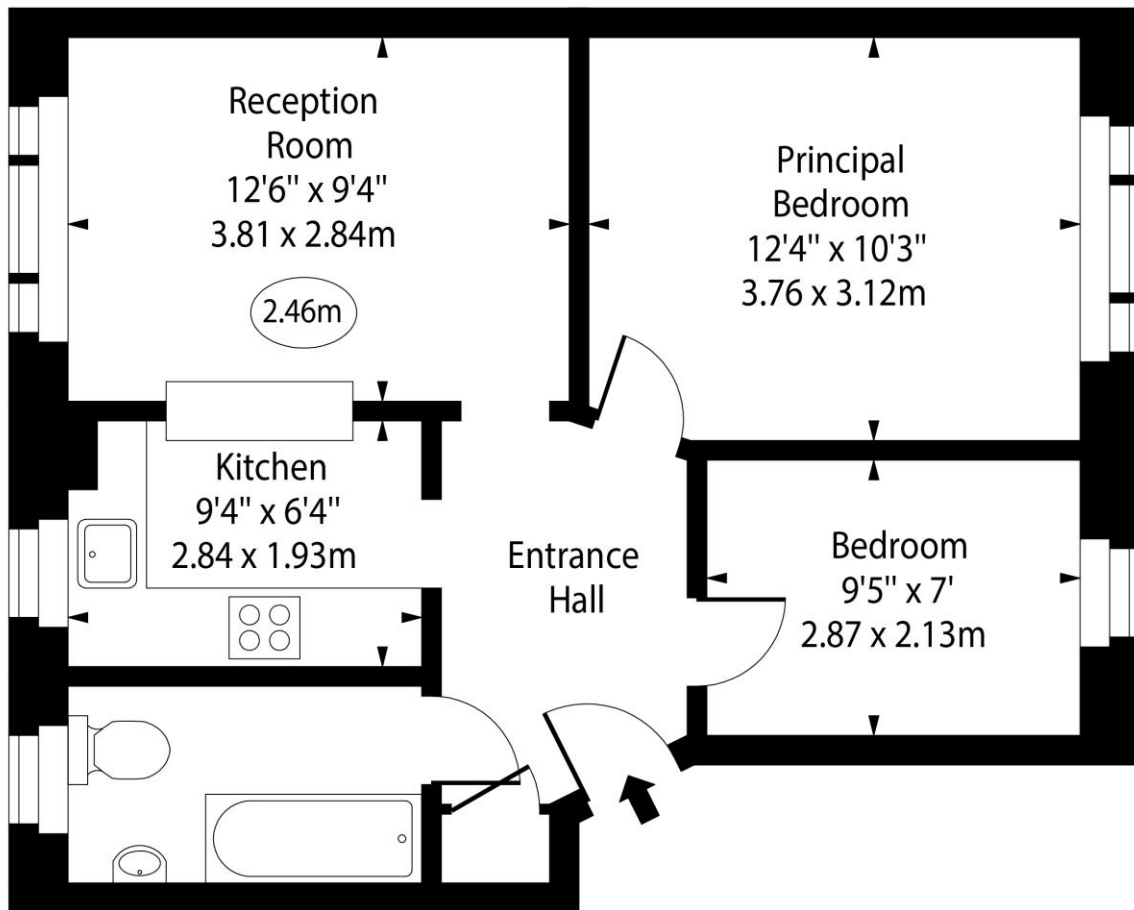

Third Floor

Approx Gross Internal Area 506 Sq Ft - 47.01 Sq M

For Illustration Purposes Only - Not To Scale

www.goldlens.co.uk

Ref. No. 025372E

