

FREEHOLD



House - Semi-Detached (EPC Rating: C)

**32 RICHMOND GATE, HINCKLEY,
LEICESTERSHIRE, LE10 0BW**

£170,000

SETHS

2 1 1 C

2 Bedroom House - Semi-Detached located in Hinckley

**** TRUST ME, YOU NEED TO TAKE A LOOK ****

Seths are delighted to present this charming 2 Bedroom Semi-Detached Home on Richmond Gate, Hinckley.

A fantastic opportunity for first-time buyers, investors, or young couples, this property is perfectly located within easy reach of Hinckley town centre, excellent bus routes, and offers the best of both rural and urban living.

The ground floor features Bedroom Two (currently utilised as a cosy lounge) along with a downstairs WC. Upstairs, you are greeted by a spacious open-plan kitchen/living area with a breakfast bar, a large main bedroom with fitted wardrobes and a 4-piece suite bathroom.

Outside, the property is equipped with allocated parking for 2 vehicles and a flora full garden.

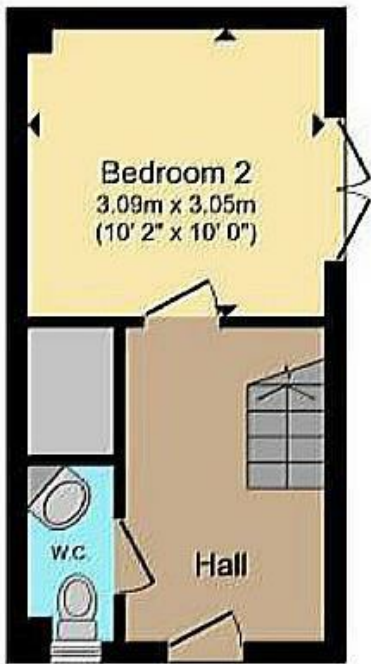

Ground Floor



First Floor

Council Tax Band

B

Energy Performance Graph

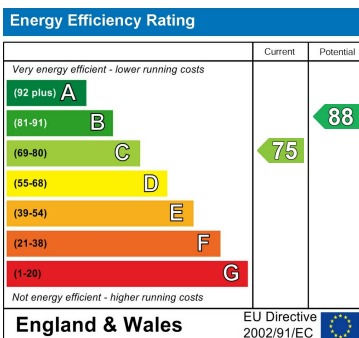

Call us on

0116 266 9977

sales@seths.co.uk

www.seths.co.uk

Agents Note: Whilst every care has been taken to prepare these particulars, they are for guidance purposes only. All measurements are approximate and are for general guidance purposes only and whilst every care has been taken to ensure their accuracy, they should not be relied upon and potential buyers are advised to recheck the measurements.