

for sale

£350,000



## North Lane Canterbury CT2 7EE

This well presented, three to four bedroom home is offered to the market with no onward chain. Ready to move in to, the property is ideal for a growing family with flexible accommodation including a spacious lounge, separate dining room, kitchen, shower room, two double bedrooms and family bathroom.



# North Lane Canterbury CT2 7EE

## Lounge Dining Room

10' 9" x 9' 4" ( 3.28m x 2.84m )

## Cloakroom

Understairs cloak with WC

## Kitchen

10' 5" x 8' 6" ( 3.17m x 2.59m )

Modern fitted kitchen with matching wall and base units, sink and drainer and space for white goods.

## Lounge / Bedroom One

16' 7" Max x 9' 1" Max ( 5.05m Max x 2.77m Max )

## Ground Floor Shower Room

Shower cubicle, WC and wash hand basin

## Landing

## Bedroom Two

9' 3" x 9' ( 2.82m x 2.74m )

## Bedroom Three

10' 10" x 9' 3" ( 3.30m x 2.82m )

## Bedroom Four

10' 10" x 9' 3" ( 3.30m x 2.82m )

## Bathroom

Bath, WC and wash hand basins









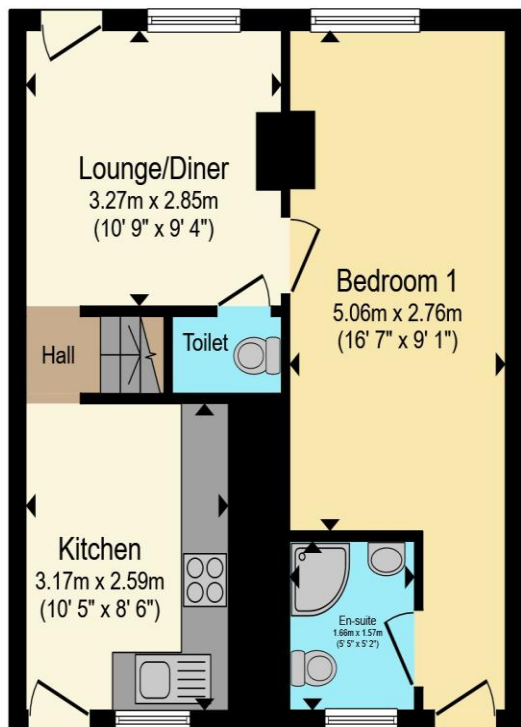

**Ground Floor**

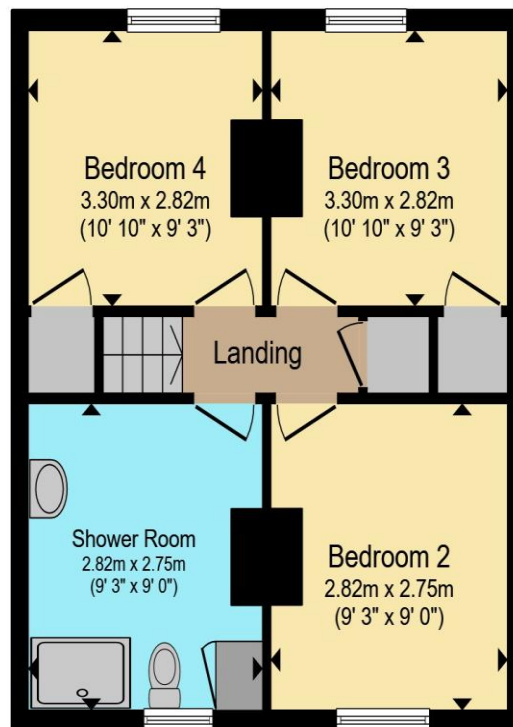

**First Floor**

Total floor area 86.1 m<sup>2</sup> (926 sq.ft.) approx

This floor plan is for illustrative purposes only. It is not drawn to scale. Any measurements, floor areas (including any total floor area), openings and orientation are approximate. No details are guaranteed, they cannot be relied upon for any purpose and they do not form part of any agreement. No liability is taken for any error, omission or misstatement. A party must rely upon its own inspection(s). Powered by www.propertybox.io



To view this property please contact Connells on

**T 01227 764 720**  
**E canterbury@connells.co.uk**

29-30 Watling Street  
CANTERBURY CT1 2UD

Property Ref: CBY407231 - 0002

Tenure:Freehold EPC Rating: C

Council Tax Band: C

**view this property online**  
**connells.co.uk/Property/CBY407231**



1. MONEY LAUNDERING REGULATIONS Intending purchasers will be asked to produce identification documentation at a later stage and we would ask for your co-operation in order that there will be no delay in agreeing the sale. 2. These particulars do not constitute part or all of an offer or contract. 3. The measurements indicated are supplied for guidance only and as such must be considered incorrect. Potential buyers are advised to recheck measurements before committing to any expense. 4. We have not tested any apparatus, equipment, fixtures, fittings or services and it is in the buyers interest to check the working condition of any appliances.

Connells Residential is registered in England and Wales under company number 1489613, Registered Office is Cumbria House, 16-20 Hockliffe Street, Leighton Buzzard, Bedfordshire, LU7 1GN. VAT Registration Number is 500 2481 05.

see all our properties at [www.connells.co.uk](http://www.connells.co.uk) | [www.rightmove.co.uk](http://www.rightmove.co.uk) | [www.zoopla.co.uk](http://www.zoopla.co.uk)