



Elder Court, Mead Lane, Hertford, SG13 7GD

Welcome to Elder Court Mead Lane, Hertford

A bright and spacious two-bedroom top floor apartment ideally situated just a stone's throw from Hertford East railway station, Hertford town centre, Hartham Common, well-regarded local schools and a variety of shops and amenities. Beautifully presented throughout, the property offers contemporary open-plan living with a stylish kitchen/living/dining room featuring built-in appliances and large front-facing windows that flood the space with natural light. The apartment further comprises two generous double bedrooms, both benefiting from fitted wardrobes, along with a modern family bathroom finished to a high standard. Additional benefits include double glazing, electric heating and allocated parking, making this an ideal purchase for first-time buyers, commuters or investors alike.



-Accommodation Overview-

Communal Entrance

Lift to all floors.

Entrance Hall

Open Plan Kitchen / Lounge / Diner

20' 6" x 14' 1" (6.25m x 4.29m)

Kitchen Area

Bedroom One

17' 7" x 9' 10" into wardrobe (5.36m x 3.00m into wardrobe)

Bedroom Two

13' 2" x 9' 5" (4.01m x 2.87m)

Bathroom

-Exterior-

Parking:

One allocated underground parking space.

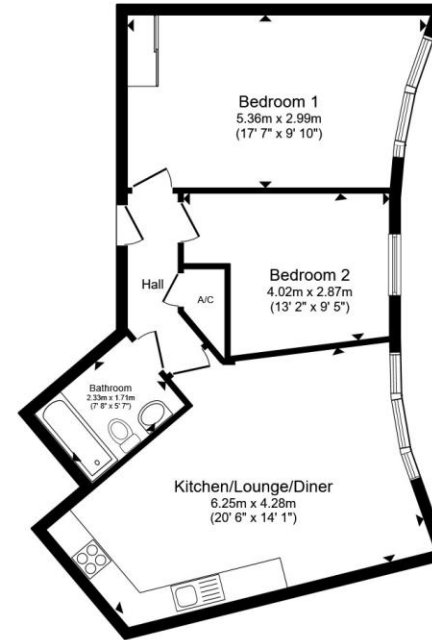

Total floor area 64.9 m² (699 sq.ft.) approx

This floor plan is for illustrative purposes only. It is not drawn to scale. Any measurements, floor areas (including any total floor area), openings and orientation are approximate. No details are guaranteed, they cannot be relied upon for any purpose and they do not form part of any agreement. No liability is taken for any error, omission or misstatement. A party must rely upon its own inspection(s). Powered by www.propertybox.io



view this property online williamhbrown.co.uk/Property/HFD108306



Welcome to Elder Court Mead Lane, Hertford

- ****Riverside Development****
- Open Plan Living & Fitted Modern Kitchen
- Family Bathroom
- Great Location For Hertford East Train Station
- One Allocated Underground Parking Space

Tenure: Leasehold

EPC Rating: C

Council Tax Band: D

Service Charge: £2400.00 Yearly

Ground Rent: £700.00 Yearly

This is a Leasehold property with details as follows; Term of Lease 125 years from 01 Jan 2009. Should you require further information please contact the branch. Please Note additional fees could be incurred for items such as Leasehold packs.

£255,000



Please note the marker reflects the postcode not the actual property

view this property online williamhbrown.co.uk/Property/HFD108306



Property Ref:
HFD108306 - 0001

1. MONEY LAUNDERING REGULATIONS Intending purchasers will be asked to produce identification documentation at a later stage and we would ask for your co-operation in order that there is no delay in agreeing the sale. 2. These particulars do not constitute part or all of an offer or contract. 3. The measurements indicated are supplied for guidance only and as such must be considered incorrect. Potential buyers are advised to recheck measurements before committing to any expense. 4. We have not tested any apparatus, equipment, fixtures or services and it is in the buyers interest to check the working condition of any appliances. 5. Where an EPC, or a Home Report (Scotland only) is held for this property, it is available for inspection at the branch by appointment. If you require a printed version of a Home Report, you will need to pay a reasonable production charge reflecting printing and other costs. 6. We are not able to offer an opinion either written or verbal on the content of these reports and this must be obtained from your legal representative. 7. Whilst we take care in preparing these reports, a buyer should ensure that his/her legal representative confirms as soon as possible all matters relating to title including the extent and boundaries of the property and other important matters before exchange of contracts.

William H Brown is a trading name of Sequence (UK) Limited which is registered in England and Wales under company number 4268443, Registered Office is Cumbria House, 16-20 Hockliffe Street, Leighton Buzzard, Bedfordshire, LU7 1GN. VAT Registration Number is 500 2481 05.



william h brown



01992 586501



Hertford@williamhbrown.co.uk



21 Castle Street, HERTFORD, Hertfordshire,
SG14 1ER



williamhbrown.co.uk