



Hockers Lane, Detling, Maidstone, Kent, ME14 3JL

Price Guide £450,000



Situated on a sought-after road in Detling and also within easy reach of both Hollingbourne and Bearsted villages. The property occupies a generous plot and having been loving maintained but largely untouched in recent years, it presents a very interesting proposition for anyone looking for a refurbishment project.

The accommodation is generous and versatile, the space available can be used in various ways to suit the needs of the buyer. To the front of the property is a spacious driveway with plenty of room for several vehicles. The porch takes us into the central entrance hall, to the left is the office which can also be used as a fourth bedroom, to the right is the dining room with an archway leading through to the living room, the kitchen leads into a third reception room and the already spacious living accommodation further benefits from a large conservatory.

Going upstairs we find the well proportioned principal bedroom which is light and airy and benefits from fitted wardrobes, the second bedroom is also a good-sized double with the third bedroom being a good single. The first floor accommodation is completed by the family bathroom.

The property further benefits from a garage and workshop and the lovely garden is a generous but manageable size, providing a lovely environment to enjoy the warmer months.

With the tremendous advantage of having no onwads chain, this property is sure to attract a lot of interest, we recommend your earliest possible viewing.

Tenure: Freehold. Council tax band: E. EPC rating: D



## LOCATION

Detling is within close proximity of the North Downs, Horish Wood, Pilgrims Way and Thurnham Castle; perfect for nature lovers. Bearsted mainline station is conveniently located just one mile away, offering an easy commute into London and Ashford International, whilst the M2 & M20 motorways are conveniently close. Detling Village offers a variety of amenities including a shop, playground, pub, church, village hall and cricket ground.

## ACCOMMODATION

### Ground Floor

Porch

Entrance Hall

Office/Bedroom Four

Dining Room

Living Room

Kitchen

Reception Room

Conservatory

FIRST FLOOR

Principal Bedroom

Bedroom Two

Bedroom Three

EXTERNALLY

Driveway

Garage

Workshop

Rear Garden

VIEWINGS

Strictly by arrangement with the Agent's Bearsted Office, 132 Ashford Road, Bearsted, Maidstone, Kent ME14 4LX . Tel: 01622 739574.

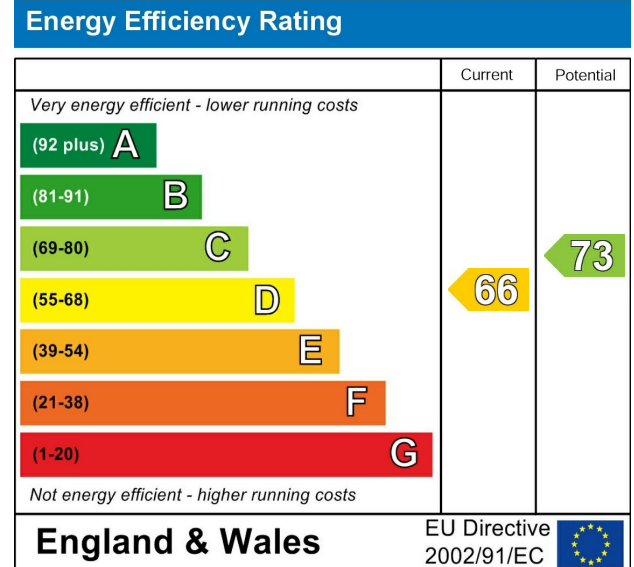

Page & Wells limited for themselves and for the vendors of this property whose agents they are give notice that: 1. These particulars do not constitute any part of, an offer or a contract. 2. All statements contained in these particulars as to this property are made without responsibility on the part of Page & Wells Limited or the Vendor. 3. None of the statements contained in these particulars as to the property is to be relied on as statements or representations of fact. 4. Any intending purchaser must satisfy himself by inspection or otherwise as to the correctness of each of the statements contained in these particulars. 5. The vendor does not make or give, and neither Page & Wells Limited nor any person in their employment has any authority to make or give any representation whatsoever in relation to this property. These particulars are supplied on the understanding that all negotiations are carried out throughout Page & Wells Limited. Properties with a reference prefixes EAA are those which Page & Wells Limited disclose an interest in accordance with the provisions of the Estates Agents Act 1979

**Hockers Lane, Detling, Maidstone**  
**Approximate Gross Internal Area**  
**Main House = 1752 Sq Ft/163 Sq M**  
**Garage & Workshop = 485 Sq Ft/45 Sq M**  
**Total = 2237 Sq Ft/208 Sq M**

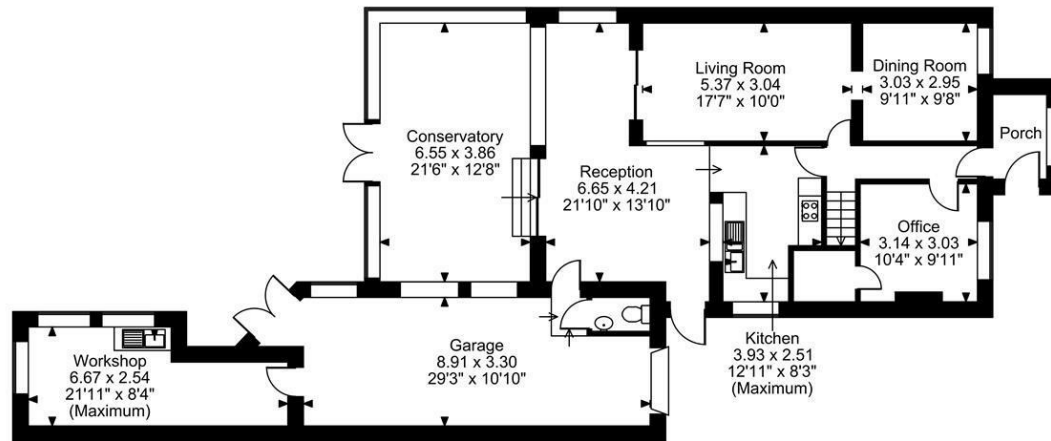
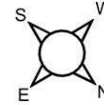

**Ground Floor**

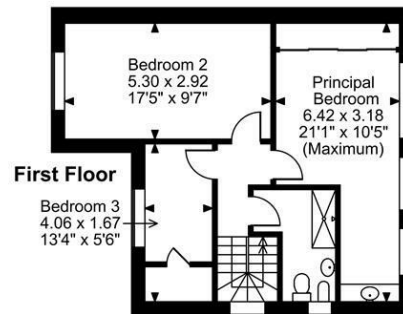

**First Floor**

**FOR ILLUSTRATIVE PURPOSES ONLY - NOT TO SCALE**

The position & size of doors, windows, appliances and other features are approximate only.

© ehouse. Unauthorised reproduction prohibited. Drawing ref. dig/8696240/MJH

