



**13 Boulters Gardens, Maidenhead SL6 8TR**

**welcome to**

**13 Boulders Gardens, Maidenhead**

A three bedroom, two bathroom end of terrace townhouse set within an exclusive private gated development on the riverside of town, offering a superb blend of convenience, space and privacy.



# Boulters Gardens, Maidenhead, SL6

Approximate Area = 1316 sq ft / 122.2 sq m

Garage = 176 sq ft / 16.3 sq m

Total = 1492 sq ft / 138.5 sq m

For identification only - Not to scale

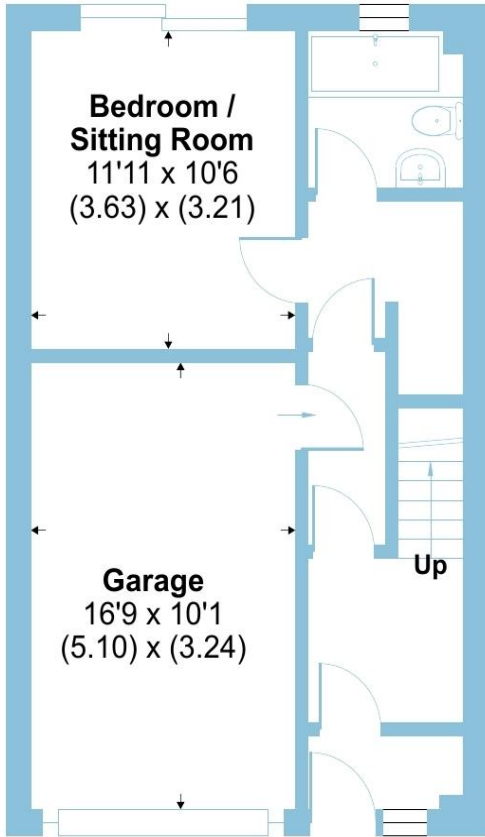

**GROUND FLOOR**

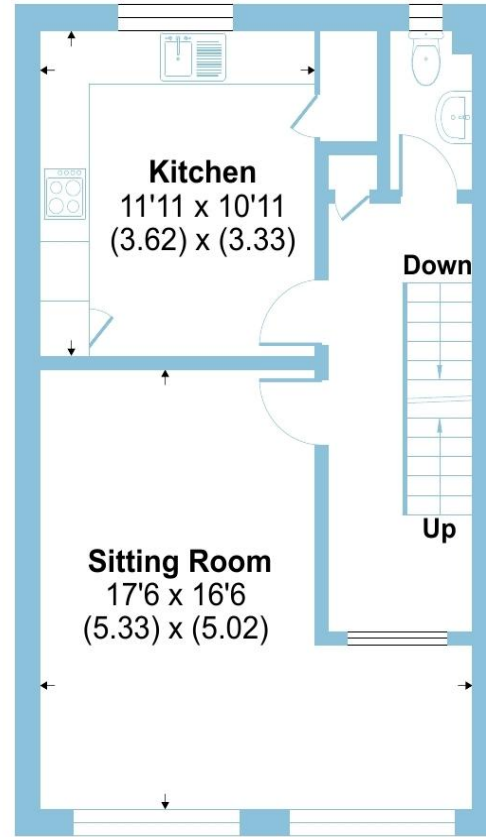

**FIRST FLOOR**

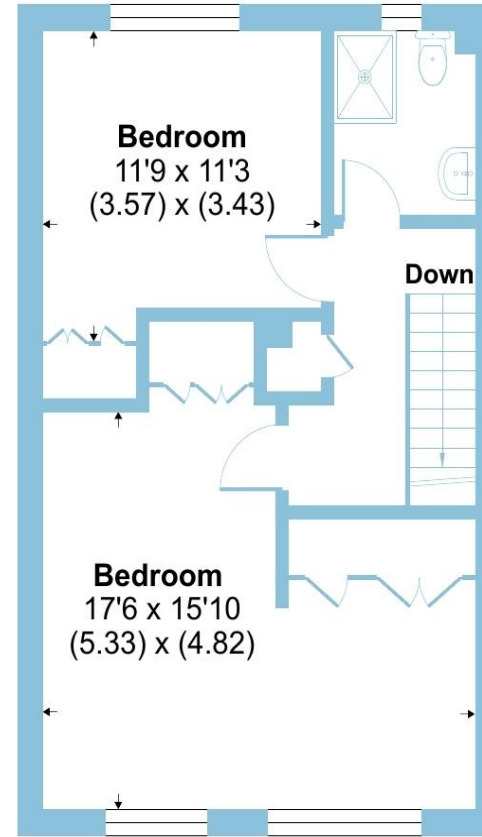

**SECOND FLOOR**

The property is accessed via an enclosed entrance porch, opening into a versatile ground floor layout that includes a well-proportioned bedroom, a modern bathroom, internal access to the garage and stairs rising to the upper levels.

The first floor features a bright and generous living/dining room, ideal for both relaxing and entertaining, alongside a contemporary fitted kitchen and a useful cloakroom. On the top floor, the standout principal bedroom measures an impressive 17' x 15', complete with built-in wardrobes. A further double bedroom and the family bathroom complete this level.

Outside, the rear garden provides a delightful outdoor retreat, with a patio area perfect for dining, a lawn for low-maintenance enjoyment, and fencing for privacy - A side gate offers convenient access and to the front, there is a driveway leading to the garage.

Boulters Gardens is a highly sought-after location, set behind electronic gates and within easy reach of the town centre and the River Thames, making it ideal for those seeking security, lifestyle and excellent local amenities.

welcome to

## 13 Boulders Gardens, Maidenhead

- END TERRACE TOWN HOUSE
- THREE BEDROOMS
- TWO BATHROOMS
- SECURE PRIVATE GATED DEVELOPMENT
- OWN DRIVE TO GARAGE
- RIVER SIDE OF TOWN
- EASY ACCESS TO TOWN CENTRE & STATION
- CLOSE TO LOCAL SCHOOLS

Tenure: Freehold EPC Rating: C

Council Tax Band: E

**£550,000**



Please note the marker reflects the postcode not the actual property

check out more properties at [rogerplatt.co.uk](http://rogerplatt.co.uk)



Property Ref:  
MHD123566 - 0004

1. MONEY LAUNDERING REGULATIONS Intending purchasers will be asked to produce identification documentation at a later stage and we would ask for your co-operation in order that there is no delay in agreeing the sale. 2. These particulars do not constitute part or all of an offer or contract. 3. The measurements indicated are supplied for guidance only and as such must be considered incorrect. Potential buyers are advised to recheck measurements before committing to any expense. 4. We have not tested any apparatus, equipment, fixtures or services and it is in the buyers interest to check the working condition of any appliances. 5. Where an EPC, or a Home Report (Scotland only) is held for this property, it is available for inspection at the branch by appointment. If you require a printed version of a Home Report, you will need to pay a reasonable production charge reflecting printing and other costs. 6. We are not able to offer an opinion either written or verbal on the content of these reports and this must be obtained from your legal representative. 7. Whilst we take care in preparing these reports, a buyer should ensure that his/her legal representative confirms as soon as possible all matters relating to title including the extent and boundaries of the property and other important matters before exchange of contracts.

Roger Platt is a trading name of Sequence (UK) Limited which is registered in England and Wales under company number 4268443, Registered Office is Cumbria House, 16-20 Hockliffe Street, Leighton Buzzard, Bedfordshire, LU7 1GN. VAT Registration Number is 500 2481 05.

  
roger platt



**01628 773333**



Maidenhead@rogerplatt.co.uk



25-29 Queen Street, MAIDENHEAD, Berkshire,  
SL6 1NB



**rogerplatt.co.uk**