



# BECKY'S FARM

Raydon



Suffolk



Chapman Stickers



# BECKY'S FARM, WOODLANDS ROAD, RAYDON, SUFFOLK, IP7 5QD

Hadleigh – 3.5 miles  
Manningtree Station – 7.5 miles  
Ipswich – 8 miles  
Colchester – 14 miles

## The bungalow

- Entrance hall • Kitchen / breakfast room • Sitting room with dining area •  
• Inner hall • Three double bedrooms • Family bathroom • Boiler room •

Detached Games room – 59sq.m (636sq.ft)

Detached Barn (with office area and stores) – 172sq.m (1,850sq.ft)

Further outbuilding / former cottage – 22sq.m (237sq.ft)

## The Property

Occupying a wonderfully secluded setting in the rural parish of Raydon, Becky's Farm is located some 3.5 miles south of Hadleigh.

The principal dwelling is individual and single storey, which is likely to date from the early-1700's, with later alterations. A recent extension forms the main entrance hall and adjacent dining area, where the latter takes full advantage of the views over the southern part of the garden, with arable farmland beyond.

Offering similar delightful views, the twin aspect kitchen / breakfast room is comprehensively fitted with granite worksurfaces, numerous base and eye level units and integral appliances including an electric range cooker. The adjacent sitting room provides a working open fireplace, set either side of windows to the western aspect.

Via a central corridor, the three bedrooms and family bathroom comprises the remaining accommodation. Again, all well-proportioned rooms provide their respective views over the gardens - which surround the bungalow on all sides.

Outside, the bungalow is set well back in its generous plot, where a sweeping gravel drive leads to a rear parking area with the principal outbuildings beyond. The main gardens comprise areas of lawn which are interspersed with mature trees and shrubs, with an outdoor pool to the southwestern corner. Located beyond an ornamental pond, a deciduous copse which forms the entire northern section of the property.

Outbuildings include two substantial detached barns to the west (including a games room) with additional garaging / office / storage space. To the approach of the property via Woodland Road (east) is a plaster and tiled outbuilding (the cottage) which is likely to date from the early 1800's.

# A UNIQUE RURAL PROPERTY COVERING SOME 2.5 ACRES OF SECLUDED GARDENS AND WOODLAND TOGETHER WITH NUMEROUS OUTBUILDINGS



### Location

Becky's Farm is set in the attractive countryside of south Suffolk, on the eastern edge village of Raydon village. The locality is close to the market town of Hadleigh, which offers a wide range of day-to-day amenities including a range of shops for everyday needs, primary and secondary schools, a town library, church and swimming pool, together with other recreational facilities including pubs and restaurants.

### EPC Rating

Current E (47). Potential C (71).

### Services

Mains water and electricity are connected. Oil- fired central heating. Private drainage.

### Local Authority and Council Tax

Babergh with Mid Suffolk District Council  
Council Band E (2026)





# Becky's Farm, Woodlands Road, Raydon, Suffolk, IP7 5QD

Approximate Floor Area  
Main House - 1518 sq. ft / 141.05 sq. m

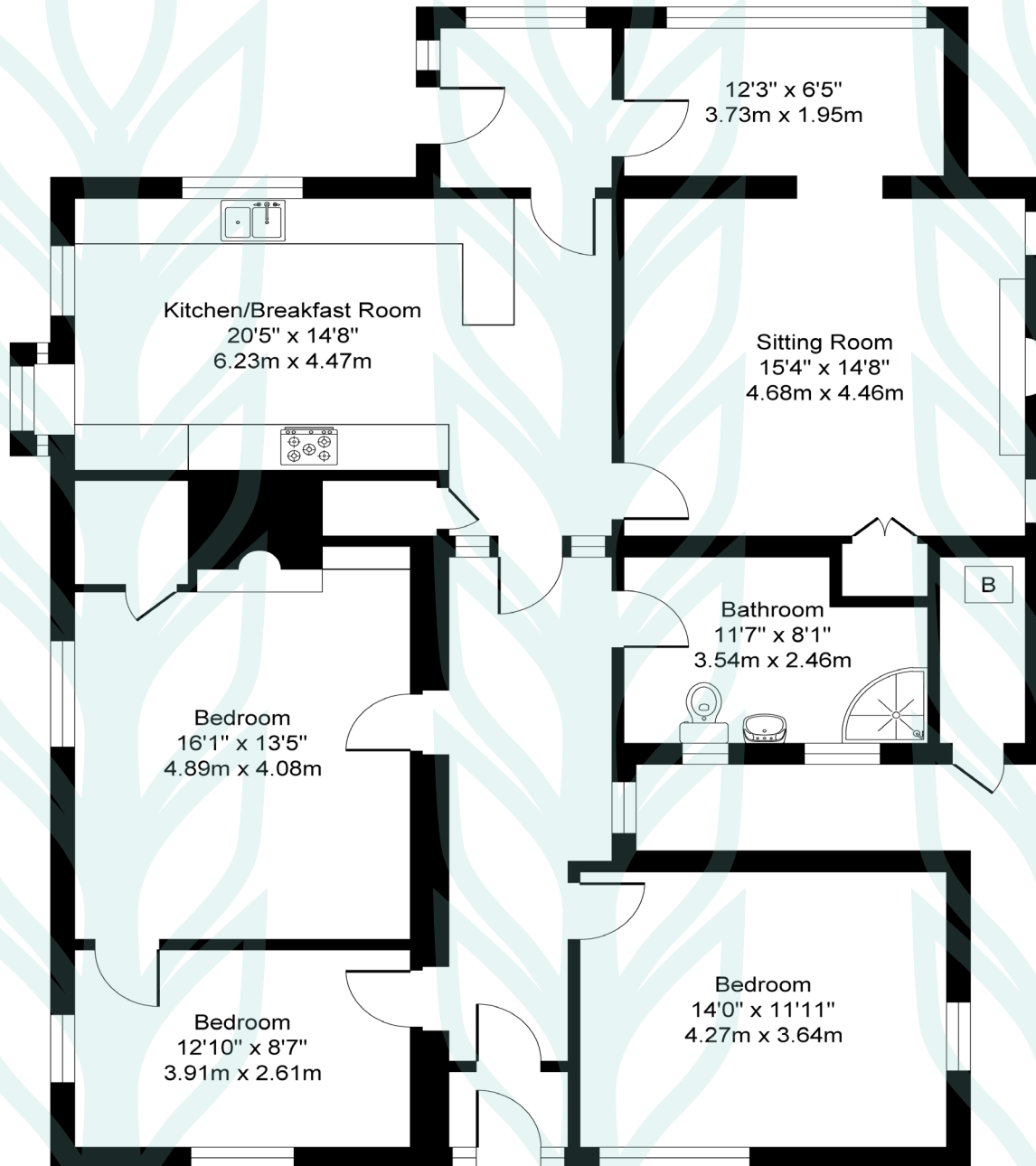

# Becky's Farm, Woodlands Road, Raydon, Suffolk, IP7 5QD

Approximate Floor Area  
Outbuildings - 2764 sq. ft / 256.78 sq. m

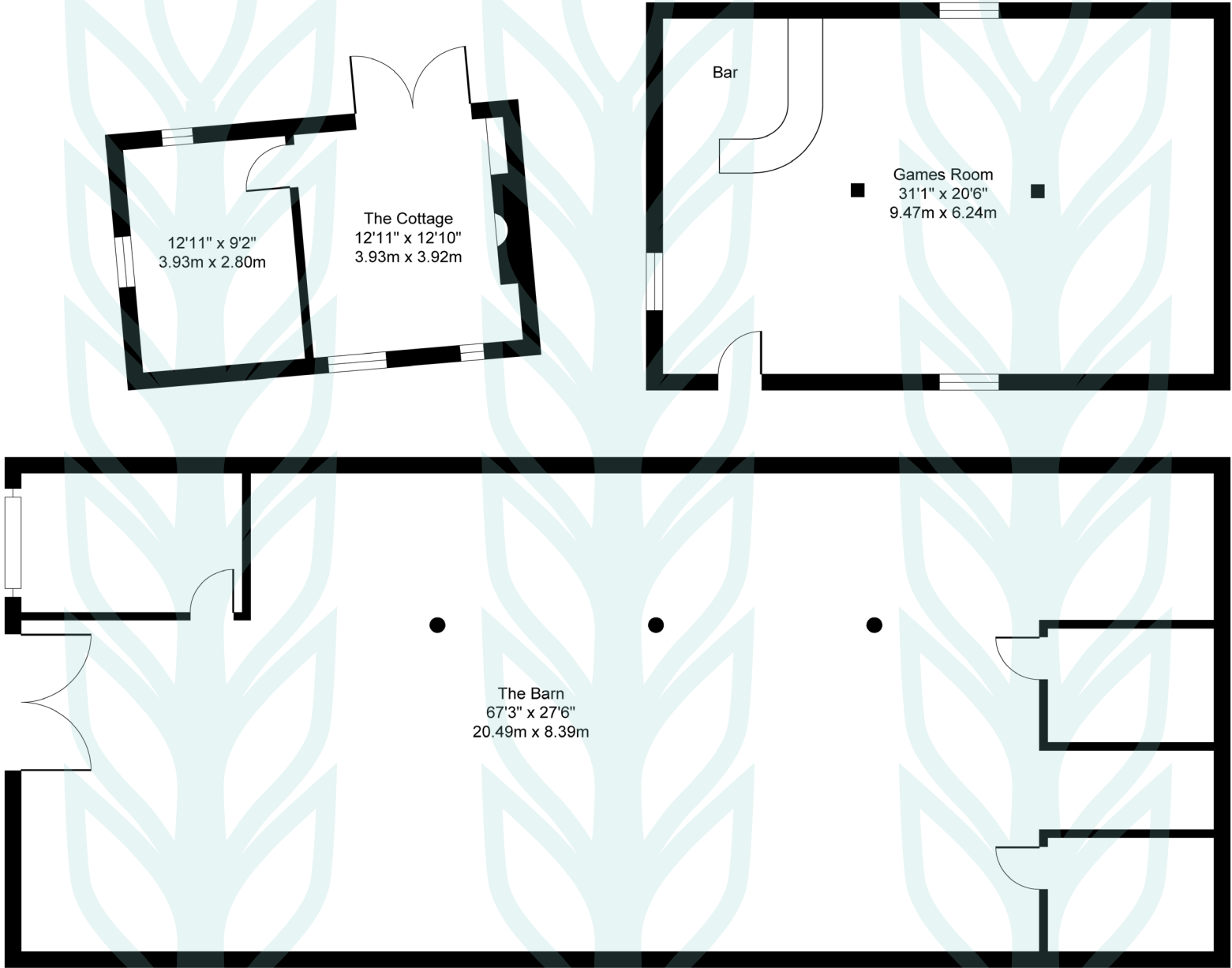

Outbuildings

Illustration for identification purposes only, measurements approximate, not to scale. Copyright

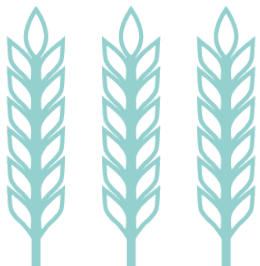

**Chapman Stickels**

The Corn Exchange,  
Market Place,  
Hadleigh,  
Suffolk,  
IP7 5DN

info@chapmanstickels.co.uk  
www.chapmanstickels.co.uk

01473 372 372

**All enquiries:**

**Benedict Stickels**  
ben@chapmanstickels.co.uk

**Cleo Shiel**  
cleo@chapmanstickels.co.uk



Scan the QR code to visit  
our website

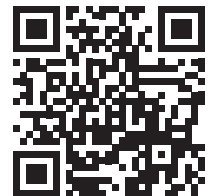

**IMPORTANT NOTICE**

Chapman Stickels states these particulars are for general information only and do not constitute an offer or contract or part thereof. All descriptions, photographs and plans are for guidance only and should not be relied upon as statements or representations of fact. All measurements are approximate where stated. Any prospective purchaser must satisfy themselves of the accuracy of the information within these particulars by inspection or otherwise. Chapman Stickels does not have any authority to give any representations or warranties whatsoever in relation to this property (including but not limited to planning/building restrictions), nor can it enter into any contract on behalf of the client. We do not accept responsibility for any expenses incurred by prospective purchasers in inspecting properties which have been sold, let or withdrawn. If there is anything of particular importance to you, please contact us where we will endeavour to have any information or queries checked.