

## Ground Floor

Approx. 33.2 sq. metres (357.2 sq. feet)

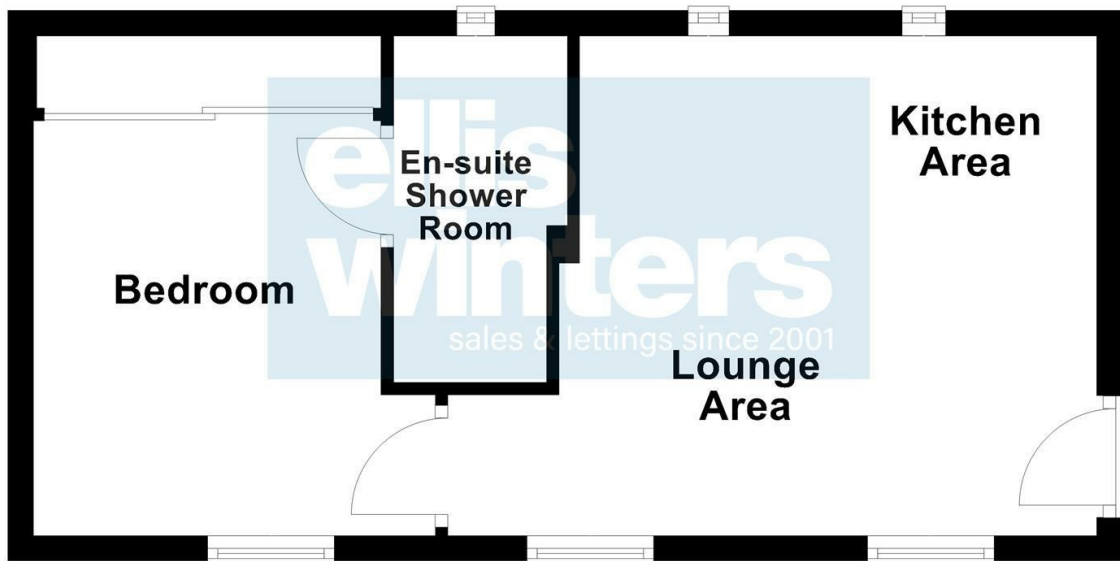

Total area: approx. 33.2 sq. metres (357.2 sq. feet)

GROUND FLOOR  
Communal Entrance door to:

Communal Entrance Hall  
Front door to:

Lounge/Kitchen Area  
5.13m (16'10") max x 3.95m (13')

Bedroom  
3.30m (10'10") x 2.75m (9')

En-suite Shower Room

OUTSIDE  
Off road parking space included.  
Communal outdoor space for residence.

FURTHER INFORMATION  
Deposit: £1,096  
Council Tax Band: TBC  
EPC rating: C  
Minimum household income required to  
pass referencing: £29,250

Disclaimer  
All property details, photographs,  
floorplans, and other marketing  
materials produced by Ellis Winters are  
for general guidance only and do not  
form part of any contract. While we  
strive for accuracy, measurements,  
descriptions, and other information are  
provided in good faith but should be  
independently verified.

Agents Note: Whilst every care has been taken to prepare these particulars, they are for guidance purposes only. All measurements are approximate and are for general guidance purposes only and whilst every care has been taken to ensure their accuracy, they should not be relied upon and potential buyers/tenants are advised to recheck the measurements

**ellis winters**  
sales & lettings since 2001

### OFFICE ADDRESS

14 Market Hill  
St Ives  
Cambridgeshire  
PE27 5AL

### OFFICE DETAILS

01480 388889  
infostives@elliswinters.co.uk  
www.elliswinters.co.uk

**ellis winters**  
sales & lettings since 2001

**£950 PER CALENDAR MONTH**  
**MANCHESTER PLACE**  
HUNTINGDON, PE29 3DP



## PROPERTY SUMMARY

A brand new ground floor apartment, ideally located in the heart of Huntingdon town centre, close to all local amenities and within walking distance of Huntingdon train station. This modern property features an open-plan lounge and kitchen area, a double bedroom with a fitted wardrobe, and a en-suite shower room. Additional benefits include underfloor heating throughout, an off-road parking space, a communal outdoor area, and a secure communal entrance with a touchpad access system. Available immediately. Deposit: £1,096

1



1



1

