

LANES

SALES & LETTINGS

Joanna Bufton
Lettings Consultant

LANES

SALES & LETTINGS

Tel: 01908 508037

Email: Joanna@lanesmk.co.uk



109 Bushy Close, Bletchley, Milton Keynes, Buckinghamshire, MK3 6PX

Lanes are delighted to offer for rent this three-bedroom end-of-terrace house.

The accommodation briefly comprises an entrance hall, living room, kitchen with white goods, dining area, two double bedrooms, one single bedroom, and a family bathroom.

Externally, the property benefits from an enclosed rear garden, which provides access to a single garage and an off-road parking space.

Located in Bletchley, the property is within walking distance of local schools, shops, bus routes, parks, and other amenities.

Council Tax Band: B
Available: End of August
Professionals Only

- End Of Terrace House
- Rear Garden
- Council Tax Band B
- Professionals Only
- Three Bedrooms
- Single Garage
- White Goods
- Dining Area
- Off Road Parking
- Available End of August

£1,450 Per Month

109 Bushy Close, Bletchley, Milton Keynes, Buckinghamshire, MK3 6PX
 16032215
 £1,450 Per Month

Ground Floor

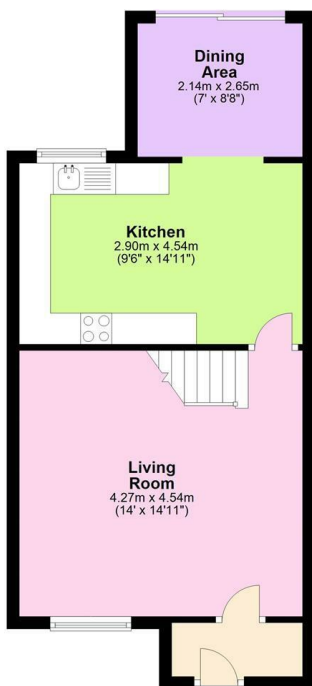

First Floor



Ground Floor

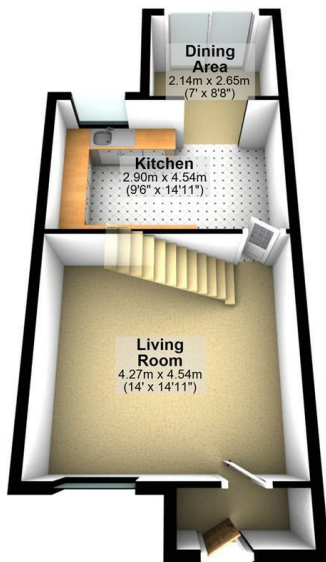

First Floor



Energy Efficiency Rating		Current	Potential
Very energy efficient - lower running costs			
(92 plus) A			
(81-91) B			
(69-80) C			
(55-68) D			
(39-54) E			
(21-38) F			
(1-20) G			
Not energy efficient - higher running costs			
England & Wales		71	78
EU Directive 2002/91/EC			

Environmental Impact (CO ₂) Rating		Current	Potential
Very environmentally friendly - lower CO ₂ emissions			
(92 plus) A			
(81-91) B			
(69-80) C			
(55-68) D			
(39-54) E			
(21-38) F			
(1-20) G			
Not environmentally friendly - higher CO ₂ emissions			
England & Wales			
EU Directive 2002/91/EC			