



## **One Bedroom Luxury Apartment Bodman House, Kingston upon Thames £389,999 Leasehold**

**Stunning Light bright and airy 1 bedroom apartment situated on the 1st floor of the Riverside Place development, located between Kingston's historic Market Place and the River Thames**

This extremely desirable modern development is elegantly designed to the very highest specification offering a fully equipped kitchen which benefit from Bosch appliances and with quartz work tops. A luxurious sumptuous bathroom offering a very high standard with design features such as matt black Crosswater Mpro taps, wall and floor ceramic tiling.

Situated within a stone's throw of the River Thames and local amenities & sold with no onward chain

[WWW.STACKANDBONNER.COM](http://WWW.STACKANDBONNER.COM)

020 8547 1234

[sales@stackandbonner.com](mailto:sales@stackandbonner.com)



## Bodman House, Bishops Hall, KT1

Approximate Gross Internal Area  
51.34 sq m / 553 sq ft

( CH = Ceiling Heights)

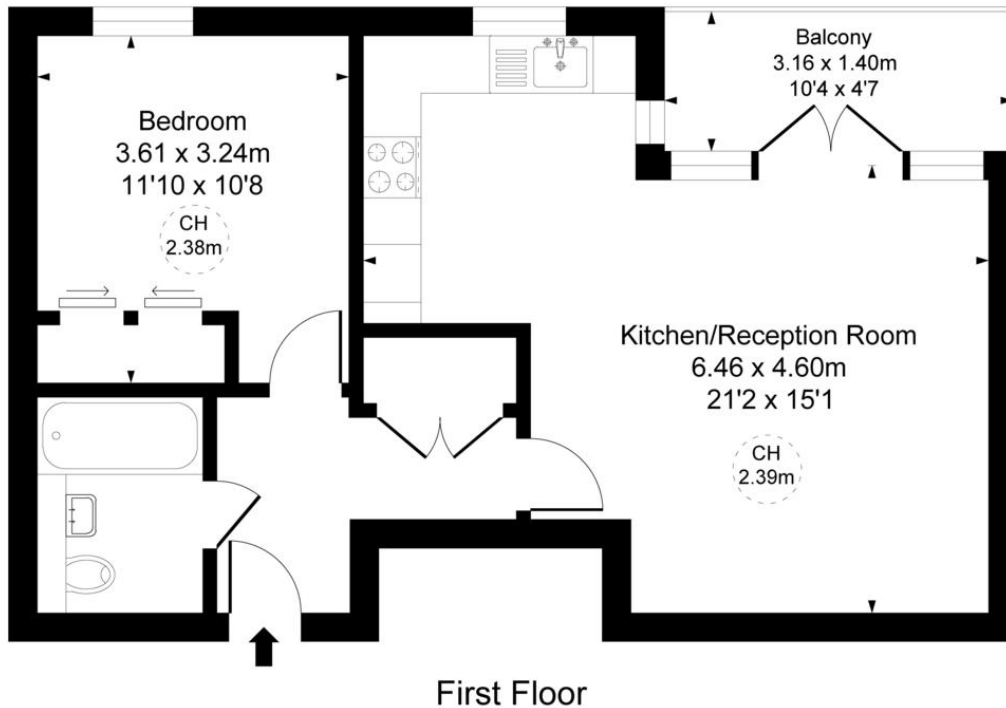

This plan is not to scale. It is for guidance and not for valuation purposes.  
All measurements and areas are approximate only, and have been prepared in accordance with the current edition of the RICS Code of Measuring Practice.

- One Double Bedroom Luxury Apartment
- High Specification Fitted Kitchen with Built In Appliances
- Luxurious Fitted Bathroom Suite
- South Facing Private Balcony
- 541 Sq. ft of Living Space
- 1st Floor Apartment
- Service Charge £2,176.30
- Lease: 245 Years Remaining
- Sold With No Onward Chain
- Viewings are Highly Recommended