



6 Furman Close, Onchan, Isle Of Man, IM3 1BT
Asking Price £369,950

- Modern and beautifully presented three bedroom semi-detached home
 - Three well-proportioned bedrooms and contemporary family bathroom
- Bright and welcoming living accommodation throughout
 - Off-road parking to the front
- Stylish modern kitchen/dining area with access to the garden
 - Sunny, enclosed rear garden ideal for relaxing or entertaining



6 Furman Close is a beautifully presented modern three-bedroom semi-detached home, perfectly positioned in a convenient and well-regarded residential location. This attractive property has been thoughtfully maintained and styled throughout, making it an ideal turnkey option for first-time buyers, young families or those seeking a low-maintenance home with contemporary appeal.

The accommodation is bright, welcoming and well balanced. On the ground floor, the entrance hall leads through to a comfortable living room, ideal for relaxing evenings or entertaining guests. To the rear, a modern kitchen and dining space forms the heart of the home, offering excellent storage, clean modern finishes and direct access out to the garden — perfect for everyday family life and summer entertaining alike.

Upstairs, the property offers three well-proportioned bedrooms, all presented in excellent decorative order and offering flexibility for family living, home working or guest accommodation. The family bathroom is modern and well appointed, completing the internal layout.

Externally, the home continues to impress. To the front, off-road parking provides convenience and ease of access. To the rear, a lovely sunny garden offers a private and secure outdoor space, ideal for children, pets or simply enjoying long summer evenings. The garden has been designed for ease of maintenance while still providing plenty of space to relax or entertain.

Situated within easy reach of local amenities, schools and transport links, 6 Furman Close combines modern living with everyday practicality. A superb opportunity to acquire a stylish, well-located home that is ready to move straight into.













6 Furman Close, Onchan, Isle Of Man, IM3 1BT



GROUND FLOOR
463 sq.ft. (43.0 sq.m.) approx.

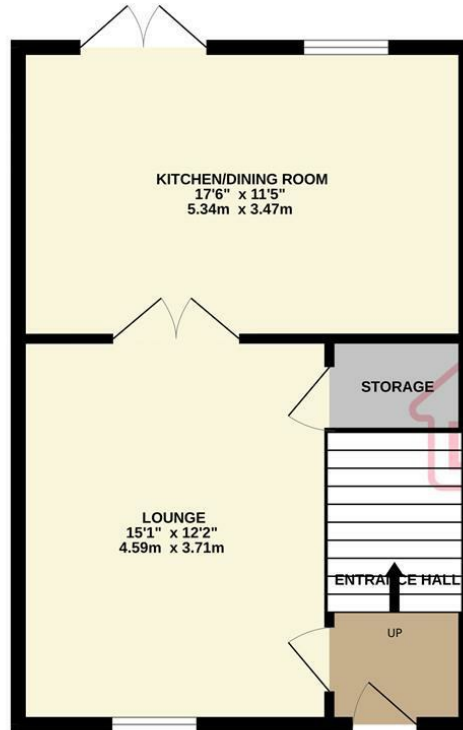

1ST FLOOR
463 sq.ft. (43.0 sq.m.) approx.



TOTAL FLOOR AREA : 926 sq.ft. (86.0 sq.m.) approx.
Not to scale-for identification purposes only
Made with Metropix ©2025

DOUGLAS

37 VICTORIA STREET
DOUGLAS
ISLE OF MAN IM1 2LF

T 01624 620606
F 01624 677363
E info@deanwood.co.im

CASTLETOWN

COMPTON HOUSE
9 CASTLE STREET CASTLETOWN
ISLE OF MAN IM9 1LF

T 01624 825995
F 01624 825996
E castletown@deanwood.co.im

RAMSEY

LEZAYRE HOUSE
87 PARLIAMENT STREET
RAMSEY ISLE OF MAN IM8 1AQ

T 01624 816111
F 01624 816588
E ramsey@deanwood.co.im

These particulars are for information purposes only. They do not constitute or form any contract nor should any statement contained herein be relied upon as a representation of fact. Neither the vendor nor DeanWood Agencies Limited ('the firm'), nor any officer or employee of the firm accept liability or responsibility for any statement contained herein. The vendor does not by these particulars, nor does the firm, nor does any officer or any employee of the firm have any authority to make or give any representation or warranty whatsoever as regards the property or otherwise. It is the sole responsibility of any person interested in the property described in these particulars to make all proper enquiries and searches to verify the description of the property and all other particulars herein.

FOR MORE PROPERTIES VISIT OUR WEBSITE @ deanwood.im