



Clifton Court

Northwick Terrace, NW8

Asking Price £650,000

Positioned on the third floor of this ever popular purpose built block is this charming and bright two bedroom apartment spanning approximately 810 square feet.

Benefitting from access to a wonderful communal gardens, the accommodation comprises a spacious reception room, two large double bedrooms, eat in kitchen and large bathroom.

Situated on Northwick Terrace, between Maida Vale and St John's Wood, the apartment is ideally located only a short walk from the fantastic array of local amenities on Clifton Road and St John's Wood high street. Clifton Court also boasts excellent proximity to fantastic transport links including Maida Vale, Warwick Avenue (Bakerloo line) and St John's Wood (Jubilee line) Underground Stations and Paddington Station with its national and international connections.

CHESTERTONS



Clifton Court

Northwick Terrace, NW8

- A charming 3rd floor (walk up) two bedroom apartment spanning approx, 810 square feet.
- Benefitting from abundant natural light and far reaching views.
- The apartment comes with a share in the freehold and an exceptionally long underlying lease.
- A communal garden can be viewed and access by the apartment.



Tenure: Share of Freehold 973 years 9 months

Service Charge: £5,116.96 pa

Ground Rent: £0

Local Authority: City of Westminster

Council Tax Band: F

Score	Energy rating	Current	Potential
92+	A		
81-91	B		
69-80	C		76 C
55-68	D	58 D	
39-54	E		
21-38	F		
1-20	G		

Chestertons Little Venice Sales

26 Clifton Road

Maida Vale

London

W9 1SX

littlevenice@chestertons.co.uk

020 7286 4632

chestertons.co.uk

Clifton Court,
Northwick Terrace, NW8

○ - Ceiling Height

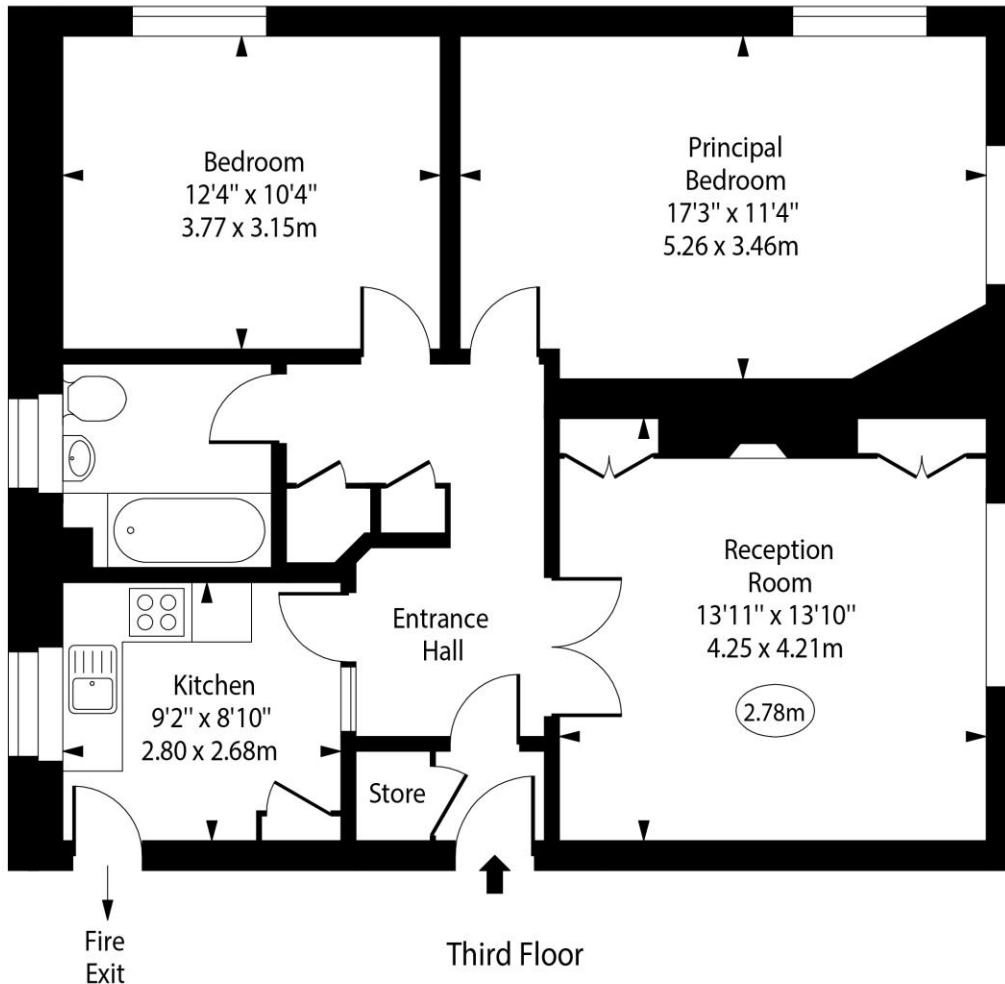

Approx Gross Internal Area 811 Sq Ft - 75.34 Sq M

Every attempt has been made to ensure the accuracy of the floor plan shown.
However, all measurements, fixtures, fittings, and data shown are approximate interpretations and
for illustrative purposes only. Measured according to the RICS. Not To Scale.

www.goldlens.co.uk
Ref. No. 030506D