



Chads Cottage, Old Turnpike Road, Roughton - NR11 8SP

£295,000 Freehold

Chain-free • Charming period cottage in the sought-after village of Roughton • Peaceful setting close to the North Norfolk coastline and countryside • Characterful interiors with bright, welcoming living spaces • Private outdoor space ideal for relaxing or entertaining • Ideal as a permanent home, weekend retreat or investment opportunity

henleys
ESTATE AGENCY SIMPLIFIED

01263 511111
cromer@henleyshomes.co.uk

Set within the peaceful North Norfolk village of Roughton, this is a charming period home that perfectly balances character and comfort. Tucked away on Old Turnpike Road, the property enjoys a wonderfully private feel, while remaining within easy reach of the coastline, nearby market towns and countryside walks. Thoughtfully arranged throughout, the cottage offers inviting living spaces filled with warmth and natural light, creating a home equally suited to relaxed everyday living or an idyllic weekend retreat.

The accommodation flows beautifully, with a welcoming atmosphere that reflects the cottage's heritage and setting. Outside, the property continues to impress with established outdoor space ideal for entertaining, gardening or simply enjoying the quiet surroundings. Whether as a permanent residence, coastal escape or lifestyle investment, this wonderful cottage presents a rare opportunity to acquire a home of genuine charm in one of North Norfolk's most desirable village settings.

Combining timeless appeal with a tranquil location, this delightful freehold cottage offers an enviable pace of life, moments from the coast yet immersed in the beauty of the Norfolk countryside. A property that feels immediately special from the moment you arrive.

Council Tax

Band C.

EPC Rating

E.

Services Connected

Mains water, electricity and drainage. Electric storage heaters.





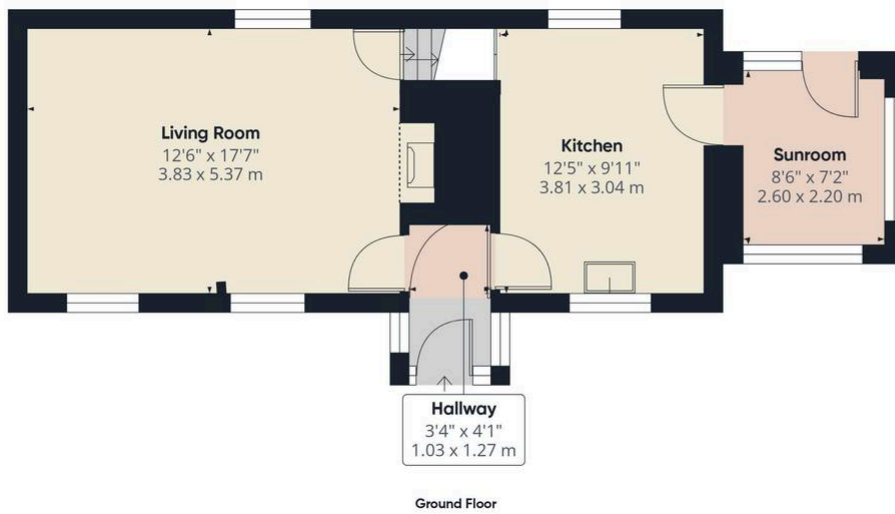

Approximate total area⁽¹⁾

829 ft²
77.1 m²

Reduced headroom

8 ft²
0.7 m²

(1) Excluding balconies and terraces

Reduced headroom
..... Below 5 ft/1.5 m

Calculations reference the RICS IPMS 3C standard. Measurements are approximate and not to scale. This floor plan is intended for illustration only.

GIRAFFE360

Come in & see us

If you'd like to know more about this home, get in touch or pop into our Cromer branch. Whether it's a quick question about the property or a chat about selling your own home, we're here to help with straightforward advice.



15 West Street, Cromer, Norfolk, NR27 9HZ

01263 511111 • hello@henleyshomes.co.uk • henleyshomes.co.uk

These particulars and measurements whilst believed to be accurate, are set out as a general outline only for guidance and do not constitute any part of an offer or contract. Intending purchasers should not rely on them as statements of representation of fact, but must satisfy themselves by inspection or otherwise as to their accuracy. No person in this firm's employment has the authority to make or give representation or warranty in respect of the property.

