



Cross Keys Estates

Opening doors to your future



Cross Keys Estates
Residential Sales & Lettings



Cross Keys Estates
Residential Sales & Lettings



Cross Keys Estates
Residential Sales & Lettings

Flat 4, 950 Wolseley Road
Plymouth, PL5 1LD
Guide Price £160,000 Leasehold - Share of Freehold



Flat 4, 950 Wolseley Road, Plymouth, PL5 1LD

Guide Price £160,000 Leasehold - Share of Freehold

** Guide Price £160,000 to £180,000 **

Cross Keys Estates is delighted to present this spacious ground floor apartment, ideally located in the picturesque Saltash Passage, Plymouth. This charming property offers a delightful blend of comfort and convenience, making it an excellent choice for those seeking a tranquil waterside lifestyle.

The apartment features two bright bedrooms, including a generous double, providing ample space for relaxation and rest. The large sitting room is a standout feature, offering stunning views of the River Tamar, perfect for enjoying the serene surroundings. The modern fitted kitchen is both functional and stylish, seamlessly leading into a lovely conservatory that invites natural light and offers a perfect spot for casual dining or enjoying a morning coffee.

- Spacious Ground Floor Apartment
- Highly Desirable Waterfront Area
- Two Great Size Bedrooms
- Benefitting From A Conservatory
- Parking Space, No Onward Chain
- Well Presented Throughout
- Lovely Enclosed Rear Garden
- Large Bright Sitting Room
- Modern Fitted Kitchen & Bathroom
- Ideal For FTB, EPC-D64



Cross Keys Estates

As one of Plymouth's leading QUALIFIED estate agents for over two decades, we are proud to have been offering our multi award winning customer service since day one. If you are currently on the market or you are thinking of putting your property on the market, why not give us a call, you will not be disappointed. 98% of our clients recommend us to their friends and family and our results, when it comes to sales, are unrivalled.

Plymouth

Plymouth, Britain's Ocean City, is one of Europe's most vibrant waterfront cities. Located in one of the most beautiful locations imaginable, Plymouth is sandwiched between the incredible South West coastline and the wild beauty of Dartmoor National Park. Plymouth is 37 miles south-west of Exeter and 190 miles west-south-west of London, between the mouths of the rivers Plym to the east and Tamar to the west where they join Plymouth Sound to form the boundary with Cornwall, it is also home to one of the most natural harbours in the world. To the North of Plymouth is Dartmoor National Park, extending to over 300 square miles, which provides excellent recreational facilities.

The city is home to more than 260,000 people, making it the 30th most populated city in the United Kingdom and the second-largest city in the South West, after Bristol and has a full range of shopping, educational and sporting facilities. There is mainline train service to London (Paddington) and to Penzance in West Cornwall.

There's everything that you would expect to find in a cool, cultural city, with great shopping, arts and entertainment. But there's also hundreds of years of history to uncover, from Sir Francis Drake and the Spanish Armada to the Mayflower sailing in 1620, to a city rebuilt following the Blitz during World War II. With easy access to Exeter and its International Airport and a mainline train station giving direct access to London and a ferry port offering sea crossings to both France and Spain.

Plymouth is governed locally by Plymouth City Council and is represented nationally by three MPs. Plymouth's economy remains strongly influenced by shipbuilding and seafaring including ferry links to Brittany and Spain, but has tended toward a university economy since the early 2000's. It has the largest operational naval base in Western Europe – HMNB Devonport.

Saltash Passage

More Property Information

The property also boasts an enclosed, well-established private rear garden, ideal for outdoor entertaining or simply unwinding in a peaceful setting. The modern bathroom adds to the appeal, ensuring that all your needs are met in this lovely home.

Situated by the waterside and the iconic Tamar Bridge, this apartment is not only a beautiful residence but also benefits from the charm of the local area. Saltash Passage features a quaint village atmosphere, complete with a local pub and a selection of nearby properties that enhance the community feel.

With no onward chain, this property presents a fantastic opportunity for buyers looking to move in without delay. Whether you are a first-time buyer, a small family, or seeking a peaceful retreat, this apartment is sure to impress. Do not miss the chance to make this delightful home your own.

Sitting Room

11'1" x 15'6" (3.40m x 4.73m)

Kitchen

11'10" x 7'2" (3.63m x 2.19m)

Conservatory

9'9" x 8'1" (2.98m x 2.47m)

Primary Bedroom

11'8" x 10'10" (3.58m x 3.32m)

Bathroom

9'7" x 6'8" (2.94m x 2.04m)

Bedroom 2

7'7" x 7'7" (2.33m x 2.32m)

Garden & River Tamar Views

Cross Keys Estates Lettings Department

Cross Keys Estates also offer a professional, ARLA accredited Lettings and Management Service. If you are considering renting your property in order to purchase, are looking at buy to let or would like a free review of your current portfolio then please call our director Jack who is a fully qualified and award-winning letting agent on 01752 500018

Financial Services

Cross Keys Estates are proud to work in partnership with The Mortgage Lab, our whole of market mortgage specialists. With over 18 years industry experience, they are able to source the very best deal to meet their customers circumstances. Offering professional and friendly advice on residential and investment mortgages. Please get in touch to arrange a free, no obligation appointment to see how they can help you. Tel. 01752 255905, Email.sarah@themortgagelab.co.uk



Cross Keys Estate
Residential Sales & Lettings



Cross Keys Estate
Residential Sales & Lettings



Cross Keys Estate
Residential Sales & Lettings



Cross Keys Estate
Residential Sales & Lettings

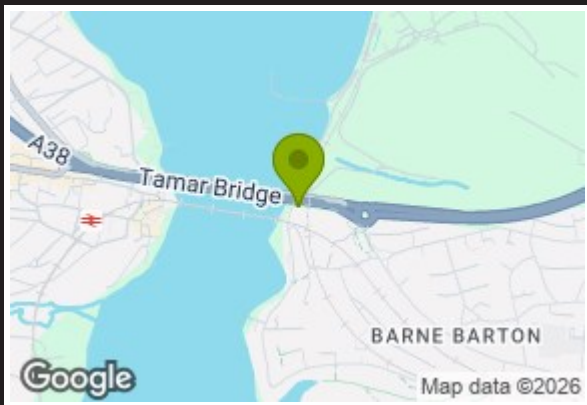
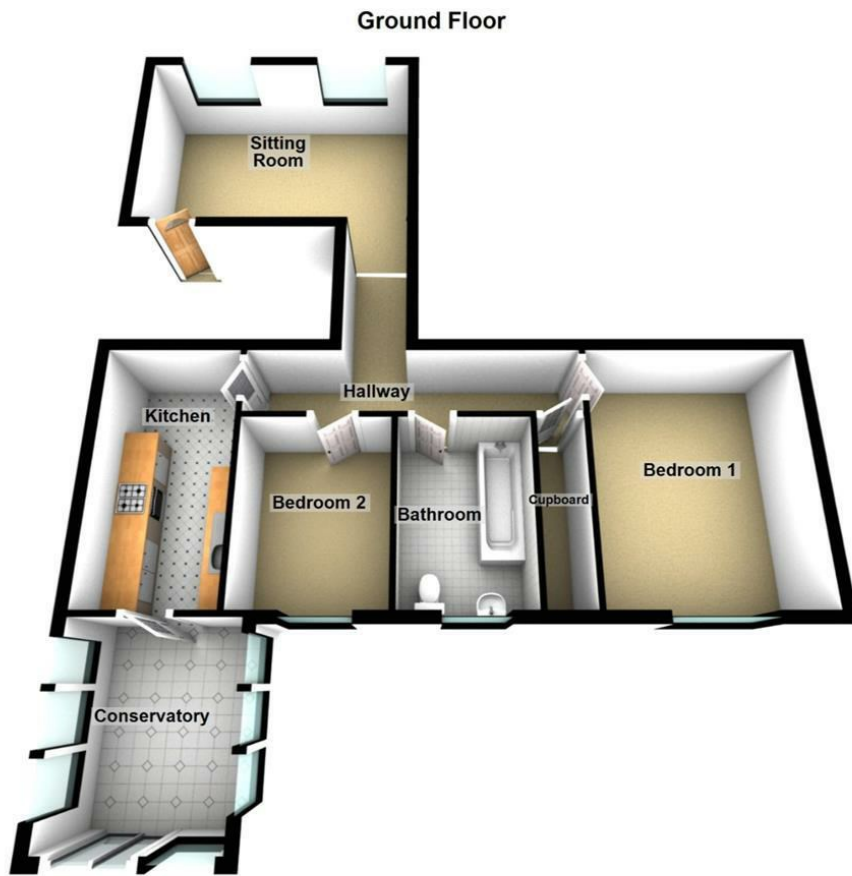

Energy Efficiency Rating		Current	Potential
Very energy efficient - lower running costs			
(92 plus) A			
(81-91) B			
(69-80) C			
(55-68) D			
(39-54) E		59	
(21-38) F			
(1-20) G			
Not energy efficient - higher running costs			
England & Wales		EU Directive 2002/91/EC	

Environmental Impact (CO ₂) Rating		Current	Potential
Very environmentally friendly - lower CO ₂ emissions			
(92 plus) A			
(81-91) B			
(69-80) C			
(55-68) D			
(39-54) E			
(21-38) F			
(1-20) G			
Not environmentally friendly - higher CO ₂ emissions			
England & Wales		EU Directive 2002/91/EC	

VIEWINGS AND NEGOTIATIONS Strictly through the vendors agents, Cross Keys Estates MONEY LAUNDERING REGULATION 2003 AND PROCEEDS OF CRIME ACT 2002 Cross Keys Estates are fully committed to complying with The Money Laundering Regulations that have been introduced by the government. These regulations apply to everyone buying or selling a property, including companies, businesses and individuals within the United Kingdom or abroad. Should you either purchase or sell a property through this estate agents we will ask for information from you regarding your identity and proof of residence. We would ask for you to co-operate fully to ensure there is no delay in the sales/purchase process. IMPORTANT: we would like to inform prospective purchasers that these sales particulars have been prepared as a general guide only. A detailed survey has not been carried out, nor the services, appliances and fittings tested. Room sizes should not be relied upon for furnishing purposes and are approximate. If floor plans are included, they are for guidance only and illustration purposes only and may not be to scale. If there are any important matters likely to affect your decision to buy, please contact us before viewing the property.



Council Tax Band A



Cross Keys Estates
Opening doors to your future

Sales, Cross Keys House 51-53 Devonport Road,,
Stoke, Plymouth, Devon, PL3 4DL
Tel: 01752 500018 | sales@crosskeysestates.net
www.crosskeysestates.net